

"Why compete against your supplier when you can be our partner"

The Finer Jaw Coupling is recognised across a large range of industries. The Jaw Coupling is highly resilient, it does not require any lubrication and can work in environments contaminated with oil, dirt, sand, moisture and grease.

The rubber insert is designed to absorb shock loading and does not allow for any metal on metal contact. Finer Power Transmissions stocks both the Spider Elements (rubber & polyurethane) as well as the Wrap Element Kits.

Finer Power Transmissions stocks a range of jaw couplings in a variety of pre-bored and keyed sizes.



	FW050	FW070	FW075	FSW095	FSW100	FSW110	FSW150	FSW190	FSW225
Element	✓	✓	✓	✓	✓	✓	✓	✓	✓
Wrap				✓	✓	✓	✓	✓	✓
Kit				✓	✓	✓	✓	✓	
Pilot Bore	✓	✓	✓	✓	✓	✓	✓	✓	✓
Imperial (inch)									
3/8	✓	✓							
1/2	✓	✓	✓	✓					
5/8	✓	✓	✓	✓	✓				
3/4		✓	✓	✓	✓				
7/8			✓	✓	✓	✓			
1				✓	✓	✓	✓		
1-1/8				✓	✓	✓	✓		
1-1/4					✓	✓	✓	✓	
1-3/8						✓	✓	✓	
1-1/2						✓	✓	✓	
1-5/8								✓	
2								✓	
Metric (mm)									
9	✓								
10	✓	✓							
11	✓	✓							
12	✓	✓	✓						
14	✓	✓	✓	✓					
16		✓	✓	✓					
18		✓	✓	✓	✓				
19		✓	✓	✓	✓				
20			✓	✓	✓	✓			
22			✓	✓	✓	✓			
24				✓	✓	✓	✓		
25				✓	✓	✓	✓		
28				✓	✓	✓	✓	✓	
30					✓	✓	✓	✓	
32					✓	✓	✓	✓	
35					✓	✓	✓	✓	
38					✓	✓	✓	✓	
40						✓	✓	✓	
42						✓	✓	✓	
45							✓	✓	
48							✓	✓	
50								✓	
55								✓	
60								✓	

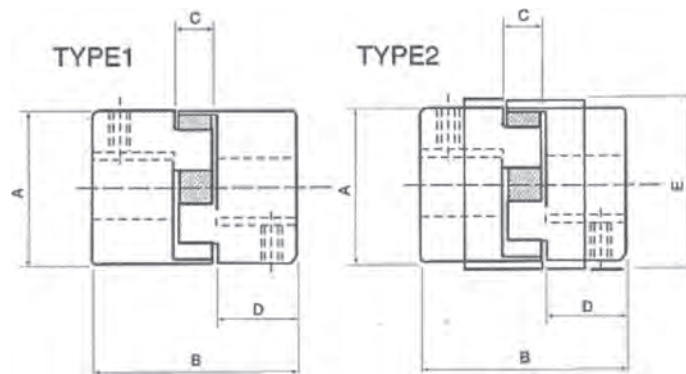

Coupling	Type	A	B	C	D	Stock Bore	Weight (Kg)		Max Bore.
							Min. Bore	Max. Bore	
FW050PB	1	27.4	43.4	12.2	15.7	6			15
FW070PB	1	35	53	13	19	6	0.26	0.24	19
FW075PB	1	44.5	53	13	21	6	0.45	0.39	22
FSW095PB	1	54	65	13	25	11	0.79	0.69	29
FSW100PB	1	65	86	19	35	11	1.55	1.32	35
FSW110PB	1	84	110	24	43	16	2.93	2.55	42
FSW150PB	1	96	113	25	45	16	4.06	3.51	48
FSW190PB	1	115	133	25	50	18			55
FSW225PB	1	127	155	25	55	18			65

Power Ratings (KW)

Coupling	Max. RPM	Torque (Nm).	Speed RPM					
			100	720	960	1440	2880	3600
FW050PB	18000	3.51	0.037	0.26	0.35	0.53	1.73	2.17
FW070PB	14000	5.77	0.06	0.43	0.58	0.87	3.61	4.51
FW075PB	11000	11.9	0.12	0.9	1.2	1.8	5.78	7.22
FSW095PB	9000	25.8	0.27	1.95	2.59	3.89	16.73	20.91
FSW100PB	7000	55.4	0.58	4.18	5.58	8.36	31.77	39.71
FSW110PB	5000	105	1.10	7.94	10.59	15.88	44.93	56.16
FSW150PB	4000	150	1.56	11.23	14.98	22.46	60.28	75.35
FSW190PB	3600	200	2.09	15.07	20.09	30.14	84.4	105.5
FSW225PB	3600	280	2.93	21.09	28.13	42.2	84.4	105.5

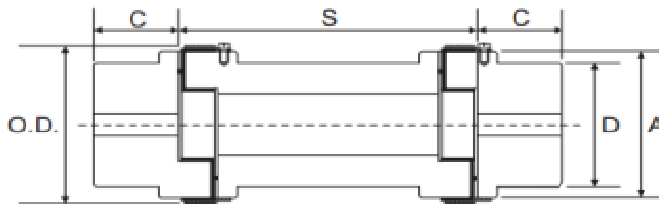

Part No.	Bore		A	C	D	OD	Spacer Length (mm)
	Min	Max					
FSW100-100MM/140MM	10	35	65	35	57	78	100/140
FSW110-100MM/140MM	15	42	85	43	76	96	100/140
FSW150-100MM/140MM/180MM	15	48	96	45	80	111	100/140/180
FSW190-100MM/140MM/180MM	20	60	115	54	102	130	100/140/180
FSW225-140MM/180MM	20	65	127	64	111	142	140/180