



PRODUCT INFORMATION

July 2013



ST200DC

PIUSI 24 Volt Portable Dispenser Unit

The new Italian made Piusi ST200DC 24V diesel transfer pump has been designed to deliver diesel at high flow rates. With its 4 pumps working in line and combined with the 1 1/2" BSP (f) inlet and outlet, the ST200DC delivers diesel at up to 185 litres per minute. For high flow diesel transfer applications where an air operated diaphragm pump may have been used but only 12v power is available, the ST200DC can fill dump trucks, excavators and other construction, mining and transport vehicles or machines quickly and easily. Its portability and flexibility means it can run from the back of a ute etc and can even be carried at just 18kg's.

The pump only kit can be combined with a meter and high flow auto shutoff nozzle such as the 52039 as required and comes standard with 6 metres of electric cable, clamps and an on/off switch.

PRODUCT SPECIFICATIONS, FEATURES AND BENEFITS

Flow rates of up to 185 L/min

Ideal for transferring diesel at high flow rates

Maximum working pressure of 30psi (2 bar)

1 1/2" BSP (f) inlet/outlet

Delivery cycle 25 minutes on / 12 minutes off

On/off switch

24 Volt DC

Power Watt 1200w

Amp. Max. 50amp

Supplied with 6m electric cables with clamps

Dimensions of 413mm (W) x 230mm (D) x 340mm (H)

Weight 18kg

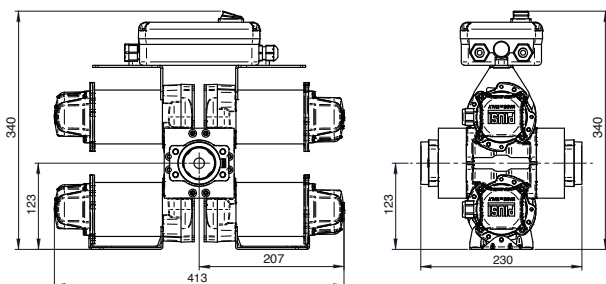
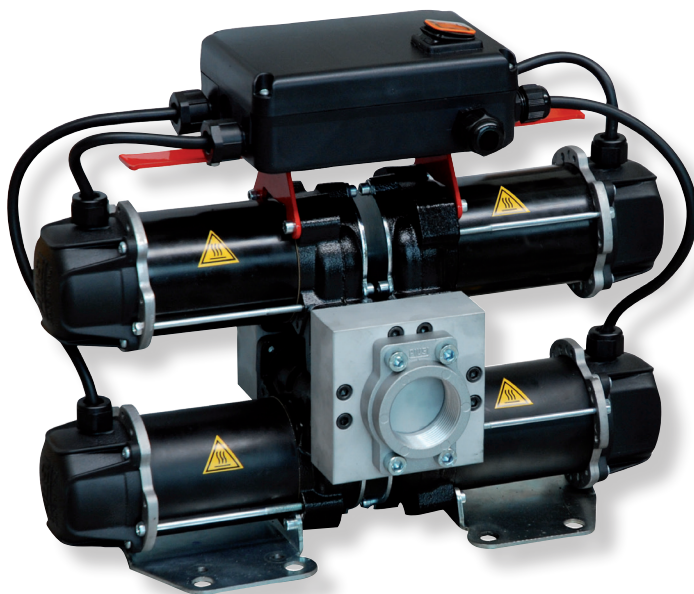

ORDERING INFORMATION

ST200DC

24 Volt Portable Dispenser Unit

Also available

ST200 240V

52039 Auto shut off nozzle

1 1/2" meters available

