

Shouldered Concentric Reducers

minsip

Size NB	Size (inch)	Part No.	L (mm)	WP		Price \$
				PSI	MPa	
80 x 50	3 x 2	08/048/14/001T	203	750	5.1	113.37
100 x 50	4 x 2	08/048/14/002T	229	750	5.1	137.24
150 x 50	6 x 2	08/048/14/004T	305	580	4.0	420.01
100 x 80	4 x 3	08/048/14/011T	229	750	5.1	145.01
150 x 80	6 x 3	08/048/14/013T	305	580	4.0	328.18
150 x 100	6 x 4	08/048/14/016T	305	580	4.0	270.99

Price Group: SD
AE02

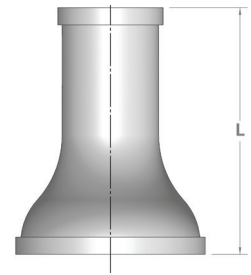

Shouldered Y-Pieces

Size NB	Size (inch)	Part No.	L (mm)	L2 (mm)	WP		Price \$
					PSI	MPa	
50	2	08/048/32/000T	165	89	750	5.1	149.17
80	3	08/048/32/002T	229	127	750	5.1	344.42
100	4	08/048/32/003T	279	127	750	5.1	399.78
150	6	08/048/32/005T	330	152	580	4.0	645.51

Price Group: SD
AE02

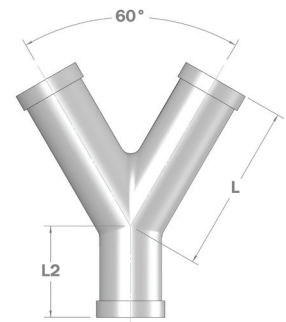

Shouldered Reducing Tees

Size NB	Size (inch)	Part No.	L (mm)	L2 (mm)	WP		Price \$
					PSI	MPa	
50 x 80	3 X 2	08/048/08/001	406	203	750	5.1	198.10
100 x 50	4 X 2	08/048/08/003	458	229	750	5.1	344.89
150 x 50	6 X 2	08/048/08/010	508	254	580	4.0	602.57

Price Group: SD
AE02

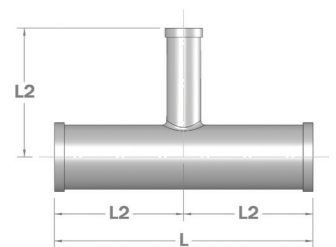

Reducing Tee Shouldered x BSP Male

Size NB	Size (inch)	Thread BSP	Part No.	L (mm)	L2 (mm)	WP		Price \$
						PSI	MPa	
50 x 25	2 x 1	1"	08/048/07/000	304	152	750	5.1	568.05
100 x 50	4 x 2	2"	08/048/07/008	458	229	750	5.1	568.05

Price Group: SD
AE02

