

Sprockets

Contents



"Why compete against your supplier
when you can be our partner"

SPROCKETS

Chain Tensioners (Idler Sprockets).... 15

see Chains section for details

ASA Plate Wheels 104

40-1 Plate Wheel 104

60-1 Plate Wheel 104

ASA Sprockets 105

25-1 Sprocket..... 105

35-1 Sprocket..... 106

40-1 Sprocket..... 107

60-1 Sprocket..... 108

80-1 Sprocket..... 108

BS Sprockets..... 109

05B Sprocket 109

06B-1-2 Sprocket 110

08B-1-2-3 Sprocket..... 111

10B-1-2-3 Sprocket..... 112

12B-1-2-3 Sprocket..... 113

16B-1-2-3 Sprocket..... 114

20B-1-2 Sprocket 115

24B-1-2 Sprocket 115

BS Taper Locks 116

06B-1-2 Taper Lock 116

08B-1-2 Taper Lock 116

10B-1-2 Taper Lock 117

12B-1-2-3 Taper Lock 118

16B-1-2-3 Taper Lock 119

BS Plate Wheels 120

06A-1 Plate Wheel 120

08A-1 Plate Wheel 121

10A-1 Plate Wheel 122

12A-1 Plate Wheel 123

16A-1 Plate Wheel 124

Weld Fit Welded Hubs & Sprockets . 125

Welded Hubs 125

ANSI Plate Wheel Sprocket..... 126

BS Plate Wheel Sprocket 126

ASA Plate Wheels

40-1 Plate Wheel

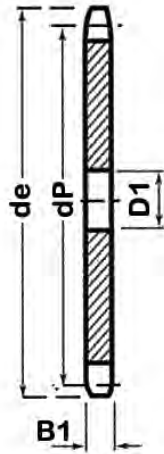
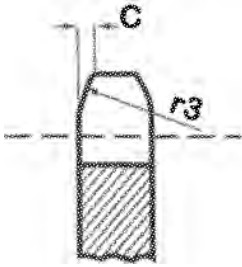

| | |
|-----------------|------|
| Pinions | mm |
| Tooth Radius r3 | |
| Radius Width C | |
| Tooth Width B1 | 7.2 |
| | |
| Chain | mm |
| Pitch | 12.7 |
| Inside | 7.92 |
| Roller ø | 7.92 |

| Teeth | de | dp | D1 | App. Kg |
|-------|-------|--------|----|---------|
| 42 | 176.6 | 169.95 | 16 | 1.13 |
| 48 | 200.8 | 194.18 | 20 | 1.46 |
| 50 | 208.9 | 202.26 | 20 | 1.70 |
| 55 | 229.1 | 222.46 | 20 | 2.08 |
| 60 | 249.3 | 242.66 | 20 | 2.13 |
| 65 | 269.5 | 262.86 | 20 | 2.25 |
| 70 | 289.7 | 283.07 | 25 | 3.28 |
| 72 | 297.8 | 291.16 | 25 | 3.51 |
| 76 | 313.9 | 307.33 | 25 | 3.70 |

60-1 Plate Wheel

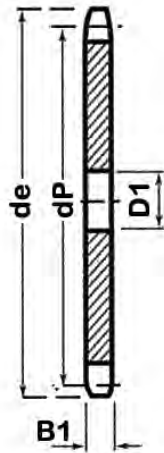
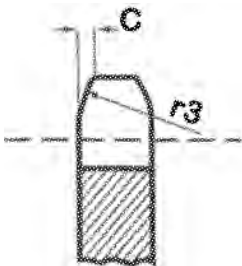

| | |
|-----------------|-------|
| Pinions | mm |
| Tooth Radius r3 | |
| Radius Width C | |
| Tooth Width B1 | 11.7 |
| | |
| Chain | mm |
| Pitch | 19.05 |
| Inside | 12.7 |
| Roller ø | 11.91 |

| Teeth | de | dp | D1 | App. Kg |
|-------|-------|--------|----|---------|
| 42 | 265.2 | 254.93 | 25 | 4.53 |
| 48 | 301.5 | 291.27 | 25 | 5.75 |
| 50 | 313.6 | 303.39 | 25 | 6.45 |
| 55 | 343.9 | 333.70 | 25 | 7.82 |
| 60 | 374.2 | 363.99 | 25 | 9.19 |
| 65 | 404.5 | 394.29 | 30 | 10.65 |
| 70 | 434.9 | 424.60 | 30 | 12.45 |
| 72 | 447.0 | 436.74 | 30 | 13.22 |
| 76 | 471.2 | 460.99 | 30 | 14.78 |

80-1 Plate Wheel

| Teeth | de | dp | D1 | App. Kg |
|-------|-----|----|----|---------|
| 17 | 150 | | 20 | |

ASA Sprockets



"Why compete against your supplier when you can be our partner"

Finer Power Transmissions stocks a range of ASA high quality steel sprockets. Complete with induction hardened teeth, thus improving the sprockets resistance to wear and increasing the sprockets working life.

All Finer sprockets are engineered in accordance with the stringent ISO 9000 standards.

| 25-1 Sprocket | | Teeth | de | dp | Simplex | | |
|---------------|--|-------|-------|--------|---------|----|----|
| | | | | | dm | D1 | A |
| | | 9 | 18.1 | 16.59 | 10 | 5 | 15 |
| | | 10 | 22.3 | 20.55 | 11 | 5 | 15 |
| | | 11 | 24.3 | 22.54 | 14 | 6 | 15 |
| | | 12 | 26.4 | 24.33 | 16 | 6 | 15 |
| | | 13 | 28.5 | 26.53 | 18 | 6 | 15 |
| | | 14 | 30.5 | 28.53 | 20 | 6 | 15 |
| | | 15 | 32.5 | 30.55 | 22 | 6 | 15 |
| | | 16 | 34.5 | 32.55 | 24 | 8 | 15 |
| | | 17 | 36.5 | 34.55 | 26 | 8 | 15 |
| | | 18 | 38.5 | 36.56 | 28 | 8 | 15 |
| | | 19 | 40.5 | 38.58 | 30 | 8 | 15 |
| | | 20 | 42.5 | 40.58 | 32 | 8 | 15 |
| | | 21 | 44.6 | 42.60 | 34 | 8 | 15 |
| | | 22 | 46.6 | 44.62 | 36 | 8 | 15 |
| | | 23 | 48.6 | 46.63 | 38 | 8 | 15 |
| | | 24 | 50.6 | 48.64 | 40 | 8 | 15 |
| | | 25 | 52.6 | 50.66 | 42 | 8 | 18 |
| | | 26 | 54.6 | 52.67 | 44 | 10 | 18 |
| | | 27 | 54.6 | 54.69 | 46 | 10 | 18 |
| | | 28 | 58.7 | 56.71 | 48 | 10 | 18 |
| | | 29 | 60.7 | 58.73 | 48 | 10 | 18 |
| | | 30 | 62.7 | 60.75 | 48 | 12 | 18 |
| | | 35 | 72.8 | 70.84 | 50 | 12 | 18 |
| | | 38 | 78.8 | 76.89 | 50 | 12 | 18 |
| | | 45 | 93.0 | 91.03 | 0A | 0A | 0A |
| | | 50 | 104 | | 50 | 12 | 20 |
| | | 57 | 117.2 | 115.27 | 0A | 0A | 0A |
| | | 76 | 155.6 | 153.66 | 0A | 0A | 0A |

| | |
|-----------------|-----------|
| | |
| Pinions | mm |
| Tooth Radius r3 | |
| Radius Width C | |
| Tooth Width B1 | 2.9 |
| | |
| Chain | mm |
| Pitch | 6.35 |
| Inside | 3.18 |
| Roller ø | 3.3 |

ASA Sprockets

35-1 Sprocket

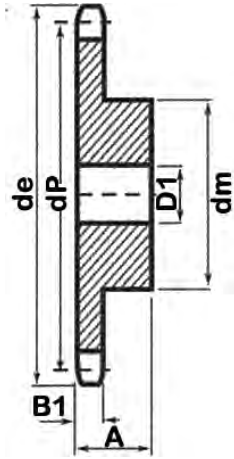
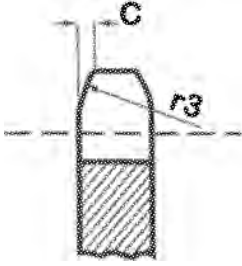

| Pinions | mm |
|-----------------|-------|
| Tooth Radius r3 | |
| Radius Width C | |
| Tooth Width B1 | 4.3 |
| | |
| Chain | mm |
| Pitch | 9.525 |
| Inside | 4.77 |
| Roller ø | 5.08 |

| Teeth | de | dp | Simplex | | | |
|-------|-------|--------|---------|----|----|---------|
| | | | dm | D1 | A | App. Kg |
| 9 | 28.6 | 24.89 | 15 | 8 | 20 | 0.04 |
| 10 | 31.5 | 27.85 | 18 | 8 | 20 | 0.06 |
| 11 | 34.5 | 20.82 | 20 | 8 | 20 | 0.09 |
| 12 | 40.5 | 36.8 | 25 | 8 | 25 | 0.10 |
| 13 | 43.5 | 39.80 | 28 | 8 | 25 | 0.11 |
| 14 | 46.5 | 42.80 | 31 | 8 | 25 | 0.12 |
| 15 | 49.5 | 45.81 | 34 | 8 | 25 | 0.14 |
| 16 | 52.5 | 48.82 | 37 | 10 | 28 | 0.18 |
| 17 | 55.5 | 51.83 | 40 | 10 | 28 | 0.20 |
| 18 | 58.6 | 54.85 | 43 | 10 | 28 | 0.23 |
| 19 | 61.6 | 57.87 | 45 | 10 | 28 | 0.25 |
| 20 | 64.6 | 60.89 | 46 | 10 | 28 | 0.31 |
| 21 | 67.6 | 63.91 | 48 | 12 | 28 | 0.36 |
| 22 | 70.6 | 66.93 | 50 | 12 | 28 | 0.37 |
| 23 | 73.7 | 69.95 | 52 | 12 | 28 | 0.39 |
| 24 | 76.7 | 72.97 | 54 | 12 | 28 | 0.40 |
| 25 | 79.7 | 76.00 | 57 | 12 | 28 | 0.41 |
| 26 | 82.7 | 79.02 | 60 | 12 | 28 | 0.42 |
| 27 | 85.7 | 82.04 | 60 | 12 | 28 | 0.44 |
| 28 | 88.8 | 85.07 | 60 | 12 | 28 | 0.45 |
| 29 | 91.8 | 88.09 | 60 | 12 | 28 | 0.47 |
| 30 | 94.8 | 91.12 | 60 | 12 | 28 | 0.48 |
| 38 | 119.0 | 115.34 | 70 | 16 | 30 | 0.77 |
| 40 | 125.1 | 121.40 | 70 | 16 | 30 | 0.81 |
| 57 | 177.5 | 172.91 | 0A | 0A | 0A | 1.27 |
| 60 | 186.6 | 181.99 | 0A | 0A | 0A | 1.34 |

ASA Sprockets

“Why compete against your supplier when you can be our partner”

| 40-1 Sprocket | | Teeth | de | dp | Simplex | | |
|---------------|--|-------|--------|----|---------|----|------|
| | | | | | dm | D1 | A |
| 9 | | 43.2 | 37.13 | 24 | 10 | 25 | 0.14 |
| 10 | | 47.2 | 41.10 | 26 | 10 | 25 | 0.15 |
| 11 | | 51.2 | 45.07 | 29 | 10 | 25 | 0.17 |
| 12 | | 55.2 | 49.07 | 33 | 10 | 28 | 0.24 |
| 13 | | 59.2 | 53.06 | 37 | 10 | 28 | 0.25 |
| 14 | | 63.2 | 57.07 | 41 | 10 | 28 | 0.31 |
| 15 | | 67.2 | 61.09 | 45 | 10 | 28 | 0.33 |
| 16 | | 71.2 | 65.10 | 50 | 12 | 28 | 0.37 |
| 17 | | 75.2 | 69.11 | 52 | 12 | 28 | 0.51 |
| 18 | | 79.2 | 73.14 | 56 | 12 | 28 | 0.54 |
| 19 | | 83.3 | 77.16 | 60 | 12 | 28 | 0.65 |
| 20 | | 87.3 | 81.19 | 64 | 12 | 28 | 0.76 |
| 21 | | 91.3 | 85.22 | 68 | 14 | 28 | 0.82 |
| 22 | | 95.4 | 89.24 | 70 | 14 | 28 | 0.88 |
| 23 | | 99.4 | 93.27 | 70 | 14 | 28 | 1.05 |
| 24 | | 103.4 | 97.29 | 70 | 14 | 28 | 1.07 |
| 25 | | 107.4 | 101.33 | 70 | 14 | 28 | 1.13 |
| 26 | | 111.5 | 105.36 | 70 | 16 | 30 | 1.15 |
| 27 | | 115.5 | 109.40 | 70 | 16 | 30 | 1.19 |
| 28 | | 119.5 | 113.42 | 70 | 16 | 30 | 1.30 |
| 29 | | 123.6 | 117.46 | 80 | 16 | 30 | 1.33 |
| 30 | | 127.6 | 121.50 | 80 | 16 | 30 | 1.36 |
| 32 | | 135.7 | 129.56 | 90 | 16 | 30 | 1.46 |
| 35 | | 147.8 | 141.68 | 90 | 16 | 30 | 1.61 |
| 38 | | 159.9 | 153.80 | 90 | 16 | 35 | 1.78 |
| 40 | | 168.0 | 161.87 | 90 | 16 | 35 | 1.88 |
| 42 | | 176.6 | 169.95 | 0A | 0A | 0A | 1.97 |
| 50 | | 208.9 | 202.26 | 0A | 0A | 0A | 3.00 |
| 55 | | 229.1 | 222.46 | 0A | 0A | 0A | 3.14 |
| 57 | | 237.2 | 230.54 | 0A | 0A | 0A | 3.28 |
| 60 | | 249.3 | 242.66 | 0A | 0A | 0A | 3.45 |

| Pinions | | mm |
|-----------------|--|-----|
| Tooth Radius r3 | | |
| Radius Width C | | |
| Tooth Width B1 | | 7.2 |

| Chain | | mm |
|----------|--|------|
| Pitch | | 12.7 |
| Inside | | 7.94 |
| Roller ø | | 7.94 |

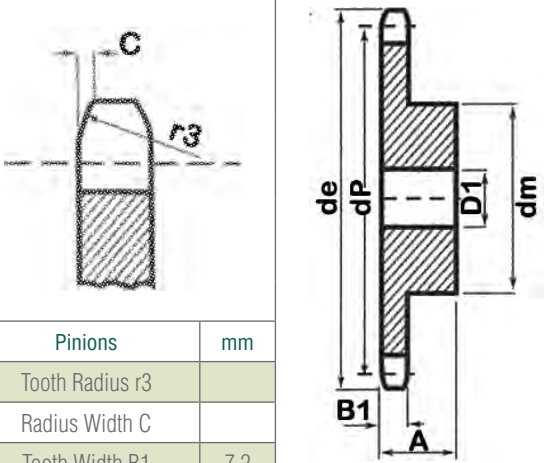

ASA Sprockets

60-1 Sprocket

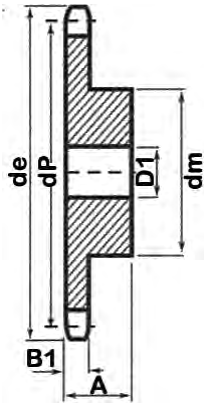
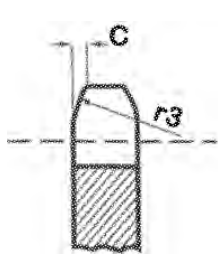

| Pinions | | mm |
|-----------------|--|-------|
| Tooth Radius r3 | | |
| Radius Width C | | |
| Tooth Width B1 | | 11.6 |
| Chain | | mm |
| Pitch | | 19.05 |
| Inside | | 12.7 |
| Roller ø | | 11.91 |

| Teeth | de | dp | Simplex | | | |
|-------|-------|--------|---------|----|----|---------|
| | | | dm | D1 | A | App. Kg |
| 9 | 64.0 | 55.70 | 37 | 12 | 30 | 0.35 |
| 10 | 70.0 | 61.64 | 42 | 12 | 30 | 0.41 |
| 11 | 76.0 | 67.61 | 46 | 16 | 35 | 0.53 |
| 12 | 81.9 | 73.6 | 52 | 16 | 35 | 0.67 |
| 13 | 87.9 | 79.59 | 58 | 16 | 35 | 0.75 |
| 14 | 94.0 | 85.61 | 64 | 16 | 35 | 0.91 |
| 15 | 100.0 | 91.63 | 70 | 16 | 35 | 1.14 |
| 16 | 106.0 | 97.65 | 75 | 16 | 35 | 1.27 |
| 17 | 112.0 | 103.67 | 80 | 16 | 35 | 1.46 |
| 18 | 118.0 | 109.71 | 80 | 16 | 35 | 1.69 |
| 19 | 124.1 | 115.75 | 80 | 16 | 35 | 1.78 |
| 20 | 130.1 | 121.78 | 80 | 16 | 35 | 2.10 |
| 21 | 136.2 | 127.82 | 90 | 20 | 40 | 2.27 |
| 22 | 142.2 | 133.86 | 90 | 20 | 40 | 2.38 |
| 23 | 148.2 | 139.90 | 90 | 20 | 40 | 2.49 |
| 24 | 154.3 | 145.94 | 90 | 20 | 40 | 2.62 |
| 25 | 160.3 | 152.00 | 90 | 20 | 40 | 2.78 |
| 26 | 166.4 | 158.04 | 95 | 20 | 40 | 2.89 |
| 27 | 172.4 | 164.09 | 95 | 20 | 40 | 3.05 |
| 28 | 178.5 | 170.13 | 95 | 20 | 40 | 3.12 |
| 29 | 184.5 | 176.19 | 95 | 20 | 40 | 3.30 |
| 30 | 190.6 | 182.25 | 95 | 20 | 40 | 3.44 |
| 32 | 202.7 | 194.35 | 95 | 20 | 40 | 3.75 |
| 34 | 214.8 | 206.46 | 95 | 0A | 40 | 3.99 |
| 38 | 239.0 | 230.69 | 100 | 25 | 40 | 4.92 |
| 40 | 251.1 | 242.81 | 100 | 25 | 0A | 5.22 |

80-1 Sprocket

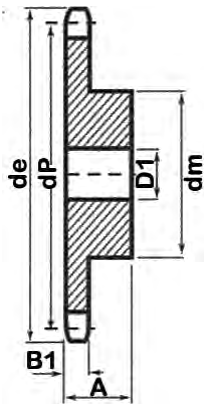
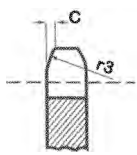

| Pinions | | mm |
|-----------------|--|-------|
| Tooth Radius r3 | | |
| Radius Width C | | |
| Tooth Width B1 | | 14.6 |
| Tooth Width b1 | | |
| Tooth Width B2 | | |
| Tooth Width B3 | | |
| Chain | | mm |
| Pitch | | 25.4 |
| Inside | | 15.88 |
| Roller ø | | 15.88 |

| Teeth | de | dp | Simplex | | | |
|-------|-------|--------|---------|----|----|---------|
| | | | dm | D1 | A | App. Kg |
| 9 | 85.8 | 72.47 | 50 | 16 | 35 | 0A |
| 10 | 93.8 | 72.19 | 55 | 16 | 35 | 0A |
| 11 | 101.7 | 90.14 | 61 | 16 | 40 | 1.45 |
| 12 | 109.7 | 98.14 | 69 | 16 | 40 | 1.82 |
| 13 | 117.7 | 106.12 | 78 | 16 | 40 | 1.92 |
| 14 | 125.7 | 114.15 | 84 | 16 | 40 | 2.09 |
| 15 | 133.7 | 122.17 | 92 | 16 | 40 | 2.59 |
| 16 | 141.8 | 130.20 | 100 | 20 | 45 | 3.00 |
| 17 | 149.8 | 138.22 | 100 | 20 | 45 | 3.18 |
| 18 | 157.8 | 146.28 | 100 | 20 | 45 | 3.77 |
| 19 | 165.9 | 154.33 | 100 | 20 | 45 | 3.86 |
| 20 | 173.9 | 162.38 | 100 | 20 | 45 | 4.09 |
| 21 | 182.0 | 170.43 | 110 | 20 | 50 | 4.54 |
| 22 | 190.1 | 178.48 | 110 | 20 | 50 | 4.99 |
| 23 | 198.1 | 186.53 | 110 | 20 | 50 | 5.08 |
| 24 | 208 | 0A | 108 | 25 | 45 | 0A |
| 25 | 215 | 0A | 110 | 20 | 50 | 0A |
| 26 | 224 | 0A | 108 | 25 | 45 | 0A |
| 27 | 230 | 0A | 120 | 20 | 50 | 0A |
| 28 | 237 | 0A | 120 | 20 | 50 | 0A |
| 29 | 245 | 0A | 108 | 25 | 45 | 0A |
| 30 | 255 | 0A | 108 | 25 | 45 | 0A |
| 38 | 319.2 | 307.59 | 120 | 25 | 50 | 11.12 |

British Standard Sprockets



"Why compete against your supplier when you can be our partner"

Finer Power Transmissions stocks a range of British high quality steel sprockets. Complete with induction hardened teeth, thus improving the sprockets resistance to wear and increasing the sprockets working life.

All Finer sprockets are engineered in accordance with the stringent ISO 9000 standards.

| 05B Sprocket | | Teeth | de | dp | Simplex | | |
|--------------|--|-------|-------|-------|---------|----|----|
| | | | | | dm | D1 | A |
| | | 9 | 25.09 | 23.99 | 15 | 6 | 12 |
| | | 10 | 28.4 | 25.89 | 17 | 6 | 12 |
| | | 11 | 31 | 28.39 | 18 | 7 | 13 |
| | | 12 | 33.7 | 30.91 | 20 | 7 | 13 |
| | | 13 | 36.7 | 33.42 | 23 | 7 | 13 |
| | | 14 | 39.2 | 35.95 | 25 | 7 | 13 |
| | | 15 | 41.7 | 48.48 | 28 | 7 | 13 |
| | | 16 | 44.2 | 41.01 | 30 | 8 | 14 |
| | | 17 | 46.7 | 43.53 | 30 | 8 | 14 |
| | | 18 | 49.2 | 46.07 | 30 | 8 | 14 |
| | | 19 | 51.7 | 48.61 | 30 | 8 | 14 |
| | | 20 | 54.2 | 51.14 | 30 | 8 | 14 |
| | | 21 | 57.2 | 53.67 | 35 | 8 | 14 |
| | | 22 | 59.2 | 56.21 | 35 | 8 | 14 |
| | | 23 | 62.2 | 58.75 | 35 | 8 | 14 |
| | | 24 | 64.7 | 61.29 | 35 | 8 | 14 |
| | | 25 | 67.2 | 63.83 | 35 | 8 | 14 |
| | | 26 | 69.7 | 66.37 | 40 | 10 | 16 |
| | | 27 | 72.3 | 68.91 | 40 | 10 | 16 |
| | | 28 | 74.7 | 71.45 | 40 | 10 | 16 |
| | | 30 | 80.2 | 76.53 | 40 | 10 | 16 |
| | | 38 | 100.2 | 96.88 | 40 | 12 | 16 |
| | | 57 | 149.3 | 145.2 | 80 | 14 | 20 |

| Pinions | | mm |
|-----------------|-----|----|
| Tooth Radius r3 | | |
| Radius Width C | | |
| Tooth Width B1 | 2.8 | |
| Tooth Width b1 | | |

| Chain | | mm |
|----------|---|----|
| Pitch | 8 | |
| Inside | 3 | |
| Roller ø | 5 | |

British Standard Sprockets

06B-1-2 Sprocket

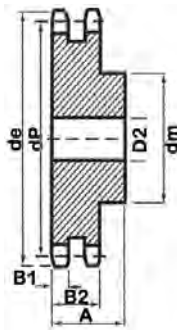
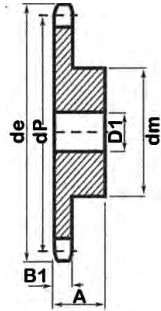
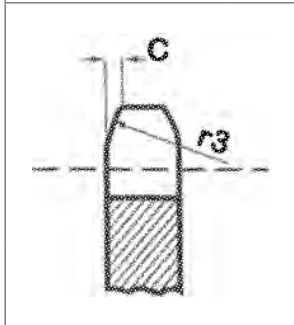

| Pinions | | mm |
|-----------------|--|------|
| Tooth Radius r3 | | |
| Radius Width C | | |
| Tooth Width B1 | | 5.3 |
| Tooth Width b1 | | |
| Tooth Width B2 | | 15.4 |
| Chain | | mm |
| Pitch | | 9.53 |
| Inside | | 5.72 |
| Roller ø | | 6.35 |

| Teeth | de | dp | Simplex | | | | Duplex | | | |
|-------|-------|-------|---------|----|----|---------|--------|----|----|---------|
| | | | dm | D1 | A | App. Kg | dm | D2 | A | App. Kg |
| 8 | 28.6 | 24.89 | 15 | 8 | 20 | 0.03 | | | | |
| 9 | 31.5 | 27.85 | 18 | 8 | 20 | 0.04 | 18 | 8 | 25 | |
| 10 | 34.5 | 30.82 | 20 | 8 | 20 | 0.06 | 20 | 8 | 25 | 0.11 |
| 11 | 37.5 | 33.8 | 22 | 8 | 25 | 0.09 | 22 | 10 | 30 | 0.13 |
| 12 | 40.5 | 36.8 | 25 | 8 | 25 | 0.10 | 25 | 10 | 30 | 0.16 |
| 13 | 43.5 | 39.8 | 28 | 8 | 25 | 0.11 | 28 | 10 | 30 | 0.20 |
| 14 | 46.5 | 42.8 | 31 | 8 | 25 | 0.12 | 31 | 10 | 30 | 0.25 |
| 15 | 49.5 | 45.81 | 34 | 8 | 25 | 0.14 | 34 | 10 | 30 | 0.29 |
| 16 | 52.5 | 48.82 | 37 | 10 | 28 | 0.18 | 37 | 12 | 30 | 0.34 |
| 17 | 55.5 | 51.83 | 40 | 10 | 28 | 0.20 | 40 | 12 | 30 | 0.39 |
| 18 | 58.6 | 54.85 | 43 | 10 | 28 | 0.23 | 43 | 12 | 30 | 0.45 |
| 19 | 61.6 | 57.87 | 45 | 10 | 28 | 0.25 | 46 | 12 | 30 | 0.52 |
| 20 | 64.6 | 60.89 | 46 | 10 | 28 | 0.31 | 49 | 12 | 30 | 0.59 |
| 21 | 67.6 | 63.91 | 48 | 12 | 28 | 0.36 | 52 | 16 | 30 | 0.68 |
| 22 | 70.6 | 66.93 | 50 | 12 | 28 | 0.37 | 55 | 16 | 30 | 0.75 |
| 23 | 73.7 | 69.95 | 52 | 12 | 28 | 0.39 | 58 | 16 | 30 | 0.80 |
| 24 | 76.7 | 72.97 | 54 | 12 | 28 | 0.40 | 61 | 16 | 30 | 0.84 |
| 25 | 79.7 | 76 | 57 | 12 | 28 | 0.41 | 64 | 16 | 30 | 0.89 |
| 26 | 82.7 | 79.02 | 60 | 12 | 28 | 0.42 | 67 | 16 | 30 | 0.91 |
| 27 | 85.7 | 82.04 | 60 | 12 | 28 | 0.44 | 70 | 16 | 30 | 1.00 |
| 28 | 88.8 | 85.07 | 60 | 12 | 28 | 0.45 | 73 | 16 | 30 | 1.07 |
| 29 | 91.8 | 88.09 | 60 | 12 | 28 | 0.47 | 76 | 16 | 30 | 1.14 |
| 30 | 94.8 | 91.12 | 60 | 12 | 28 | 0.48 | 79 | 16 | 30 | 1.22 |
| 31 | 97.9 | 94.15 | 65 | 14 | 30 | 0.51 | | | | |
| 32 | 100.9 | 97.17 | 65 | 14 | 30 | 0.56 | | | | |
| 33 | 103.9 | 100.2 | 65 | 14 | 30 | 0.62 | | | | |
| 34 | 106.9 | 103.2 | 65 | 14 | 30 | 0.66 | | | | |
| 35 | 110 | 106.3 | 65 | 14 | 30 | 0.68 | | | | |
| 36 | 113 | 109.3 | 70 | 16 | 30 | 0.71 | | | | |
| 37 | 116 | 112.3 | 70 | 16 | 30 | 0.74 | | | | |
| 38 | 119 | 115.3 | 70 | 16 | 30 | 0.77 | 90 | 16 | 30 | 1.72 |
| 39 | 122.1 | 118.4 | 70 | 16 | 30 | 0.79 | | | | |
| 40 | 125.1 | 121.4 | 70 | 16 | 30 | 0.81 | | | | |
| 45 | 140.2 | 136.5 | 75 | 16 | 30 | 0.91 | 90 | 19 | 35 | 2.35 |
| 57 | 176.6 | 172.9 | 75 | 19 | 30 | 1.27 | 90 | 19 | 35 | 3.47 |
| 76 | 234.2 | 230.5 | 75 | 19 | 30 | 1.91 | 90 | 19 | 38 | 5.67 |
| 95 | 291.8 | 288.1 | 75 | 19 | 30 | 2.61 | 95 | 25 | 38 | 8.64 |
| 114 | 349.4 | 345.7 | 75 | 19 | 30 | 3.63 | 95 | 25 | 38 | 11.12 |

British Standard Sprockets

“Why compete against your supplier when you can be our partner”

| 08B-1-2-3 Sprocket | | | Teeth | de | dp | Simplex | | | Duplex | | | Triplex | | | | | |
|--------------------|--|--|-------|-------|-------|---------|----|----|---------|-----|----|---------|---------|-----|----|----|---------|
| | | | | | | dm | D1 | A | App. Kg | dm | D2 | A | App. Kg | dm | D3 | A | App. Kg |
| | | | 8 | 38 | 33.18 | 20 | 10 | 25 | 0.13 | | | | | | | | |
| | | | 9 | 42 | 37.13 | 24 | 10 | 25 | 0.14 | 24 | 10 | 32 | 0.18 | | | | |
| | | | 10 | 45.9 | 41.1 | 26 | 10 | 25 | 0.15 | 28 | 10 | 32 | 0.22 | | | | |
| | | | 11 | 49.9 | 45.07 | 29 | 10 | 25 | 0.17 | 32 | 12 | 35 | 0.24 | | | | |
| | | | 12 | 53.9 | 49.07 | 33 | 10 | 28 | 0.24 | 35 | 12 | 35 | 0.26 | | | | |
| | | | 13 | 57.9 | 53.06 | 37 | 10 | 28 | 0.25 | 38 | 12 | 35 | 0.28 | 38 | 16 | 50 | 0.59 |
| | | | 14 | 61.9 | 57.07 | 41 | 10 | 28 | 0.31 | 42 | 12 | 35 | 0.34 | 42 | 16 | 50 | 0.72 |
| | | | 15 | 65.9 | 61.09 | 45 | 10 | 28 | 0.33 | 46 | 12 | 35 | 0.36 | 46 | 16 | 50 | 0.81 |
| | | | 16 | 69.9 | 65.1 | 50 | 12 | 28 | 0.37 | 50 | 16 | 38 | 0.40 | 50 | 16 | 50 | 0.90 |
| | | | 17 | 74 | 69.11 | 52 | 12 | 28 | 0.51 | 54 | 16 | 38 | 0.44 | 54 | 16 | 50 | 1.04 |
| | | | 18 | 78 | 73.14 | 56 | 12 | 28 | 0.54 | 58 | 16 | 38 | 0.49 | 58 | 16 | 50 | 1.22 |
| | | | 19 | 82 | 77.16 | 60 | 12 | 28 | 0.65 | 62 | 16 | 38 | 0.57 | 62 | 16 | 50 | 1.41 |
| | | | 20 | 86 | 81.19 | 64 | 12 | 28 | 0.76 | 66 | 16 | 38 | 0.65 | 66 | 16 | 50 | 1.58 |
| | | | 21 | 90.1 | 85.22 | 68 | 14 | 28 | 0.82 | 70 | 16 | 40 | 0.72 | 70 | 16 | 55 | 1.81 |
| | | | 22 | 94.1 | 89.24 | 70 | 14 | 28 | 0.88 | 70 | 16 | 40 | 0.80 | 70 | 16 | 55 | 2.03 |
| | | | 23 | 98.1 | 93.27 | 70 | 14 | 28 | 1.05 | 70 | 16 | 40 | 0.83 | 70 | 16 | 55 | 2.27 |
| | | | 24 | 102.1 | 97.29 | 70 | 14 | 28 | 1.07 | 75 | 16 | 40 | 0.94 | 75 | 16 | 55 | 2.44 |
| | | | 25 | 106.2 | 101.3 | 70 | 14 | 28 | 1.13 | 80 | 16 | 40 | 0.98 | 80 | 16 | 55 | 2.54 |
| | | | 26 | 110.2 | 105.4 | 70 | 16 | 30 | 1.15 | 85 | 16 | 40 | 1.04 | 85 | 20 | 55 | OA |
| | | | 27 | 114.2 | 109.4 | 70 | 16 | 30 | 1.19 | 85 | 16 | 40 | 1.08 | 85 | 20 | 55 | 2.85 |
| | | | 28 | 118.3 | 113.4 | 70 | 16 | 30 | 1.30 | 90 | 16 | 40 | 1.10 | 90 | 20 | 55 | 3.16 |
| | | | 29 | 121 | | 80 | 11 | 30 | OA | OA | OA | OA | OA | 95 | 20 | 55 | OA |
| | | | 30 | 126.3 | 121.5 | 80 | 16 | 30 | 1.36 | 100 | 16 | 40 | 1.16 | 95 | 20 | 55 | 3.48 |
| | | | 31 | 130.4 | 125.5 | 90 | 16 | 30 | 1.41 | | | | | | | | |
| | | | 32 | 134.4 | 129.6 | 90 | 16 | 30 | 1.46 | 100 | 20 | 40 | 1.24 | | | | |
| | | | 33 | 138.4 | 133.6 | 90 | 16 | 30 | 1.51 | | | | | | | | |
| | | | 34 | 142.5 | 137.6 | 90 | 16 | 30 | 1.56 | 100 | 20 | 40 | 1.33 | | | | |
| | | | 35 | 146.5 | 141.7 | 90 | 16 | 30 | 1.61 | | | | | | | | |
| | | | 36 | 150.6 | 145.7 | 90 | 16 | 35 | 1.69 | 100 | 20 | 40 | 2.05 | | | | |
| | | | 37 | 154.6 | 149.8 | 90 | 16 | 35 | 1.74 | | | | | | | | |
| | | | 38 | 158.6 | 153.8 | 90 | 16 | 35 | 1.78 | 100 | 20 | 40 | 2.17 | 120 | 25 | 55 | 6.49 |
| | | | 39 | 162.7 | 157.8 | 90 | 16 | 35 | 1.83 | | | | | | | | |
| | | | 40 | 166.7 | 161.9 | 90 | 16 | 35 | 1.88 | 100 | 20 | 40 | 2.28 | | | | |
| | | | 41 | 171 | | | | | | OA | OA | OA | | | | | |
| | | | 42 | 176.5 | 170 | 90 | 19 | 35 | 1.97 | 110 | 20 | 45 | 2.32 | | | | |
| | | | 43 | 179 | | | | | | OA | OA | OA | | | | | |
| | | | 44 | 185 | | | | | | OA | OA | OA | | | | | |
| | | | 45 | 188.6 | 182.1 | 90 | 19 | 35 | 2.11 | 110 | 20 | 45 | 2.49 | | | | |
| | | | 46 | 193 | | | | | | OA | OA | OA | | | | | |
| | | | 48 | 200.7 | 194.2 | 100 | 19 | 35 | 2.76 | 110 | 20 | 45 | 2.65 | | | | |
| | | | 50 | 208.8 | 202.3 | OA | OA | OA | 2.90 | OA | OA | OA | | | | | |
| | | | 55 | 229 | 222.5 | OA | OA | OA | 3.15 | | | | | | | | |
| | | | 57 | 233.1 | 230.5 | 100 | 19 | 35 | 3.28 | 110 | 25 | 45 | 3.88 | 120 | 25 | 60 | 12.62 |
| | | | 60 | 249.2 | 242.7 | 100 | 19 | 35 | 3.45 | | | | | | | | |
| | | | 76 | 313.9 | 307.3 | 100 | 19 | 35 | 5.73 | 120 | 30 | 45 | 6.60 | 130 | 30 | 65 | 22.23 |
| | | | 95 | 390.7 | 384.1 | 100 | 25 | 35 | 8.90 | 120 | 30 | 45 | 9.89 | | | | |
| | | | 114 | 467.4 | 460.9 | 100 | 25 | 35 | 11.17 | 120 | 30 | 45 | 12.88 | | | | |

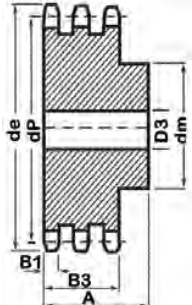
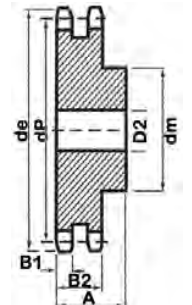
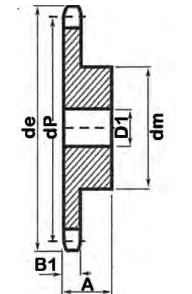
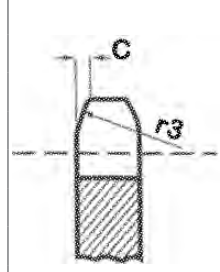

| Pinions | mm |
|-----------------|------|
| Tooth Radius r3 | |
| Radius Width C | |
| Tooth Width B1 | 7.2 |
| Tooth Width b1 | |
| Tooth Width B2 | 21 |
| Tooth Width B3 | 34.9 |
| Chain | mm |
| Pitch | 12.7 |
| Inside | 7.75 |
| Roller ø | 8.51 |

British Standard Sprockets

10B-1-2-3 Sprocket

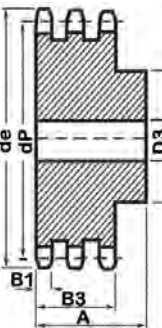
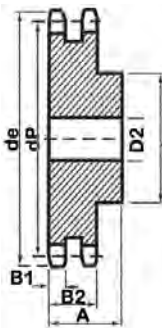
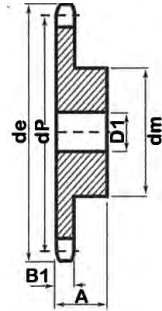
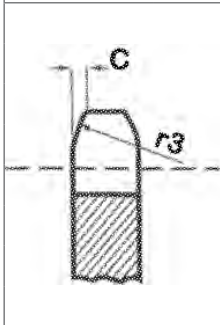

| Pinions | mm |
|-----------------|------|
| Tooth Radius r3 | |
| Radius Width C | |
| Tooth Width B1 | 9.1 |
| Tooth Width b1 | |
| Tooth Width B2 | 25.5 |
| Tooth Width B3 | |
| Chain | mm |
| Pitch | 5.88 |
| Inside | 9.65 |
| Roller ø | 10.2 |

| Teeth | de | dp | Simplex | | | | Duplex | | | |
|-------|-------|-------|---------|----|----|---------|--------|----|----|---------|
| | | | dm | D1 | A | App. Kg | dm | D2 | A | App. Kg |
| 8 | 48.4 | 41.48 | 25 | 10 | 25 | 0.09 | | | | |
| 9 | 53.3 | 46.42 | 30 | 10 | 25 | 0.14 | 30 | 12 | 40 | 0.31 |
| 10 | 58.3 | 51.37 | 35 | 10 | 25 | 0.23 | 35 | 12 | 40 | 0.39 |
| 11 | 63.2 | 56.35 | 37 | 12 | 30 | 0.27 | 39 | 16 | 40 | 0.44 |
| 12 | 68.2 | 61.34 | 42 | 12 | 30 | 0.32 | 44 | 16 | 40 | 0.57 |
| 13 | 73.2 | 66.32 | 47 | 12 | 30 | 0.36 | 49 | 16 | 40 | 0.71 |
| 14 | 78.2 | 71.34 | 52 | 12 | 30 | 0.45 | 54 | 16 | 40 | 0.84 |
| 15 | 83.2 | 76.36 | 57 | 12 | 30 | 0.59 | 59 | 16 | 40 | 1.01 |
| 16 | 88.3 | 81.37 | 60 | 12 | 30 | 0.68 | 64 | 16 | 45 | 1.19 |
| 17 | 93.3 | 86.39 | 60 | 12 | 30 | 0.82 | 69 | 16 | 45 | 1.38 |
| 18 | 98.3 | 91.42 | 70 | 14 | 30 | 0.91 | 74 | 16 | 45 | 1.62 |
| 19 | 103.3 | 96.45 | 70 | 14 | 30 | 1.04 | 79 | 16 | 45 | 1.77 |
| 20 | 108.4 | 101.5 | 75 | 14 | 30 | 1.13 | 84 | 16 | 45 | 1.93 |
| 21 | 113.4 | 106.5 | 75 | 16 | 30 | 1.18 | 85 | 20 | 45 | 2.22 |
| 22 | 118.4 | 111.6 | 80 | 16 | 30 | 1.27 | 90 | 20 | 45 | 2.53 |
| 23 | 123.5 | 116.6 | 80 | 16 | 30 | 1.45 | 95 | 20 | 45 | 2.77 |
| 24 | 128.5 | 121.6 | 80 | 16 | 30 | 1.50 | 100 | 20 | 45 | 2.95 |
| 25 | 133.6 | 126.7 | 80 | 16 | 30 | 1.59 | 105 | 20 | 45 | 3.15 |
| 26 | 138.6 | 131.7 | 85 | 20 | 35 | 1.63 | 110 | 20 | 45 | 3.42 |
| 27 | 143.6 | 136.8 | 85 | 20 | 35 | 1.68 | 110 | 20 | 45 | 3.98 |
| 28 | 148.7 | 141.8 | 90 | 20 | 35 | 1.72 | 115 | 20 | 45 | 4.2 |
| 29 | 153.7 | 146.8 | 90 | 20 | 35 | 1.91 | 115 | 20 | 45 | 4.43 |
| 30 | 158.8 | 151.9 | 90 | 20 | 35 | 2.04 | 120 | 20 | 45 | 4.66 |
| 31 | 163.8 | 156.9 | 95 | 20 | 35 | 2.13 | | | | |
| 32 | 168.9 | 162 | 95 | 20 | 35 | 2.27 | | | | |
| 33 | 173.9 | 167 | 95 | 20 | 35 | 2.33 | | | | |
| 34 | 178.9 | 172.1 | 95 | 20 | 35 | 2.36 | | | | |
| 35 | 184 | 177.1 | 95 | 20 | 35 | 2.48 | | | | |
| 36 | 189 | 182.2 | 100 | 20 | 35 | 2.56 | | | | |
| 37 | 194.1 | 187.2 | 100 | 20 | 35 | 2.68 | | | | |
| 38 | 199.1 | 192.2 | 100 | 20 | 35 | 2.72 | 120 | 20 | 45 | 7.67 |
| 39 | 204.2 | 197.3 | 100 | 20 | 35 | 2.86 | | | | |
| 40 | 209.2 | 202.3 | 100 | 20 | 35 | 2.95 | 120 | 20 | 45 | 7.92 |
| 42 | 220.8 | 212.4 | OA | OA | OA | 3.01 | | | | |
| 45 | 236 | 227.6 | OA | OA | OA | 3.73 | OA | OA | OA | 9.21 |
| 48 | 251.1 | 242.7 | OA | OA | OA | 4.18 | | | | |
| 50 | 261.2 | 252.8 | OA | OA | OA | 4.40 | | | | |
| 55 | 286.5 | 278.1 | OA | OA | OA | 4.96 | | | | |
| 57 | 296.6 | 288.2 | OA | OA | OA | 5.27 | OA | OA | OA | 15.07 |
| 60 | 311.7 | 303.3 | OA | OA | OA | 5.9 | | | | |
| 76 | 392.5 | 384.2 | OA | OA | OA | 11.03 | OA | OA | OA | 26.31 |
| 95 | 488.5 | 480.1 | OA | OA | OA | 14.57 | OA | OA | OA | 32.69 |
| 114 | 584.5 | 576.1 | OA | OA | OA | 20.61 | OA | OA | OA | 49.3 |

British Standard Sprockets



"Why compete against your supplier when you can be our partner"

| 12B-1-2-3 Sprocket | | | Teeth | de | dp | Simplex | | | Duplex | | | Triplex | | | | | |
|--------------------|--|--|-------|-------|-------|---------|----|----|---------|-----|----|---------|---------|-----|----|----|---------|
| | | | | | | dm | D1 | A | App. Kg | dm | D2 | A | App. Kg | dm | D3 | A | App. Kg |
| | | | 8 | 58 | 49.78 | 31 | 12 | 30 | | | | | | | | | |
| | | | 9 | 63.9 | 55.7 | 37 | 12 | 30 | | 37 | 16 | 45 | 0.75 | | | | |
| | | | 10 | 69.8 | 61.64 | 42 | 12 | 30 | | 42 | 16 | 45 | 0.90 | | | | |
| | | | 11 | 75.8 | 67.61 | 46 | 16 | 35 | 0.53 | 47 | 16 | 50 | 1.00 | | | | |
| | | | 12 | 81.8 | 73.6 | 52 | 16 | 35 | 0.67 | 53 | 16 | 50 | 1.23 | | | | |
| | | | 13 | 87.8 | 79.59 | 58 | 16 | 35 | 0.75 | 59 | 16 | 50 | 1.41 | 59 | 20 | 70 | 1.77 |
| | | | 14 | 93.8 | 85.61 | 64 | 16 | 35 | 0.91 | 65 | 20 | 50 | 1.68 | | | | |
| | | | 15 | 99.8 | 91.63 | 70 | 16 | 35 | 1.14 | 71 | 20 | 50 | 1.95 | 71 | 20 | 70 | 2.45 |
| | | | 16 | 105.8 | 97.65 | 75 | 16 | 35 | 1.27 | 77 | 20 | 50 | 2.27 | | | | |
| | | | 17 | 111.9 | 103.7 | 80 | 16 | 35 | 1.46 | 83 | 20 | 50 | 2.63 | 83 | 20 | 70 | 3.49 |
| | | | 18 | 117.9 | 109.7 | 80 | 16 | 35 | 1.69 | 89 | 20 | 50 | 3.18 | | | | |
| | | | 19 | 123.9 | 115.8 | 80 | 16 | 35 | 1.78 | 95 | 20 | 50 | 3.50 | 95 | 20 | 70 | 4.54 |
| | | | 20 | 130 | 121.8 | 80 | 16 | 35 | 2.10 | 100 | 20 | 50 | 3.72 | | | | |
| | | | 21 | 136 | 127.8 | 90 | 20 | 40 | 2.27 | 100 | 20 | 50 | 4.31 | 100 | 25 | 70 | 5.67 |
| | | | 22 | 142 | 133.9 | 90 | 20 | 40 | 2.38 | 100 | 20 | 50 | 4.77 | | | | |
| | | | 23 | 148.1 | 139.9 | 90 | 20 | 40 | 2.49 | 110 | 20 | 50 | 4.99 | 110 | 25 | 70 | 6.62 |
| | | | 24 | 154.1 | 145.9 | 90 | 20 | 40 | 2.62 | 110 | 20 | 50 | 5.45 | | | | |
| | | | 25 | 160.2 | 152 | 90 | 20 | 40 | 2.78 | 120 | 20 | 50 | 5.67 | 120 | 25 | 70 | 7.71 |
| | | | 26 | 166.2 | 158 | 95 | 20 | 40 | 2.89 | 120 | 20 | 50 | 6.13 | | | | |
| | | | 27 | 172.3 | 164.1 | 95 | 20 | 40 | 3.05 | 120 | 20 | 50 | 6.49 | 120 | 25 | 70 | 8.99 |
| | | | 28 | 178.3 | 170.1 | 95 | 20 | 40 | 3.12 | 120 | 20 | 50 | 6.81 | | | | |
| | | | 29 | 184.4 | 176.2 | 95 | 20 | 40 | 3.30 | 120 | 20 | 50 | 7.13 | | | | |
| | | | 30 | 190.4 | 182.3 | 95 | 20 | 40 | 3.44 | 120 | 20 | 50 | 7.49 | 120 | 25 | 70 | 10.53 |
| | | | 31 | 196.5 | 188.3 | 95 | 20 | 40 | 3.50 | | | | | | | | |
| | | | 32 | 202.5 | 194.4 | 95 | 20 | 40 | 3.75 | | | | | | | | |
| | | | 33 | 208.6 | 200.4 | 95 | 20 | 40 | 3.82 | | | | | | | | |
| | | | 34 | 214.6 | 206.5 | 95 | 20 | 40 | 3.99 | | | | | | | | |
| | | | 35 | 220.7 | 212.5 | 95 | 20 | 40 | 4.10 | 120 | 20 | 50 | 10.18 | | | | |
| | | | 36 | 226.8 | 218.6 | 100 | 25 | 40 | 4.35 | 120 | 25 | 50 | 12.31 | | | | |
| | | | 37 | 232.8 | 224.6 | 100 | 25 | 40 | 4.64 | | | | | | | | |
| | | | 38 | 238.9 | 230.1 | 100 | 25 | 40 | 4.92 | 120 | 25 | 50 | 12.99 | 130 | 25 | 70 | 20.57 |
| | | | 39 | 244.9 | 236.8 | 100 | 25 | 40 | 5.15 | | | | | | | | |
| | | | 40 | 251 | 242.8 | 100 | 25 | 40 | 5.22 | | | | | | | | |
| | | | 41 | 258 | | 100 | 25 | 40 | OA | | | | | | | | |
| | | | 42 | 265 | 254.9 | OA | OA | OA | 5.78 | | | | | | | | |
| | | | 43 | 272 | | 100 | 25 | 40 | OA | | | | | | | | |
| | | | 44 | 276 | | 100 | 25 | 40 | OA | | | | | | | | |
| | | | 45 | 283.2 | 273.1 | OA | OA | OA | 6.34 | OA | OA | OA | 15.38 | | | | |
| | | | 48 | 301.4 | 291.3 | OA | OA | OA | 7.18 | | | | | | | | |
| | | | 50 | 313.5 | 303.4 | OA | OA | OA | 8.01 | | | | | | | | |
| | | | 55 | 343.8 | 333.7 | OA | OA | OA | 9.90 | | | | | | | | |
| | | | 57* | 355.9 | 345.8 | OA | OA | OA | 10.10 | OA | OA | OA | 25.34 | OA | OA | OA | 33.73 |
| | | | 60 | 374.1 | 364 | OA | OA | OA | 11.44 | | | | | | | | |
| | | | 76* | 471.1 | 461 | OA | OA | OA | 17.26 | OA | OA | OA | 25.63 | OA | OA | OA | 37.19 |
| | | | 95 | 586.2 | 576.2 | OA | OA | OA | 23.83 | OA | OA | OA | 39.24 | | | | |
| | | | 114 | OA | | OA | OA | OA | OA | | | | | | | | |

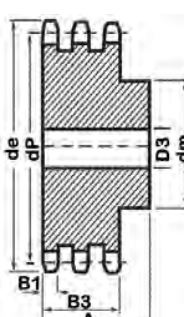
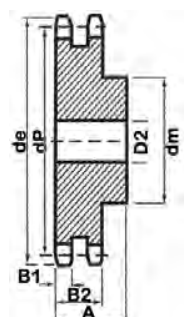
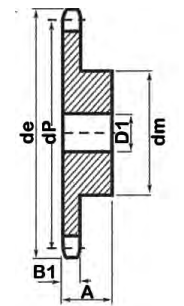
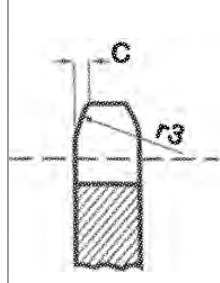

| | |
|-----------------|-------|
| Pinions | mm |
| Tooth Radius r3 | |
| Radius Width C | |
| Tooth Width B1 | 11.1 |
| Tooth Width b1 | |
| Tooth Width B2 | 30.3 |
| Tooth Width B3 | 49.8 |
| Chain | mm |
| Pitch | 19.05 |
| Inside | 11.68 |
| Roller ø | 12.07 |

British Standard Sprockets

16B-1-2-3 Sprocket

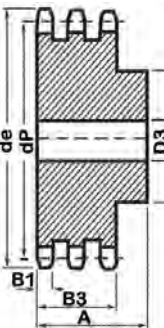
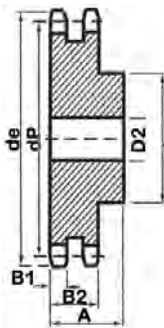
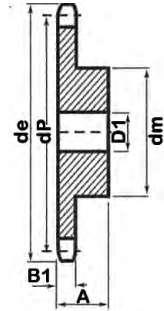
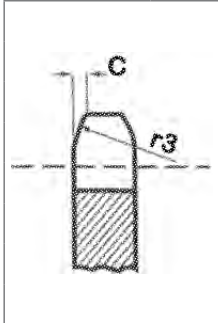

| Pinions | mm |
|-----------------|-------|
| Tooth Radius r3 | |
| Radius Width C | |
| Tooth Width B1 | 16.2 |
| Tooth Width b1 | |
| Tooth Width B2 | 47.7 |
| Tooth Width B3 | 79.6 |
| | |
| Chain | mm |
| Pitch | 25.4 |
| Inside | 17 |
| Roller ø | 15.88 |

| Teeth | de | dp | Simplex | | | | Duplex | | | | Triplex | | | | | |
|-------|-------|-------|---------|----|----|---------|--------|----|----|---------|---------|----|-----|---------|--|--|
| | | | dm | D1 | A | App. Kg | dm | D2 | A | App. Kg | dm | D3 | A | App. Kg | | |
| 8 | 77.9 | 66.37 | 42 | 16 | 35 | 0.95 | | | | | | | | | | |
| 9 | 85.8 | 74.27 | 50 | 16 | 35 | 1.20 | 50 | 20 | 65 | | | | | | | |
| 10 | 93.8 | 82.19 | 55 | 16 | 35 | 1.35 | 56 | 20 | 65 | | | | | | | |
| 11 | 101.7 | 90.14 | 61 | 16 | 40 | 1.45 | 64 | 20 | 70 | 1.82 | | | | | | |
| 12 | 109.7 | 98.14 | 69 | 16 | 40 | 1.82 | 72 | 20 | 70 | 2.36 | | | | | | |
| 13 | 117.7 | 106.1 | 78 | 16 | 40 | 1.94 | 80 | 20 | 70 | 1.95 | 80 | 25 | 100 | 4.13 | | |
| 14 | 125.7 | 114.2 | 84 | 16 | 40 | 2.09 | 88 | 20 | 70 | 3.5 | | | | | | |
| 15 | 133.7 | 122.2 | 92 | 16 | 40 | 2.59 | 96 | 20 | 70 | 4.18 | 96 | 25 | 100 | 5.54 | | |
| 16 | 141.8 | 130.2 | 100 | 20 | 45 | 3.00 | 104 | 25 | 70 | 5.22 | | | | | | |
| 17 | 149.8 | 138.2 | 100 | 20 | 45 | 3.18 | 112 | 25 | 70 | 5.99 | 112 | 25 | 100 | 8.07 | | |
| 18 | 157.8 | 146.3 | 100 | 20 | 45 | 3.77 | 120 | 25 | 70 | 6.81 | | | | | | |
| 19 | 165.9 | 154.4 | 100 | 20 | 45 | 3.86 | 128 | 25 | 70 | 7.71 | 128 | 25 | 100 | 10.89 | | |
| 20 | 173.9 | 162.4 | 100 | 20 | 45 | 4.09 | 130 | 25 | 70 | 8.26 | | | | | | |
| 21 | 182 | 170.4 | 110 | 20 | 50 | 4.54 | 130 | 25 | 70 | 8.85 | 130 | 25 | 100 | 13.61 | | |
| 22 | 190.1 | 178.5 | 110 | 20 | 50 | 5.00 | 130 | 25 | 70 | 9.53 | | | | | | |
| 23 | 198.1 | 186.5 | 110 | 20 | 50 | 5.08 | 130 | 25 | 70 | 10.43 | 130 | 25 | 100 | 14.97 | | |
| 24 | 206.2 | 194.6 | 110 | 20 | 50 | 5.54 | 130 | 25 | 70 | 11.44 | | | | | | |
| 25 | 214.2 | 202.7 | 110 | 20 | 50 | 5.76 | 130 | 25 | 70 | 12.47 | 130 | 25 | 100 | 17.70 | | |
| 26 | 222.3 | 210.7 | 120 | 20 | 50 | 7.03 | 130 | 25 | 70 | 13.62 | | | | | | |
| 27 | 230.4 | 218.8 | 120 | 20 | 50 | 7.53 | 130 | 25 | 70 | 14.75 | 130 | 30 | 100 | 21.57 | | |
| 28 | 238.4 | 226.9 | 120 | 20 | 50 | 7.58 | 130 | 25 | 70 | 15.89 | | | | | | |
| 29 | 246.5 | 234.9 | 120 | 20 | 50 | 7.94 | 130 | 25 | 70 | 17.02 | | | | | | |
| 30 | 254.6 | 243 | 120 | 20 | 50 | 8.26 | 130 | 25 | 70 | 18.16 | 130 | 30 | 100 | 26.33 | | |
| 31 | 262.6 | 251.1 | 120 | 25 | 50 | 8.62 | | | | | | | | | | |
| 32 | 270.7 | 259.1 | 120 | 25 | 50 | 8.98 | | | | | | | | | | |
| 33 | 278.8 | 267.2 | 120 | 25 | 50 | 9.33 | | | | | | | | | | |
| 34 | 286.9 | 275.3 | 120 | 25 | 50 | 9.69 | | | | | | | | | | |
| 35 | 294.9 | 283.4 | 120 | 25 | 50 | 10.05 | | | | | | | | | | |
| 36 | 303 | 291.4 | 120 | 25 | 50 | 10.41 | | | | | | | | | | |
| 37 | 311.1 | 299.5 | 120 | 25 | 50 | 10.78 | | | | | | | | | | |
| 38 | 319.2 | 307.6 | 120 | 25 | 50 | 11.12 | 140 | 25 | 70 | 29.60 | 140 | 30 | 100 | 41.45 | | |
| 39 | 327.2 | 315.7 | 120 | 25 | 50 | 11.48 | | | | | | | | | | |
| 40 | 335.3 | 323.4 | 120 | 25 | 50 | 11.83 | | | | | | | | | | |
| 45 | 377.9 | 364.1 | OA | OA | OA | 13.62 | OA | OA | OA | 34.35 | OA | OA | OA | 45.00 | | |
| 57* | 474.9 | 461.1 | OA | OA | OA | 22.16 | OA | OA | OA | 38.18 | OA | OA | OA | 51.35 | | |
| 76* | 628.4 | 614.7 | OA | OA | OA | 39.24 | OA | OA | OA | 68.11 | OA | OA | OA | 77.11 | | |
| 95 | 782 | 768.2 | OA | OA | OA | 57.12 | | | | | | | | | | |
| 114 | 935.6 | 921.8 | OA | OA | OA | 75.00 | | | | | | | | | | |

British Standard Sprockets

“Why compete against your supplier when you can be our partner”

| 20B-1-2 Sprocket | | Teeth | de | dp | Simplex | | | Duplex | | | | |
|------------------|--|-------|-------|-------|---------|----|----|---------|-----|----|----|---------|
| | | | | | dm | D1 | A | App. Kg | dm | D2 | A | App. Kg |
| | | 9 | 106.5 | 92.84 | 63 | 20 | 40 | 1.45 | | | | |
| | | 10 | 117 | 102.7 | 70 | 20 | 40 | 1.86 | | | | |
| | | 11 | 127 | 112.7 | 77 | 20 | 45 | 2.40 | 80 | 25 | 80 | 3.67 |
| | | 12 | 137 | 122.7 | 88 | 20 | 45 | 2.95 | 90 | 25 | 80 | 0A |
| | | 13 | 147.5 | 132.7 | 98 | 20 | 45 | 3.00 | 100 | 25 | 80 | 5.53 |
| | | 14 | 157.6 | 142.7 | 108 | 20 | 45 | 3.40 | 110 | 25 | 80 | 6.62 |
| | | 15 | 167.6 | 152.7 | 118 | 20 | 45 | 4.31 | 120 | 25 | 80 | 7.76 |
| | | 16 | 177.7 | 162.8 | 120 | 25 | 50 | 4.63 | 120 | 30 | 80 | 0A |
| | | 17 | 187.8 | 172.8 | 120 | 25 | 50 | 4.99 | 120 | 30 | 80 | 10.44 |
| | | 18 | 197.8 | 182.9 | 120 | 25 | 50 | 5.44 | 120 | 30 | 80 | 0A |
| | | 19 | 207.9 | 192.9 | 120 | 25 | 50 | 5.9 | 120 | 30 | 80 | 12.92 |
| | | 20 | 217.9 | 203 | 120 | 25 | 50 | 6.35 | 120 | 30 | 80 | 0A |
| | | 21 | 228 | 213 | 140 | 30 | 55 | 7.03 | 140 | 30 | 80 | 16.55 |
| | | 22 | 238.1 | 223.1 | 140 | 30 | 55 | 7.71 | 140 | 30 | 80 | 0A |
| | | 23 | 248.2 | 233.2 | 140 | 30 | 55 | 8.16 | 140 | 30 | 80 | 19.05 |
| | | 24 | 258.3 | 243.2 | 140 | 30 | 55 | 8.62 | 140 | 30 | 80 | 0A |
| | | 25 | 268.4 | 253.3 | 140 | 30 | 55 | 9.07 | 140 | 30 | 80 | 21.77 |
| | | 26 | 278.4 | 263.4 | 150 | 30 | 55 | 9.53 | 150 | 30 | 80 | 0A |
| | | 27 | 288.5 | 273.5 | 150 | 30 | 55 | 10.43 | 150 | 30 | 80 | 24.97 |
| | | 28 | 299 | 283.6 | 0A | 0A | 0A | 11.34 | 150 | 30 | 80 | 0A |
| | | 30 | 319 | 303.8 | 0A | 0A | 0A | 12.02 | 150 | 30 | 80 | 0A |

| 24B-1-2 Sprocket | | Teeth | de | dp | Simplex | | | Duplex | | | | |
|------------------|--|-------|-------|-------|---------|----|-----|---------|-----|----|-----|---------|
| | | | | | dm | D1 | A | App. Kg | dm | D2 | A | App. Kg |
| | | 9 | 125 | 111.4 | 70 | 25 | 95 | 2.02 | | | | |
| | | 10 | 137 | 123.3 | 80 | 25 | 95 | 2.61 | | | | |
| | | 11 | 149 | 135.2 | 90 | 25 | 100 | 3.77 | 90 | 25 | 100 | 6.50 |
| | | 12 | 161 | 147.2 | 102 | 25 | 100 | 4.77 | 102 | 25 | 0A | 0A |
| | | 13 | 137 | 159.2 | 114 | 25 | 100 | 5.91 | 114 | 25 | 100 | 9.92 |
| | | 14 | 185 | 171.2 | 128 | 25 | 100 | 6.68 | 128 | 25 | 100 | 11.98 |
| | | 15 | 197 | 183.3 | 132 | 25 | 100 | 7.49 | 132 | 25 | 100 | 14.13 |
| | | 16 | 209 | 195.3 | 136 | 30 | 100 | 9.08 | 136 | 30 | 100 | 16.35 |
| | | 17 | 221 | 207.3 | 136 | 30 | 100 | 9.76 | 136 | 30 | 100 | 17.85 |
| | | 18 | 233 | 219.4 | 160 | 30 | 100 | 10.49 | 160 | 30 | 100 | 20.35 |
| | | 19 | 245.5 | 231.5 | 160 | 30 | 100 | 11.21 | 160 | 30 | 100 | 22.56 |
| | | 20 | 257.5 | 243.6 | 160 | 30 | 100 | 12.26 | 160 | 30 | 100 | 24.78 |
| | | 21 | 270.5 | 255.7 | 160 | 30 | 100 | 13.38 | 160 | 30 | 100 | 26.99 |
| | | 22 | 282.5 | 267.7 | 160 | 30 | 100 | 13.67 | 160 | 30 | 100 | 29.74 |
| | | 23 | 294.5 | 279.8 | 160 | 30 | 100 | 14.74 | 0A | 0A | 0A | 0A |
| | | 24 | 307 | 292 | 0A | 0A | 0A | 0A | 0A | 0A | 0A | 0A |
| | | 25 | 319 | 304 | 160 | 30 | 100 | 16.38 | 0A | 0A | 0A | 0A |
| | | 26 | 331 | 317 | 0A | 0A | 0A | 0A | 0A | 0A | 0A | 0A |
| | | 27 | 343 | 328 | 0A | 0A | 0A | 0A | 0A | 0A | 0A | 0A |
| | | 28 | 355 | 340 | 0A | 0A | 0A | 0A | 0A | 0A | 0A | 0A |
| | | 29 | 367 | 352 | 0A | 0A | 0A | 0A | 0A | 0A | 0A | 0A |
| | | 30 | 379 | 365 | 0A | 0A | 0A | 0A | 0A | 0A | 0A | 0A |

British Standard Taper Locks

06B-1-2 Taper Lock

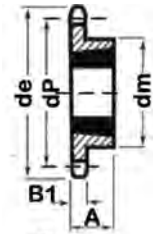
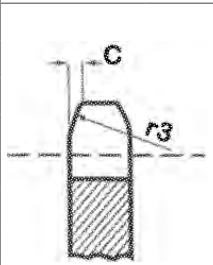

Type 1

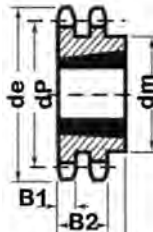

Type 2

| | |
|-----------------|------|
| Pinions | mm |
| Tooth Radius r3 | |
| Radius Width C | |
| Tooth Width B1 | 5.3 |
| Chain | mm |
| Pitch | 9.53 |
| Inside | 5.72 |
| Roller ø | 6.35 |

| Teeth | de | dp | Simplex | | | | | Duplex | | | | |
|-------|-------|-------|---------|-------|------|------|---------|--------|----|------|------|---------|
| | | | dm | A | Bush | Type | App. Kg | dm | A | Bush | Type | App. Kg |
| 17 | 55.5 | 51.83 | 45 | 22.23 | 1008 | 1 | 0.14 | 41 | 22 | 1008 | 2 | 0.5 |
| 18 | 58.6 | 54.85 | 45 | 22.23 | 1008 | 1 | 0.18 | 43 | 22 | 1008 | 2 | 0A |
| 19 | 61.6 | 57.87 | 45 | 22.23 | 1008 | 1 | 0.23 | 46 | 22 | 1008 | 2 | 0.6 |
| 20 | 64.6 | 60.89 | 45 | 22.23 | 1008 | 1 | 0.27 | 48 | 22 | 1008 | 2 | 0A |
| 21 | 67.6 | 63.91 | 45 | 22.23 | 1008 | 1 | 0.32 | 49 | 22 | 1008 | 2 | 1.4 |
| 22 | 70.6 | 66.93 | 45 | 22.23 | 1008 | 1 | 0.36 | 52 | 22 | 1008 | 2 | 0A |
| 23 | 73.7 | 69.95 | 63 | 25.40 | 1210 | 1 | 0.41 | 59 | 25 | 1210 | 2 | 1.8 |
| 24 | 76.7 | 72.97 | 63 | 25.40 | 1210 | 1 | 0.45 | 61 | 25 | 1210 | 2 | 0A |
| 25 | 79.7 | 76 | 63 | 25.40 | 1210 | 1 | 0.54 | 64 | 25 | 1210 | 2 | 1.9 |
| 26 | 83 | 79.02 | 63 | 0A | 1210 | 0A | 0A | 0A | 0A | 1210 | 0A | 0A |
| 27 | 85.7 | 82.04 | 63 | 25.40 | 1210 | 1 | 0.52 | 70 | 25 | 1210 | 2 | 2.0 |
| 28 | 89 | 85.07 | 63 | 0A | 1210 | 0A | 0A | 0A | 0A | 1210 | 0A | 0A |
| 29 | 0A | 0A | 63 | 25.40 | 1210 | 0A | 0A | 0A | 0A | 1210 | 0A | 0A |
| 30 | 94.8 | 91.12 | 63 | 25.40 | 1210 | 1 | 0.54 | 75 | 25 | 1210 | 2 | 2.1 |
| 36 | 113 | | | | | | | 80 | 25 | 1610 | 0A | 0A |
| 38 | 119 | 115.3 | 70 | 25.40 | 1210 | 1 | 0.68 | 80 | 25 | 1610 | 2 | 2.5 |
| 45 | 118.6 | 114.7 | 70 | 25.40 | 1210 | 1 | 0.95 | | | | | |
| 57 | 149.3 | 145.2 | 83 | 25.40 | 1210 | 1 | 1.25 | 92 | 25 | 1610 | 2 | 4.1 |
| 76 | 197.9 | 193.6 | 83 | 25.40 | 1210 | 1 | 1.82 | 0A | 0A | 1615 | 2 | 6.8 |
| 95 | 246.3 | 242 | 83 | 25.40 | 1210 | 1 | 2.28 | 0A | 0A | 1615 | 2 | 6.9 |
| 114 | 294.8 | 290.3 | 0A | 0A | 1610 | 0A | 0A | | | | | |

08B-1-2 Taper Lock

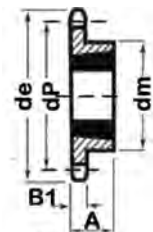
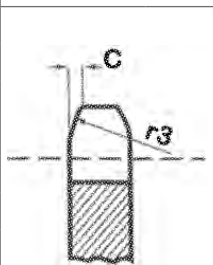

Type 1

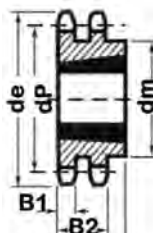

Type 2

| | |
|-----------------|------|
| Pinions | mm |
| Tooth Radius r3 | |
| Radius Width C | |
| Tooth Width B1 | 7.2 |
| Chain | mm |
| Pitch | 12.7 |
| Inside | 7.75 |
| Roller ø | 8.51 |

| Teeth | de | dp | Simplex | | | | | Duplex | | | | |
|-------|-------|-------|---------|-------|-----------|------|---------|--------|-------|------|------|---------|
| | | | dm | A | Bush | Type | App. Kg | dm | A | Bush | Type | App. Kg |
| 15 | 65.9 | 61.09 | 45 | 22.23 | 1008 | 1 | 0.18 | 46 | 22.23 | 1008 | 2 | 0.18 |
| 16 | 69.9 | 65.1 | 45 | 22.23 | 1008/1108 | 1 | 0.23 | 50 | 22 | 1008 | 2 | 0A |
| 17 | 74 | 69.11 | 60 | 25.40 | 1210 | 1 | 0.23 | 56 | 25.40 | 1210 | 2 | 0.27 |
| 18 | 78 | 73.14 | 62 | 25.40 | 1210 | 1 | 0.27 | 60 | 25 | 1210 | 2 | |
| 19 | 82 | 77.16 | 63 | 25.40 | 1210 | 1 | 0.32 | 62 | 25.40 | 1210 | 2 | 0.36 |
| 20 | 86 | 81.19 | 71 | 25.40 | 1210/1610 | 1 | 0.41 | 66 | 25 | 1610 | 2 | 0A |
| 21 | 90.1 | 85.22 | 71 | 25.40 | 1610 | 1 | 0.45 | 70 | 25.40 | 1610 | 2 | 0.46 |
| 22 | 94.1 | 89.24 | 71 | 25.40 | 1610 | 1 | 0.50 | 76 | 25 | 1610 | 2 | 0A |
| 23 | 98.1 | 93.27 | 76 | 25.40 | 1610 | 1 | 0.59 | 79 | 25.40 | 1610 | 2 | 0.59 |
| 24 | 102.1 | 97.29 | 76 | 25.40 | 1610 | 1 | 0.73 | 84 | 25 | 2012 | 2 | 0A |
| 25 | 106.2 | 101.3 | 76 | 25.40 | 1610 | 1 | 0.74 | 87 | 31.75 | 2012 | 2 | 0.77 |
| 26 | 110.2 | 105.4 | 76 | 25.40 | 1610 | 1 | 0.76 | 87 | 32 | 2012 | 2 | 0A |
| 27 | 114.2 | 109.4 | 76 | 25.40 | 1610 | 1 | 0.78 | 87 | 31.75 | 2012 | 2 | 0.95 |
| 28 | 118.3 | 113.4 | 76 | 25.40 | 1610 | 1 | 0.80 | 87 | 32 | 2012 | 2 | 0A |
| 29 | 112.3 | 117.5 | 76 | 25.40 | 1610 | 1 | 0.81 | 0A | 0A | 2012 | 2 | 0A |
| 30 | 126.3 | 121.5 | 90 | 31.75 | 2012 | 1 | 0.82 | 87 | 31.75 | 2012 | 2 | 1.59 |
| 32 | 134.4 | 129.6 | 90 | 31.75 | 2012 | 1 | 0.87 | | | | | |
| 37 | | | | | | | | 0A | 0A | 2012 | 2 | 2.85 |
| 38 | 158.6 | 153.8 | 90 | 31.75 | 2012 | 1 | 1.23 | 100 | 32 | 2012 | 2 | 3.18 |
| 45 | 188.6 | 182.1 | 100 | 31.75 | 2012 | 1 | 1.46 | | | | | |
| 48 | 200.7 | 194.2 | 100 | 31.75 | 2012 | 1 | 1.55 | | | | | |
| 57 | 233.1 | 230.5 | 110 | 31.75 | 2012 | 1 | 2.60 | 110 | 31.75 | 2012 | 2 | 7.56 |
| 76 | 313.9 | 307.3 | 110 | 31.75 | 2012 | 1 | 4.27 | 110 | 31.75 | 2012 | 2 | 15.26 |
| 95 | 390.7 | 384.1 | 110 | 31.75 | 2012 | 1 | 6.88 | 110 | 31.75 | 2012 | 2 | 19.08 |
| 114 | 467.4 | 460.9 | 110 | 44.45 | 2517 | 1 | 10.44 | 0A | 0A | 2517 | 2 | 22.90 |

British Standard Taper Locks

12B-1-2-3 Taper Lock

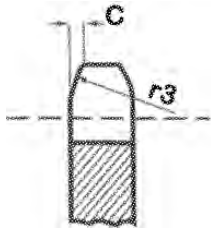

| Teeth | de | dp | dm | A | Bush | Type | App. Kg | dm | A | Bush | Type | App. Kg | dm | A | Bush | Type | App. Kg | | |
|-----------------|-------|-------|-------|-------|------|-------|---------|-----|-------|------|-------|---------|----|-------|------|-------|---------|---|----|
| 13 | 87.8 | 79.59 | 60 | 25.40 | 1210 | 1 | 0.41 | | | | | | | | | | | | |
| 14 | 93.6 | 85.61 | 70 | 25.40 | 1610 | 1 | 0A | | | | | | | | | | | | |
| 15 | 99.8 | 91.63 | 70 | 25.40 | 1610 | 1 | 0.54 | - | 30.10 | 1610 | 0A | 0.90 | - | 49.8 | 1615 | 5 | 0A | | |
| 16 | 105.5 | 97.65 | 75 | 25.40 | 1610 | 1 | 0A | - | 30.10 | 1610 | 0A | 0A | | | | | | | |
| 17 | 111.9 | 103.7 | 76 | 25.40 | 1610 | 1 | 0.82 | - | 30.10 | 1610 | 0A | 1.25 | - | 49.8 | 1615 | 5 | 0A | | |
| 18 | 117.9 | 109.7 | 90 | 31.75 | 2012 | 1 | 0.91 | 90 | 31.75 | 2012 | 0A | 0A | | | | | | | |
| 19 | 123.9 | 115.8 | 90 | 31.75 | 2012 | 1 | 1.00 | 90 | 31.75 | 2012 | 0A | 1.81 | - | 49.8 | 2012 | 5 | 0A | | |
| 20 | 130 | 121.8 | 90 | 44.45 | 2517 | 1 | 1.00 | 108 | 44.45 | 2517 | 0A | 0A | | | | | | | |
| 21 | 136 | 127.8 | 102 | 44.45 | 2517 | 1 | 1.18 | 108 | 44.45 | 2517 | 0A | 2.50 | - | 49.8 | 2517 | 5 | 0A | | |
| 22 | 142 | 133.9 | 102 | 44.45 | 2517 | 1 | 1.27 | 108 | 44.45 | 2517 | 0A | 0A | | | | | | | |
| Pinions | mm | 23 | 148.1 | 139.9 | 108 | 44.45 | 2517 | 1 | 1.37 | 108 | 44.45 | 2517 | 0A | 3.07 | - | 49.8 | 2517 | 5 | 0A |
| Tooth Radius r3 | | 24 | 154.1 | 145.9 | 108 | 44.45 | 2517 | 1 | 1.50 | 108 | 44.45 | 2517 | 0A | 0A | | | | | |
| Radius Width C | | 25 | 160.2 | 152 | 108 | 44.45 | 2517 | 1 | 1.74 | 108 | 44.45 | 2517 | 0A | 3.63 | - | 49.8 | 2417 | 5 | 0A |
| Tooth Width B1 | 11.1 | 26 | 165.9 | 158 | 108 | 44.45 | 2517 | 1 | 0A | 108 | 44.45 | 2517 | 0A | 0A | | | | | |
| | | 27 | 172.3 | 164.1 | 108 | 44.45 | 2517 | 1 | 1.80 | 108 | 44.45 | 2517 | 0A | 4.20 | 140 | 50.80 | 3020 | 4 | 0A |
| Chain | mm | 28 | 178 | 170 | 108 | 44.45 | 2517 | 1 | 0A | 108 | 44.45 | 2517 | 0A | 0A | | | | | |
| Pitch | 19.05 | 29 | 0A | 0A | 0A | 0A | 0A | 0A | 0A | 0A | 0A | 0A | 0A | | | | | | |
| Inside | 11.68 | 30 | 190.4 | 182.3 | 108 | 44.45 | 2517 | 1 | 2.32 | 140 | 50.80 | 3020 | 0A | 5.04 | 140 | 50.80 | 3020 | 4 | 0A |
| Roller ø | 12.07 | 32 | 202.5 | 194.4 | 108 | 44.45 | 2517 | 1 | 2.48 | | | | | | | | | | |
| | | 34 | 0A | 0A | 0A | 0A | 0A | 0A | 0A | | | | | | | | | | |
| | | 38 | 238.9 | 230.1 | 108 | 44.45 | 2517 | 1 | 3.36 | 140 | 50.80 | 3020 | 0A | 8.40 | 140 | 50.80 | 3020 | 4 | 0A |
| | | 45 | 283.2 | 273.1 | 108 | 44.45 | 2517 | 1 | 3.98 | | | | | | | | | | |
| | | 57 | 355.9 | 345.8 | 124 | 44.45 | 2517 | 1 | 8.76 | 0A | 50.80 | 3020 | 0A | 19.48 | 160 | 50.80 | 3020 | 4 | 0A |
| | | 76 | 471.1 | 461 | 124 | 44.45 | 2517 | 1 | 11.68 | 0A | 50.80 | 3020 | 0A | 29.52 | 160 | 50.80 | 3020 | 4 | 0A |
| | | 95 | 586.2 | 576.2 | 0A | 44.45 | 2517 | 1 | 14.60 | 0A | 50.80 | 3020 | 0A | 34.40 | | | | | |
| | | 114 | 701.4 | 691.4 | 0A | 44.45 | 3020 | 1 | 17.52 | 0A | 76.20 | 3030 | 0A | 39.28 | | | | | |

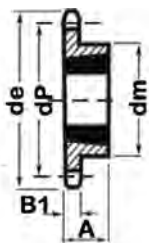

Type 1

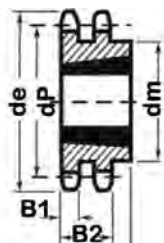

Type 2

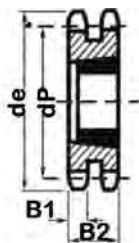

Type 3

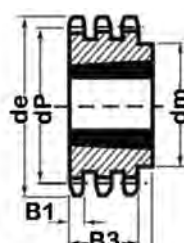

Type 4

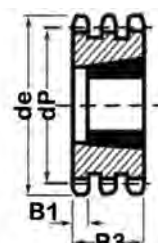

Type 5

British Standard Taper Locks

“Why compete against your supplier when you can be our partner”

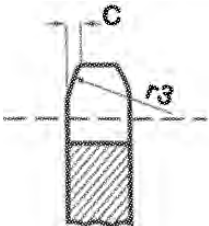
| 16B-1-2-3 Taper Lock | | Teeth | de | dp | dm | A | Bush | Type | App. Kg | dm | A | Bush | Type | App. Kg | dm | A | Bush | Type | App. Kg | | |
|---|-------|-------|-------|-------|-----|-------|------|------|---------|-----|----------------|---------------|------|---------|-----|------|------|------|---------|--|--|
|  | | 13 | 117.7 | 106.1 | 73 | 38.10 | 1615 | 1 | 1.27 | | | | | | | | | | | | |
| | | 14 | 125 | 114 | 76 | 38.10 | 1610 | OA | OA | | | | | | | | | | | | |
| | | 15 | 133.7 | 122.2 | 76 | 38.10 | 1615 | 1 | 1.45 | - | 47.7 | 2012 | OA | 2.04 | - | OA | 2012 | OA | OA | | |
| | | 16 | 141.8 | 130.2 | 76 | 38.10 | 2012 | 1 | 1.55 | - | 47.7 | 2517 | OA | OA | | | | | | | |
| | | 17 | 149.8 | 138.2 | 90 | 32 | 2012 | 1 | 1.69 | - | 47.7 | 2517 | OA | 2.50 | - | 79.6 | 2517 | OA | OA | | |
| | | 18 | 157.8 | 146.3 | 108 | 44.45 | 2517 | 1 | 1.46 | - | 47.7 | 2517 | OA | OA | | | | | | | |
| | | 19 | 165.9 | 154.4 | 108 | 44.45 | 2517 | 1 | 2.14 | - | 47.7 | 2517 | OA | 3.18 | - | 79.6 | 3030 | OA | OA | | |
| | | 20 | 173.9 | 162.4 | 108 | 44.45 | 2517 | 1 | 2.72 | - | 47.7 | 2517 | OA | OA | | | | | | | |
| | | 21 | 182 | 170.4 | 110 | 44.45 | 2517 | 1 | 2.95 | 140 | 50.80 | 3020 | OA | 2.95 | - | 79.6 | 3030 | OA | OA | | |
| Pinions | mm | 22 | 190.1 | 178.5 | 110 | 44.45 | 2517 | 1 | 3.18 | 140 | 50.80 | 3020 | OA | OA | | | | | | | |
| Tooth Radius r3 | | 23 | 198.1 | 186.5 | 110 | 44.45 | 2517 | 1 | 3.40 | 140 | 50.80 | 3020 | OA | 5.48 | 159 | 89 | 3535 | OA | OA | | |
| Radius Width C | | 24 | 206.2 | 194.6 | 110 | 44.45 | 2517 | 1 | 3.63 | 140 | 50.80 | 3020 | OA | OA | | | | | | | |
| Tooth Width B1 | 16.2 | 25 | 214.2 | 202.7 | 110 | 44.45 | 2517 | 1 | 3.90 | 140 | 50.80 | 3020 | OA | 7.72 | 175 | 89 | 3535 | OA | OA | | |
| | | 26 | 221.6 | 210.7 | 110 | 44.45 | 2517 | OA | OA | 140 | 50.80 | 3020 | OA | OA | | | | | | | |
| Chain | mm | 27 | 230.4 | 218.8 | 110 | 44.45 | 2517 | 1 | 4.31 | 140 | 50.80 | 302 | OA | 10.22 | 175 | 89 | 3535 | OA | OA | | |
| Pitch | 25.4 | 28 | 237.7 | 226.8 | 110 | 44.45 | 2517 | OA | OA | 140 | 50.80 | 3020 | OA | OA | | | | | | | |
| Inside | 17.02 | 29 | OA | OA | OA | OA | 2517 | OA | OA | 140 | 50.80 | 3020 | OA | OA | | | | | | | |
| Roller ø | 15.88 | 30 | 254.6 | 243 | 120 | 44.45 | 2517 | 1 | 5.44 | 140 | 50.80 76.20 | 3020 /3030 | 2 | 11.35 | 175 | 89 | 3535 | OA | OA | | |
| | | 35 | 294.9 | 283.4 | OA | 50.80 | 3020 | 1 | 7.12 | | | | | | | | | | | | |
| | | 38 | 319.2 | 307.6 | 160 | 50.80 | 3020 | 1 | 8.85 | 160 | 76.20 | 3030 | 2 | 21.79 | 178 | 89 | 3535 | OA | OA | | |
| | | 45 | 377.9 | 364.1 | OA | 50.80 | 3020 | 1 | 12.25 | | | | | | | | | | | | |
| | | 57 | 474.9 | 461.1 | OA | 50.80 | 3020 | 1 | 19.16 | | 86.90 | 3535 | 2 | 27.24 | 216 | 102 | 4040 | OA | OA | | |
| | | 76* | 628.4 | 614.7 | OA | 50.80 | 3020 | 1 | 28.55 | | 86.90 | 3535 | 2 | 37.68 | 216 | 102 | 4040 | OA | OA | | |
| | | 95 | 782 | 768.2 | OA | 50.80 | 3020 | OA | 41.58 | | | | | | | | | | | | |
| | | 114 | 935.6 | 921.8 | OA | 50.80 | 3020 | OA | 56.15 | | | | | | | | | | | | |

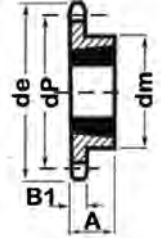
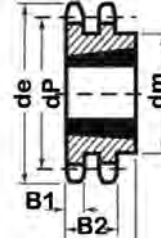
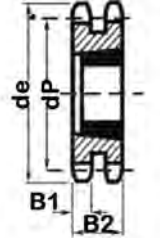
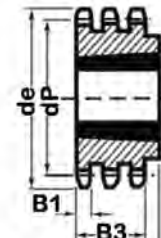
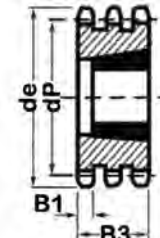
| | | | | |
|--|--|--|---|--|
|  <p>Type 1</p> |  <p>Type 2</p> |  <p>Type 3</p> |  <p>Type 4</p> |  <p>Type 5</p> |
|--|--|--|---|--|

British Standard Plate Wheels

06A-1 Plate Wheel

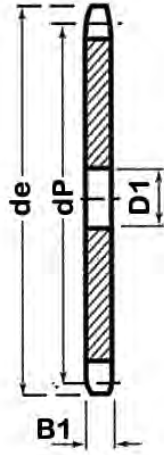
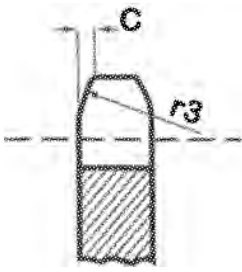

| Pinions | | mm |
|-----------------|--|-------|
| Tooth Radius r3 | | |
| Radius Width C | | |
| Tooth Width B1 | | 5.3 |
| Chain | | mm |
| Pitch | | 9.525 |
| Inside | | 5.72 |
| Roller ø | | 6.35 |

| Teeth | de | dp | D1 | App. Kg |
|-------|-------|-------|----|---------|
| 11 | 37.5 | 33.8 | 8 | 0.05 |
| 12 | 40.5 | 36.8 | 8 | 0.05 |
| 13 | 43.5 | 39.8 | 8 | 0.05 |
| 14 | 46.5 | 42.8 | 8 | 0.06 |
| 15 | 49.5 | 45.81 | 8 | 0.07 |
| 16 | 52.5 | 48.82 | 10 | 0.08 |
| 17 | 55.5 | 51.83 | 10 | 0.10 |
| 18 | 58.6 | 54.85 | 10 | 0.11 |
| 19 | 61.6 | 57.87 | 10 | 0.12 |
| 20 | 64.6 | 60.89 | 10 | 0.13 |
| 21 | 67.6 | 63.91 | 12 | 0.14 |
| 22 | 70.6 | 66.93 | 12 | 0.15 |
| 23 | 73.7 | 69.95 | 12 | 0.17 |
| 24 | 76.7 | 72.97 | 12 | 0.19 |
| 25 | 79.7 | 76 | 12 | 0.20 |
| 26 | 82.7 | 79.02 | 12 | 0.21 |
| 27 | 85.7 | 82.04 | 12 | 0.22 |
| 28 | 88.8 | 85.07 | 12 | 0.23 |
| 29 | 91.8 | 88.09 | 12 | 0.25 |
| 30 | 94.8 | 91.12 | 12 | 0.27 |
| 31 | 97.9 | 94.15 | 14 | 0.22 |
| 32 | 100.9 | 97.17 | 14 | 0.24 |
| 33 | 103.9 | 100.2 | 14 | 0.25 |
| 34 | 106.9 | 103.2 | 14 | 0.26 |
| 35 | 110 | 106.3 | 14 | 0.27 |
| 36 | 113 | 109.3 | 16 | 0.28 |
| 37 | 116 | 112.3 | 16 | 0.35 |
| 38 | 119 | 115.3 | 16 | 0.43 |
| 39 | 112.1 | 118.4 | 16 | 0.44 |
| 40 | 125.1 | 121.4 | 16 | 0.45 |
| 45 | 118.6 | 114.7 | 16 | 0.51 |
| 57 | 149.3 | 145.2 | 20 | 0.86 |

British Standard Plate Wheels

“Why compete against your supplier when you can be our partner”

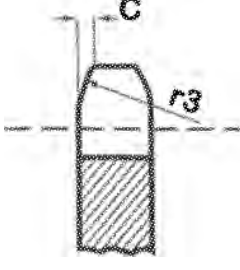
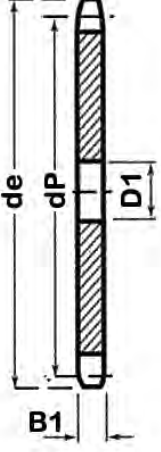
| 08A-1 Plate Wheel | | Teeth | de | dp | D1 | App. Kg | | | | | | | | |
|--|------|---------|-------|-----------------|------|----------------|------|----------------|------|----|------|-------|----|------|
|  | | 10 | 43 | | 8 | 0A | | | | | | | | |
| | | 11 | 49.9 | 45.07 | 10 | 0.06 | | | | | | | | |
|  | | 12 | 53.9 | 49.07 | 10 | 0.08 | | | | | | | | |
| | | 13 | 57.9 | 53.06 | 10 | 0.10 | | | | | | | | |
| <table border="1"> <thead> <tr> <th>Pinions</th> <th>mm</th> </tr> </thead> <tbody> <tr> <td>Tooth Radius r3</td> <td></td> </tr> <tr> <td>Radius Width C</td> <td></td> </tr> <tr> <td>Tooth Width B1</td> <td>7.2</td> </tr> </tbody> </table> | | Pinions | mm | Tooth Radius r3 | | Radius Width C | | Tooth Width B1 | 7.2 | 14 | 61.9 | 57.07 | 10 | 0.12 |
| Pinions | mm | | | | | | | | | | | | | |
| Tooth Radius r3 | | | | | | | | | | | | | | |
| Radius Width C | | | | | | | | | | | | | | |
| Tooth Width B1 | 7.2 | | | | | | | | | | | | | |
| <table border="1"> <thead> <tr> <th>Chain</th> <th>mm</th> </tr> </thead> <tbody> <tr> <td>Pitch</td> <td>12.7</td> </tr> <tr> <td>Inside</td> <td>7.75</td> </tr> <tr> <td>Roller ø</td> <td>8.51</td> </tr> </tbody> </table> | | Chain | mm | Pitch | 12.7 | Inside | 7.75 | Roller ø | 8.51 | 15 | 65.9 | 61.09 | 10 | 0.14 |
| Chain | mm | | | | | | | | | | | | | |
| Pitch | 12.7 | | | | | | | | | | | | | |
| Inside | 7.75 | | | | | | | | | | | | | |
| Roller ø | 8.51 | | | | | | | | | | | | | |
| | | 16 | 69.9 | 65.1 | 12 | 0.15 | | | | | | | | |
| | | 17 | 74 | 69.11 | 12 | 0.16 | | | | | | | | |
| | | 18 | 78 | 73.14 | 12 | 0.2 | | | | | | | | |
| | | 19 | 82 | 77.16 | 12 | 0.21 | | | | | | | | |
| | | 20 | 86 | 81.19 | 12 | 0.25 | | | | | | | | |
| | | 21 | 90.1 | 85.22 | 14 | 0.26 | | | | | | | | |
| | | 22 | 94.1 | 89.24 | 14 | 0.30 | | | | | | | | |
| | | 23 | 98.1 | 93.27 | 14 | 0.33 | | | | | | | | |
| | | 24 | 102.1 | 97.29 | 14 | 0.37 | | | | | | | | |
| | | 25 | 106.2 | 101.3 | 14 | 0.40 | | | | | | | | |
| | | 26 | 110.2 | 105.4 | 16 | 0.43 | | | | | | | | |
| | | 27 | 114.2 | 109.4 | 16 | 0.44 | | | | | | | | |
| | | 28 | 118.3 | 113.4 | 16 | 0.50 | | | | | | | | |
| | | 29 | 112.3 | 117.5 | 16 | 0.55 | | | | | | | | |
| | | 30 | 126.3 | 121.5 | 16 | 0.57 | | | | | | | | |
| | | 31 | 130.4 | 125.5 | 16 | 0.64 | | | | | | | | |
| | | 32 | 134.4 | 129.6 | 16 | 0.67 | | | | | | | | |
| | | 33 | 138.4 | 133.6 | 16 | 0.71 | | | | | | | | |
| | | 34 | 142.5 | 137.6 | 16 | 0.74 | | | | | | | | |
| | | 35 | 146.5 | 141.7 | 16 | 0.77 | | | | | | | | |
| | | 36 | 150.6 | 145.7 | 16 | 0.83 | | | | | | | | |
| | | 37 | 154.6 | 149.8 | 16 | 0.87 | | | | | | | | |
| | | 38 | 158.6 | 153.8 | 16 | 0.91 | | | | | | | | |
| | | 39 | 162.7 | 157.8 | 16 | 0.92 | | | | | | | | |
| | | 40 | 166.7 | 161.9 | 16 | 1.01 | | | | | | | | |
| | | 42 | 176.5 | 170 | 20 | 1.13 | | | | | | | | |
| | | 45 | 188.6 | 182.1 | 20 | 1.43 | | | | | | | | |
| | | 48 | 200.7 | 194.2 | 20 | 1.46 | | | | | | | | |
| | | 50 | 208.8 | 202.3 | 20 | 1.80 | | | | | | | | |
| | | 55 | 229 | 222.5 | 20 | 2.10 | | | | | | | | |
| | | 57 | 233.1 | 230.5 | 20 | 2.27 | | | | | | | | |
| | | 60 | 249.2 | 242.7 | 20 | 2.37 | | | | | | | | |
| | | 65 | 269.4 | 262.86 | 25 | 2.17 | | | | | | | | |
| | | 70 | 289.6 | 283.07 | 25 | 3.10 | | | | | | | | |
| | | 76 | 313.9 | 307.3 | 25 | 3.50 | | | | | | | | |

British Standard Plate Wheels

10A-1 Plate Wheel

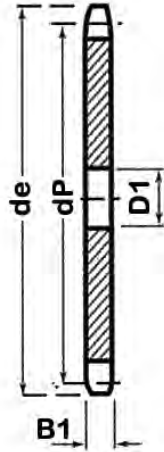
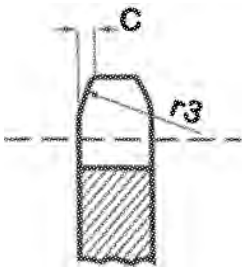

| Pinions | mm |
|----------------------|------|
| Tooth Radius r3 | |
| Radius Width C | |
| Tooth Width B1 | 9.1 |
| | |
| Chain | mm |
| Pitch | 5.88 |
| Inside | 9.65 |
| Roller \varnothing | 10.2 |

| Teeth | de | dp | D1 | App. Kg |
|-------|-------|--------|----|---------|
| 11 | 63.2 | 56.35 | 12 | 0.11 |
| 12 | 68.2 | 61.34 | 12 | 0.15 |
| 13 | 73.2 | 66.32 | 12 | 0.19 |
| 14 | 78.2 | 71.34 | 12 | 0.23 |
| 15 | 83.2 | 76.36 | 12 | 0.25 |
| 16 | 88.3 | 81.37 | 12 | 0.31 |
| 17 | 93.3 | 86.39 | 12 | 0.35 |
| 18 | 98.3 | 91.42 | 14 | 0.39 |
| 19 | 103.3 | 96.45 | 14 | 0.43 |
| 20 | 108.4 | 101.5 | 14 | 0.48 |
| 21 | 113.4 | 106.5 | 16 | 0.51 |
| 22 | 118.4 | 111.6 | 16 | 0.59 |
| 23 | 123.5 | 116.6 | 16 | 0.65 |
| 24 | 128.5 | 121.6 | 16 | 0.68 |
| 25 | 133.6 | 126.7 | 16 | 0.73 |
| 26 | 138.6 | 131.7 | 20 | 0.78 |
| 27 | 143.6 | 136.8 | 20 | 0.89 |
| 28 | 148.7 | 141.8 | 20 | 0.93 |
| 29 | 153.7 | 146.8 | 20 | 1.07 |
| 30 | 158.8 | 151.9 | 20 | 1.15 |
| 31 | 163.8 | 156.9 | 20 | 1.27 |
| 32 | 168.9 | 162 | 20 | 1.32 |
| 33 | 173.9 | 167 | 20 | 1.42 |
| 34 | 178.9 | 172.1 | 20 | 1.45 |
| 35 | 184 | 177.1 | 20 | 1.51 |
| 36 | 189 | 182.2 | 20 | 1.73 |
| 37 | 194.1 | 187.2 | 20 | 1.81 |
| 38 | 199.1 | 192.2 | 20 | 1.88 |
| 39 | 204.2 | 197.3 | 20 | 2.00 |
| 40 | 209.2 | 202.3 | 20 | 2.02 |
| 42 | 220.8 | 212.4 | 25 | 2.26 |
| 45 | 236 | 227.6 | 25 | 2.69 |
| 48 | 251.1 | 242.7 | 25 | 2.98 |
| 50 | 261.2 | 252.8 | 25 | 3.22 |
| 52 | 270.4 | 262.92 | 20 | 0A |
| 55 | 286.5 | 278.1 | 25 | 3.88 |
| 57 | 296.6 | 288.2 | 25 | 4.25 |
| 60 | 311.7 | 303.3 | 25 | 4.90 |
| 65 | 337.0 | 328.58 | 25 | 5.50 |
| 70 | 362.2 | 353.84 | 25 | 6.35 |
| 72 | 372.3 | 363.95 | 25 | 6.91 |
| 76 | 392.5 | 384.2 | 25 | 9.11 |

British Standard Plate Wheels

"Why compete against your supplier when you can be our partner"

| 12A-1 Plate Wheel | | Teeth | de | dp | D1 | App. Kg |
|-------------------|--|-------|-------|--------|----|---------|
| | | 11 | 75.8 | 67.61 | 16 | 0.36 |
| | | 12 | 81.8 | 73.6 | 16 | 0.42 |
| | | 13 | 87.8 | 79.59 | 16 | 0.48 |
| | | 14 | 93.8 | 85.61 | 16 | 0.54 |
| | | 15 | 99.8 | 91.63 | 16 | 0.60 |
| | | 16 | 105.8 | 97.65 | 16 | 0.68 |
| | | 17 | 111.9 | 103.7 | 16 | 0.77 |
| | | 18 | 117.9 | 109.7 | 16 | 0.85 |
| | | 19 | 123.9 | 115.8 | 16 | 0.95 |
| | | 20 | 130 | 121.8 | 16 | 1.08 |
| | | 21 | 136 | 127.8 | 20 | 1.15 |
| | | 22 | 142 | 133.9 | 20 | 1.24 |
| | | 23 | 148.1 | 139.9 | 20 | 1.33 |
| | | 24 | 154.1 | 145.9 | 20 | 1.47 |
| | | 25 | 160.2 | 152 | 20 | 1.63 |
| | | 26 | 166.2 | 158 | 20 | 1.72 |
| | | 27 | 172.3 | 164.1 | 20 | 1.91 |
| | | 28 | 178.3 | 170.1 | 20 | 1.99 |
| | | 29 | 184.4 | 176.2 | 20 | 2.28 |
| | | 30 | 190.4 | 182.3 | 20 | 2.44 |
| | | 31 | 196.5 | 188.3 | 20 | 2.49 |
| | | 32 | 202.5 | 194.4 | 20 | 2.62 |
| | | 33 | 208.6 | 200.4 | 20 | 2.77 |
| | | 34 | 214.6 | 206.5 | 20 | 2.91 |
| | | 35 | 220.7 | 212.5 | 20 | 3.19 |
| | | 36 | 226.8 | 218.6 | 25 | 3.21 |
| | | 37 | 232.8 | 224.6 | 25 | 3.52 |
| | | 38 | 238.9 | 230.1 | 25 | 3.67 |
| | | 39 | 244.9 | 236.8 | 25 | 3.87 |
| | | 40 | 251 | 242.8 | 25 | 4.00 |
| | | 42 | 265 | 254.9 | 25 | 4.53 |
| | | 45 | 283.2 | 273.1 | 25 | 5.14 |
| | | 48 | 301.4 | 291.3 | 25 | 5.75 |
| | | 50 | 313.5 | 303.4 | 25 | 6.45 |
| | | 55 | 343.8 | 333.7 | 25 | 7.43 |
| | | 57 | 355.9 | 345.8 | 25 | 8.11 |
| | | 60 | 374.1 | 364 | 25 | 9.19 |
| | | 65 | 404.4 | 394.29 | 25 | 10.65 |
| | | 70 | 434.7 | 424.60 | 30 | 12.45 |
| | | 72 | 446.8 | 436.74 | 30 | 13.22 |
| | | 76 | 471.1 | 461 | 30 | 14.78 |

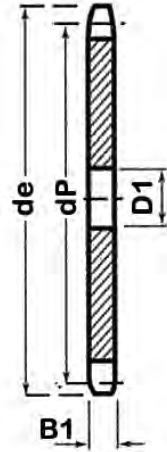
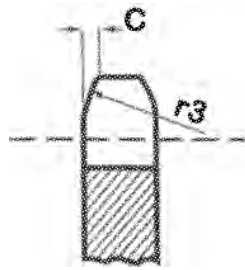

| Pinions | | mm |
|-----------------|--|-------|
| Tooth Radius r3 | | |
| Radius Width C | | |
| Tooth Width B1 | | 11.1 |
| | | |
| Chain | | mm |
| Pitch | | 19.05 |
| Inside | | 11.68 |
| Roller ø | | 12.07 |

British Standard Plate Wheels

16A-1 Plate Wheel

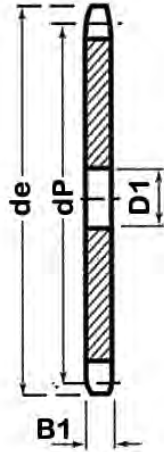
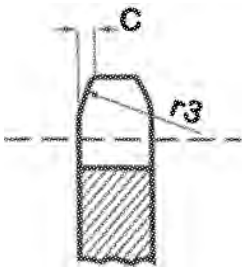

| Pinions | | mm |
|-----------------|--|-------|
| Tooth Radius r3 | | |
| Radius Width C | | |
| Tooth Width B1 | | 16.2 |
| | | |
| Chain | | mm |
| Pitch | | 25.4 |
| Inside | | 17.02 |
| Roller ø | | 15.88 |

| Teeth | de | dp | D1 | App. Kg |
|-------|-------|-------|----|---------|
| 11 | 101.7 | 90.14 | 16 | 0.82 |
| 12 | 109.7 | 98.14 | 16 | 0.91 |
| 13 | 117.7 | 106.1 | 16 | 1.04 |
| 14 | 125.7 | 114.2 | 16 | 1.22 |
| 15 | 133.7 | 122.2 | 16 | 1.36 |
| 16 | 141.8 | 130.2 | 20 | 1.54 |
| 17 | 149.8 | 138.2 | 20 | 1.81 |
| 18 | 157.8 | 146.3 | 20 | 2.00 |
| 19 | 165.9 | 154.4 | 20 | 2.13 |
| 20 | 173.9 | 162.4 | 20 | 2.49 |
| 21 | 182 | 170.4 | 20 | 2.63 |
| 22 | 190.1 | 178.5 | 20 | 2.82 |
| 23 | 198.1 | 186.5 | 20 | 3.04 |
| 24 | 206.2 | 194.6 | 20 | 3.45 |
| 25 | 214.2 | 202.7 | 20 | 3.63 |
| 26 | 222.3 | 210.7 | 20 | 3.90 |
| 27 | 230.4 | 218.8 | 20 | 4.31 |
| 28 | 238.4 | 226.9 | 20 | 4.58 |
| 29 | 246.5 | 234.9 | 20 | 4.81 |
| 30 | 254.6 | 243 | 20 | 5.22 |
| 31 | 262.6 | 251.1 | 25 | 5.56 |
| 32 | 270.7 | 259.1 | 25 | 5.90 |
| 33 | 278.8 | 267.2 | 25 | 6.24 |
| 34 | 286.9 | 275.3 | 25 | 6.58 |
| 35 | 294.9 | 283.4 | 25 | 6.92 |
| 36 | 303 | 291.4 | 25 | 7.26 |
| 37 | 311.1 | 299.5 | 25 | 7.60 |
| 38 | 319.2 | 307.6 | 25 | 7.94 |
| 39 | 327.2 | 315.7 | 25 | 8.48 |
| 40 | 335.3 | 323.4 | 25 | 9.01 |
| 45 | 377.9 | 364.1 | 25 | 11.70 |
| 57 | 474.9 | 461.1 | 30 | 18.14 |

Weld Fit Welded Hubs and Sprockets

“Why compete against your supplier when you can be our partner”

| Welded Hubs For use with Welded Sprockets | VT Series Hub | | WT Series Hub | | XT Series Hub | |
|--|------------------|----------|------------------|----------|------------------|----------|
| | For VT sprockets | | For WT sprockets | | For XT sprockets | |
| A | 34mm | (1-5/16) | 45mm | (1-3/4) | 62mm | (2-7/16) |
| B | 30mm | (1-3/16) | 41mm | (1-5/8) | 57mm | (2-1/4) |
| C | 12mm | (1/2) | 12mm | (1/2) | 12mm | (1/2) |
| D | 30mm | (1-3/16) | 37mm | (1-7/16) | 37mm | (1-7/16) |

| BORE | | | | | | |
|------|----|-------|----|-------|-------|--|
| Inch | mm | Inch | mm | Inch | mm | |
| 1/2 | 12 | 1/2 | 12 | 1/2 | 12 | |
| | 14 | | 14 | | 14 | |
| 5/8 | 15 | 5/8 | 15 | 5/8 | 15 | |
| | 16 | | 16 | | 16 | |
| 3/4 | 18 | 3/4 | 18 | 3/4 | 18 | |
| | 19 | | 19 | | 19 | |
| 7/8 | 20 | 7/8 | 20 | 7/8 | 20 | |
| | 22 | | 22 | | 22 | |
| | | 1 | 24 | 1 | 24 | |
| | | | 25 | | 25 | |
| | | 1-1/8 | 28 | 1-1/8 | 28 | |
| | | | 30 | | 30 | |
| | | 1-1/4 | 32 | 1-1/4 | 32 | |
| | | | | | 35 | |
| | | | | | 38 | |
| | | | | | 40 | |
| | | | | | 42 | |
| | | | | | 45 | |
| | | | | | 1-3/4 | |

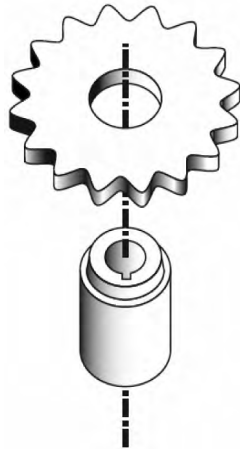

Welded Hubs and Sprockets

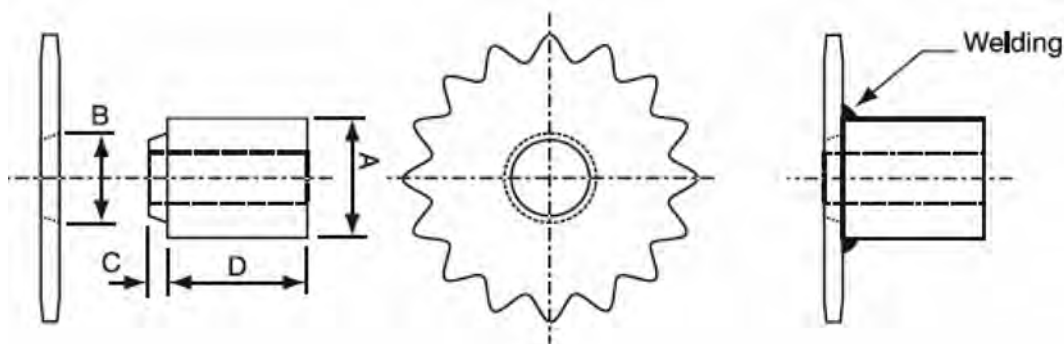

Notes

- 1) Welding with low hydrogen electrodes is recommended
- 2) Keyways conform to BS 46 (imperial) and BS 4235 (metric)

Weld Fit Welded Hubs and Sprockets

ANSI & BS Palte Wheel Sprockets

with prepared Taper bore to receive welded hubs

| No. of Teeth | 08B1 1/2" Pitch | ANSI-40 1/2" Pitch | ANSI-50 BS 10B 5/8" Pitch | ANSI-60 BS 12B 3/4" Pitch | ANSI-80 BS 16B 1" Pitch |
|--------------|--------------------|-----------------------|---------------------------------|---------------------------------|-------------------------------|
| 12 | 08V12HT | 40VT12HT | 50WT12HT | 60WT12HT | 80XT12HT |
| 13 | 08V13HT | 40VT13HT | 50WT13HT | 60WT13HT | 80XT13HT |
| 14 | 08V14HT | 40VT14HT | 50WT14HT | 60WT14HT | 80XT14HT |
| 15 | 08V15HT | 40VT15HT | 50WT15HT | 60XT15HT | 80XT15HT |
| 16 | 08WT16HT | 40WT16HT | 50WT16HT | 60XT16HT | 80XT16HT |
| 17 | 08WT17HT | 40WT17HT | 50XT17HT | 60XT17HT | 80XT17HT |
| 18 | 08WT18HT | 40WT18HT | 50XT18HT | 60XT18HT | 80XT18HT |
| 19 | 08WT19HT | 40WT19HT | 50XT19HT | 60XT19HT | 80XT19HT |
| 20 | 08XT20HT | 40XT20HT | 50XT20HT | 60XT20HT | 80XT20HT |
| 21 | 08XT21HT | 40XT21HT | 50XT21HT | 60XT21HT | 80XT21HT |
| 22 | 08XT22HT | 40XT22HT | 50XT22HT | 60XT22HT | 80XT22HT |
| 23 | 08XT23HT | 40XT23HT | 50XT23HT | 60XT23HT | 80XT23HT |
| 24 | 08XT24HT | 40XT24HT | 50XT24HT | 60XT24HT | 80XT24HT |
| 25 | 08XT25HT | 40XT25HT | 50XT25HT | 60XT25HT | 80XT25HT |
| 26 | 08XT26HT | 40XT26HT | 50XT26HT | 60XT26HT | 80XT26HT |
| 27 | 08XT27HT | 40XT27HT | 50XT27HT | 60XT27HT | 80XT27HT |
| 28 | 08XT28HT | 40XT28HT | 50XT28HT | 60XT28HT | 80XT28HT |
| 29 | 08XT29HT | 40XT29HT | 50XT29HT | 60XT29HT | 80XT29HT |
| 30 | 08XT30HT | 40XT30HT | 50XT30HT | 60XT30HT | 80XT30HT |
| 32 | 08XT32HT | 40XT32HT | 50XT32HT | 60XT32HT | 80XT32HT |
| 34 | 08XT34HT | 40XT34HT | 50XT34HT | 60XT34HT | 80XT34HT |
| 36 | 08XT36HT | 40XT36HT | 50XT36HT | 60XT36HT | 80XT36HT |
| 38 | 08XT38HT | 40XT38HT | 50XT38HT | 60XT38HT | 80XT38HT |
| 40 | 08XT40HT | 40XT40HT | 50XT40HT | 60XT40HT | 80XT40HT |
| 45 | 08XT45HT | 40XT45 | 50XT45HT | 60XT45HT | 80XT45HT |
| 57 | 08XT57HT | 40XT57 | 50XT57 HT | 60XT57HT | 80XT57HT |
| 76 | 08XT76HT | 40XT76HT | 50XT76HT | 60XT76HT | 80XT76HT |