



PRODUCT DATA

Drop-In Setting Tool

Page 1 of 2

Drop-in anchor setting tool ensures the correct setting of the selected drop-in anchor. It is critical that installers use the correct setting tool with the correct size drop-in anchor.

Applications	Trades
<ul style="list-style-type: none"> Setting of selected size drop-in anchor 	<ul style="list-style-type: none"> Installation of mechanical services Plumbers Electricians HVAC Installers Ceiling and partitioning contractors

Material	 Carbon Steel
----------	--

Finish	 Zinc Plated (RoHS Compliant)	
--------	--	---

Part	QFind	Size	Length	Shoulder Diameter	Stepped Point	Diameter Stepped Point
			L (mm)	D (mm)	T (mm)	DT (mm)
MATMSZM060175	MAT102	M6	175	8	15	4.7
MATMSZM080178	MAT103	M8	178	10	18	6.4
MATMSZM100177	MAT104	M10	177	12	17	8.4
MATMSZM100185	MAT105	M10	185	12	25	8.4
MATMSZM120190	MAT106	M12	190	15	30	10.1
MATMSZM160200	MAT107	M16	200	20	40	13.2
MATMSZM200212	MAT108	M20	212	25	52	16.9

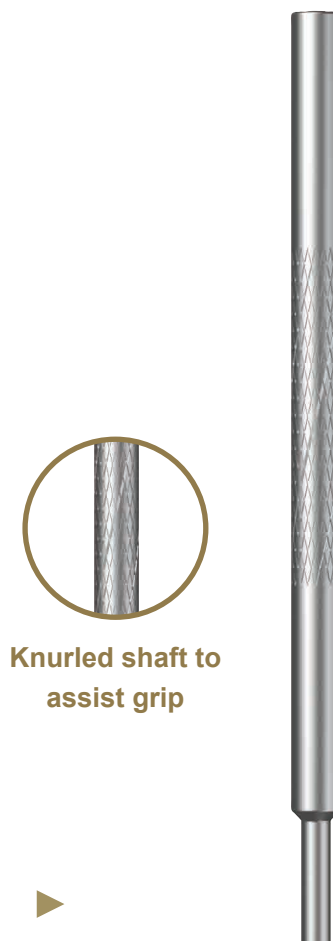

Knurled shaft to assist grip

Features

- Hardened steel
- Specified length point to allow for the correct setting and installation of the selected drop-in anchor

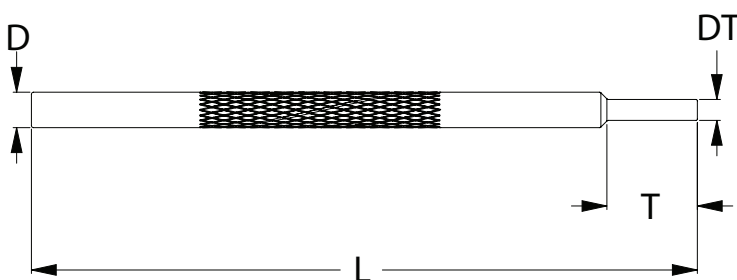

	Features Shoulder and stepped point
---	---

Disclaimer: While every reasonable effort has been made to ensure that this document is correct at the time of printing, Hobson Engineering, its agencies and employees, disclaim any and all liability to any person in respect of anything or the consequences of anything done or omitted to be done in reliance upon the whole or any part of this document.

Bolt Tension | Anti-Vibration | Product Reliability | Traceability

hobson.com.au **QUALITY FASTENERS SINCE 1935**

PRODUCT DATA



Drop-In Setting Tool

Page 2 of 2

Installation

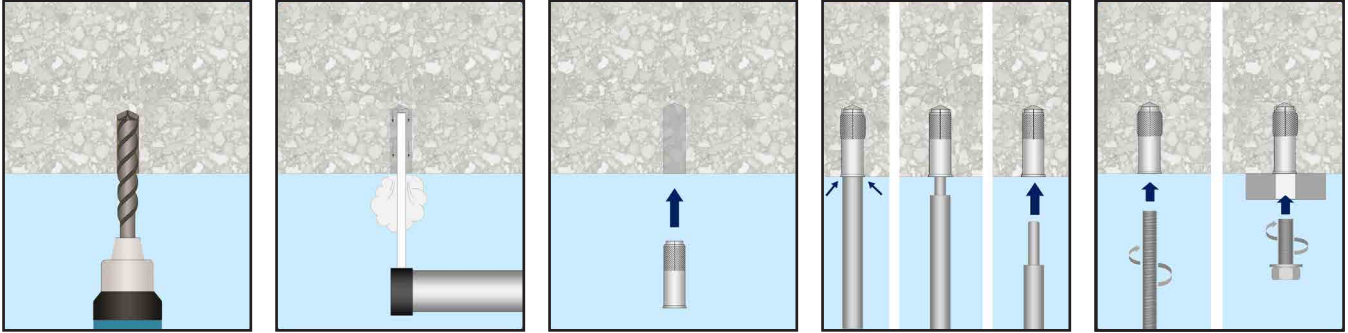

Installation Guides

1. Drill hole to required diameter and depth.
2. Clean hole with brush and hand pump, vacuum or compressed air.
3. Insert the anchor into the hole.
4. Hammer the insertion tool into the anchor driving the expansion plug down. Stop hammering when the shoulder of the tool contacts the top of the anchor.
5. Screw in threaded rod or bolt and tighten with spanner.

Disclaimer: While every reasonable effort has been made to ensure that this document is correct at the time of printing, Hobson Engineering, its agencies and employees, disclaim any and all liability to any person in respect of anything or the consequences of anything done or omitted to be done in reliance upon the whole or any part of this document.

Bolt Tension | Anti-Vibration | Product Reliability | Traceability

hobson.com.au **QUALITY FASTENERS** SINCE 1935



200320DS