



MATERIAL HANDLING & HOISTING EQUIPMENT

LIFTING YOUR BUSINESS TO A HIGHER LEVEL

AUSTRALIAN LIFTING CENTRE PTY LTD

1300 100 120

www.austlift.com.au



Material Handling & Hoisting Equipment

Load Cell	52
Chain Block (W4, W5 Series)	53
Low Headroom Chain Block (W6 Series)	55
Lever Block (L3 Series)	56
Webbing Snatch Block	56
Dynoblock 360°, Dock Scissor Lift	57
Sheave Wheel, Off Road Block, Sheave Block	58
Heavy Duty Snatch Block	59
Permanent Magnetic Lifter	60
Wire Rope Winch & Instructions	61
Drum Lifter	62
Girder Clamp, Girder Trolley with Clamp	63
Plate Clamp (Universal, Horizontal)	64
Girder Trolley, Geared Trolley	65
Aussie Fetch	66
Container Ramp, Forklift Extension	67
Forklift Safe Cage	68
Foot Pad, Hand Trolley, Pallet Jack	68
W4 & W5 Chain Block Spare Parts	69
Wire Rope Winch/Hoist Spare Parts	70
Magnetic Lifter Spare Parts	70
Level Block Spare Parts	71
Snatch Block & Sheave Block Spare Parts	73
Plate Clamps Spare Parts	74
Girder Trolley with Clamp Spare Parts	76

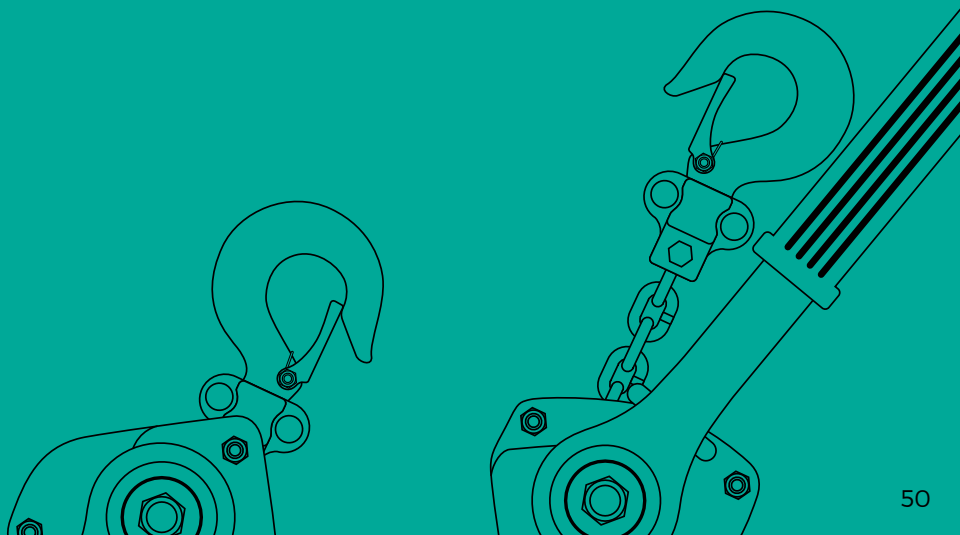



Material Handling & Hoisting Equipment

Austlift material handling and hoisting equipment are all tested in accordance and meet the relevant Australian Standard for each product.

With years of extensive knowledge and years of experience in this sector Austlift products continue to develop and new ranges are becoming available as technology improves.



Full Member

Load Cell

Austlift shackle link load cells are used for measuring the accurate weight of an object to be lifted or tensioned. Mainly used for the crane, rigging industry, test laboratories and also research and development facilities.

- Robust construction and large digital display with back light feature.
- Capacities available from 1t to 200t with accuracy of 0.1%.
- Have a reading of 200-300 times per second.
- Capable of measuring loads in pounds, tonnes and kilogram units.
- Battery operated with low battery and overload warning feature.
- All load cells come with two shackles and remote in heavy duty carry case.

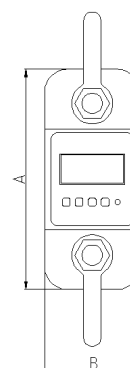

WLL (T)	PRODUCT CODE	UNIT Wt. (kg)	Wt. WITH SHACKLE (Kg)	Min. WEIGHT (kg)	TOTAL DISPLAY COUNTS (N)
1	160001	1.6	3.1	10	2000
2	160002	1.7	3.2	20	2000
3	160003	2.1	4.6	20	3000
5	160005	2.7	6.3	40	2500
10	160010	10.4	24.8	100	2000
20	160020	17.8	48.6	200	2000
30	160030	25	87	200	3000
50	160050	39	128	400	2500
100	160100	81	321	1000	2000
200	160200	210	776	2000	2000

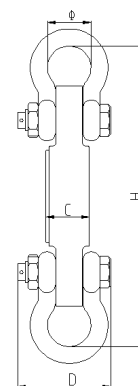

Material Handling Products

WLL (T)	PRODUCT CODE	DIVISION (kg)	DIMENSION						MATERIAL
			A	B	C	D	Ø	H	
1	160001	0.5	245	112	37	190	43	335	Aluminium
2	160002	1	245	116	37	190	43	335	Aluminium
3	160003	1	260	123	37	195	51	365	Aluminium
5	160005	2	285	123	57	210	58	405	Aluminium
10	160010	5	320	120	57	230	92	535	Alloy Steel
20	160020	10	420	128	74	260	127	660	Alloy Steel
30	160030	10	420	138	82	280	146	740	Alloy Steel
50	160050	20	465	150	104	305	184	930	Alloy Steel
100	160100	50	570	190	132	366	229	1230	Alloy Steel
200	160200	100	725	265	183	440	280	1380	Alloy Steel

WARNING

The remote control is not recommended for use in explosive environments. Load cells should not be exposed in heavy moisture conditions for long periods. Aluminium load cell units are not suitable to be used in mine sites.

Chain Block (W4 Series)

Austlift industrial grade W4 series manually operated chain blocks are used for general hoisting operation such as mining, construction, industrial lifting and domestic applications. Other colors and height of lift available upon request. Black color available for 110500, 1T 10M chain block.

- Standard height of lift is 3 and 6 metre. Other height of lift available upon request.
- Manufactured for ease of operation, and light weight in design.
- Robust, durable and compact in construction.
- All blocks come with ball bearing swivel hook.
- Individually serial numbered with test certificate and instruction manual supplied.



Chain Block (W5 Series, with overload protection)

Austlift industrial grade W5 series manually operated chain blocks with overload protection are used for general hoisting operation such as mining, construction, industrial lifting and domestic applications. The overload protection is an added feature on these chain blocks protecting users and the unit itself. Other colors and height of lift available upon request.

- Standard height of lift is 3 and 6 metre. Other height of lift available upon request.
- Manufactured for ease of operation, and light weight in design.
- Robust, durable and compact in construction.
- All blocks come with ball bearing swivel hook.
- Individually serial numbered with test certificate and instruction manual supplied.
- Overload protection for added safety.



WLL (T)	W4 CHAIN BLOCK		W5 CHAIN BLOCK		TEST LOAD (T)	PULLING EFFORT (N)	DIMENSIONS (mm)			
	3M	6M	3M	6M			A	B	C (Min)	D
0.25	110002	-	-	-	0.375	187	120	115	280	21
0.5	110005	110505	-	-	0.75	224	148	133	346	28
1	110010	110510	112010	112110	1.5	281	173	150	376	32
1.5	110015	110515	112015	112115	2.25	290	196	173	442	38
2	110020	110520	112020	112120	3	328	211	176	470	40
3	110025	110525	112025	112125	4.5	307	230	174	560	38
5	110030	110530	-	-	7.5	332	279	201	688	50
10	110035	110535	-	-	12.5	342	463	201	765	64
15	-	110540	-	-	18.75	400	730	189	1090	85
20	110045	110542	-	-	25	435	860	169	1170	85

WLL (T)	W4 CHAIN BLOCK		W5 CHAIN BLOCK		UNIT Wt. (kg)	STD. LIFT (M)	LOAD CHAIN		NO. OF CHAIN FALLS	EXTRA WEIGHT/M EXTRA LIFT (kg)
	3M	6M	3M	6M			SIZE (mm)	CODE		
0.25	110002	-	-	-	7.5	2.5	4	-	1	1.5
0.5	110005	110505	-	-	9.3	2.5	5	003705SP	1	1.6
1	110010	110510	112010	112110	12	2.5	6	003706SP	1	1.8
1.5	110015	110515	112015	112115	17	2.5	7.1	003707SP	1	2.1
2	110020	110520	112020	112120	19.7	2.5	8	003708SP	1	2.4
3	110025	110525	112025	112125	29	3	7.1	003707SP	2	3.1
5	110030	110530	-	-	42.5	3	9	003709SP	2	4.6
10	110035	110535	-	-	73.6	3	10	003710SP	4	9.8
15	-	110540	-	-	155	3	10	003710SP	6	14.1
20	110045	110542	-	-	186.2	3	10	003710SP	8	19.6

Refer to Page 69 for chain block spare parts information.

Chain Block (W4 & W5 Series)

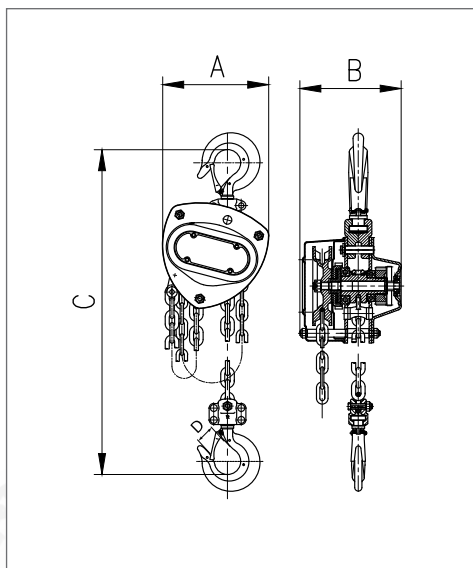

WLL: 0.25T, 0.5T, 1T, 1.5T, 2T

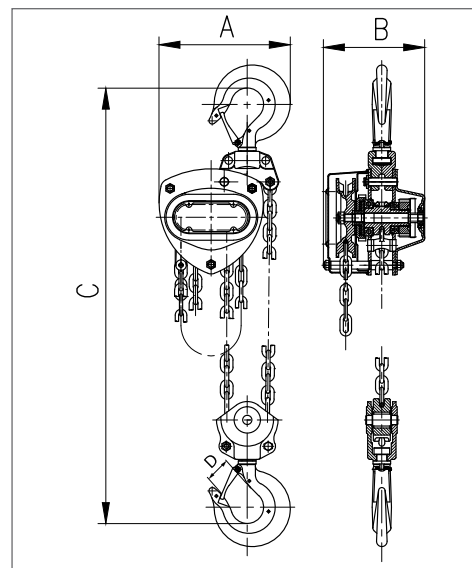

WLL: 3T, 5T

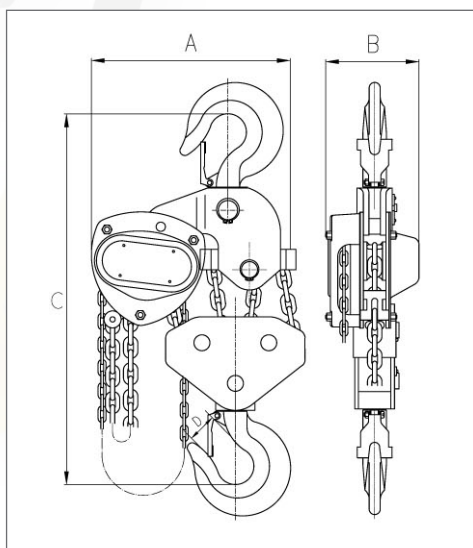

WLL: 10T

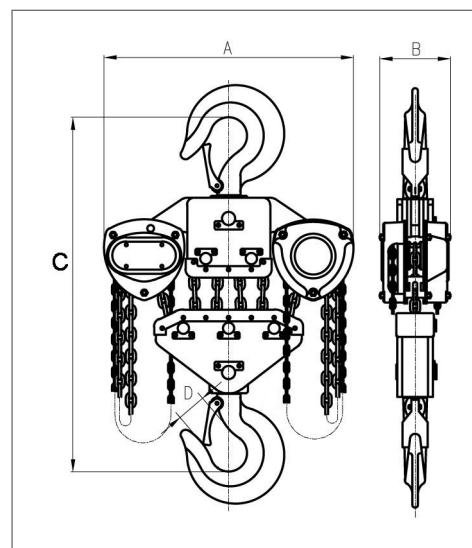

WLL: 15T

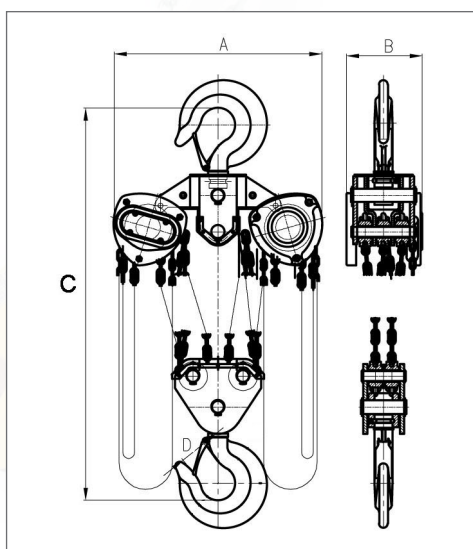

WLL: 20T

Suitable Hand Chain Sizes

003002SP HAND CHAIN SIZES

Inside Length	23.6mm
Outside Length	33.6mm
Inside Width	7.5mm
Outside Width	17.5mm

Low Headroom Chain Block (W6 Series)

Built around the quality chain block hoist with headrooms as low as 4.5 inches, it is ideal for demanding industrial lifting applications where space is extra tight.

- Ultra low-profile lifting & maximum hook travel.
- Permanently attached hand geared trolley.
- Heavy-duty wheels & steel side plates.
- Maintenance-free sealed trolley bearings.
- Adjustable for tapered or flat flanged beams.

AS/NZS
1418.2

Certified

LC From
1-10t

OPERATION

- Hand chain operated.
- Reduced operator fatigue through efficient drive train.

OPERATING CONDITIONS

- Recommended for -20°C to +60°C.

HOOK

- Forged, heat-treated, opens gradually when overloaded.
- Self-closing heavy-duty hook latch.

BEARINGS

- Maintenance-free sealed bearings increase reliability and reduce pull force required to lift loads

HAND CHAIN

- High-quality steel.

LOAD CHAIN

- Heat-treated.
- Low-weight manganese alloy steel.
- High-impact steel chain guide.
- Standard Lift: 6, 8 and 10M.

BRAKE

- Double pawl springs for extremely reliable operation and instant brake activation enclosed to protect from dust, rain and dirt.

GEARS

- Double reduction gearing requiring very low effort to operate.
- Induction heat-treated and case-hardened enclosed to protect from dust and water.

BODY

- Durable all-steel construction.
- Rugged gear case and hand wheel cover.
- Compact design for low headroom and lightweight portability.

OPTIONS

- Chain bag to keep chain clean and out of the way.
- Corrosion resistant chain for tough environments.
- Custom lift chain lengths to suit your requirements.

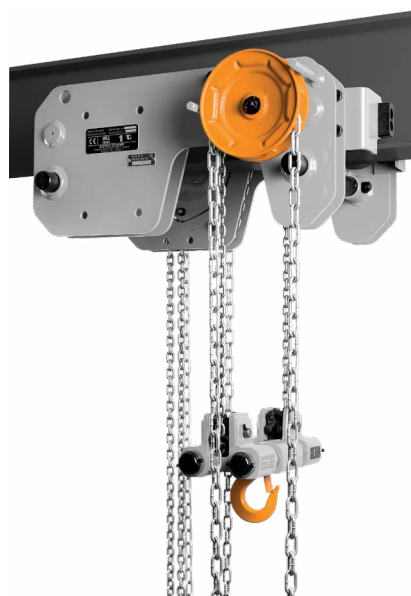

STANDARDS

- Conforms to 1418.2 standards.
- At rated capacity, load-bearing parts are only stressed to 25% of their limit.

CAPACITY

- 1 to 10 metric tonnes.

LOW HEADROOM FEATURES

- Headroom as low as 4.5".
- Built-in trolley with cast wheels, sealed bearings and steel side plates for heavy-duty applications.

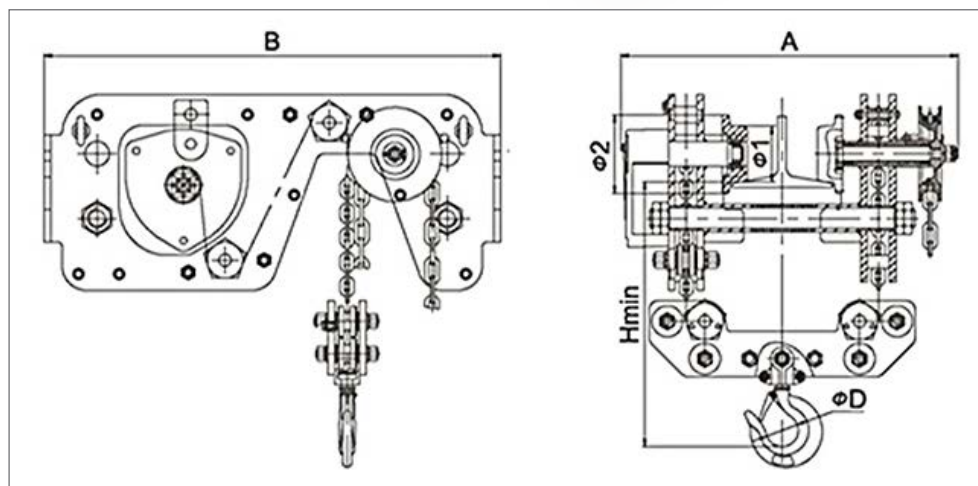

LC (T)	CODE	SPECIFICATIONS					DIMENSIONS (mm)					
		Std. LIFT (M)	Min. TURNING RADIUS (M)	Std. FLANGE (mm)	BODY Wt. (kg)	LOAD CHAIN Dia. (mm)	A	B	H (min)	D	ø 1	ø 2
1	112316	2.5	3.5	75-100-125	61	ø5.0 x 2	440	584	145	40	68	95
2	112326	3	4	100-125-150	95	ø6.0 x 2	515	684	166	50	80	108
3	112336	3	4.5	125-150-175	141	ø7.0 x 2	608	769	198	55	100	131
5	112358	3	5	125-150-175	252	ø10.0 x 2	655	884	265	65	144	131
10	112399	3.5	6	150-175-190	320	ø10.0 x 4	760	1105	310	85	136	176

Lever Block / Come Along (L3 Series)

Austlift L-3 series lever blocks are used for general hoisting in the mining, construction, industrial and domestic situations. Commonly used for short lifts and pulling applications.

- Standard height of lift 1.5 or 3M except for 250kg which has 1 metre lift. Other lift height available upon request.
- Robust, durable, portable and compact in construction.
- All lever blocks come with ball bearing swivel hook.
- Spare parts available refer to page 69.

* Please check operation manual for more details.
* Longer chain lengths are available upon request.

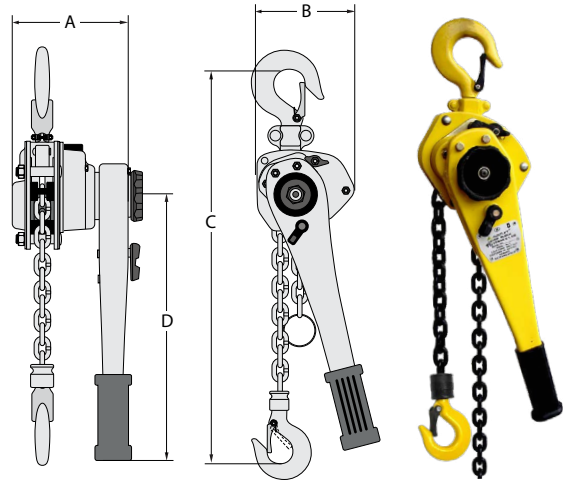

CHAIN SIZE (mm)	CODE	LIFT LENGTH (M)	WLL (T)	TEST LOAD (T)	EFFECTS REQUIRED AT CAPACITY (N)	NT. (kg)	DIMENSION (mm)			
							HEAD ROOM		HOOK TO HOOK	HANDLE
							A	B		
4	121002	1	0.25	0.38	217	1.85	92	75	205	153
5	121005	1.5	0.5	0.75	303	3.5	110	82	260	251
	121305	3								
6	121010	1.5	0.8	1.2	140	7.0	152	128	295	256
	121310	3								
6	121015	1.5	1	1.5	185	7.2	152	128	295	256
	121315	3								
7.1	121020	1.5	1.6	2.4	234	11	175	148	335	368
	121320	3								
	121620	6								
10	121025	1.5	3.2	4.8	363	20	195	181	450	368
	121625	6								
10	121030	1.5	6.3	9.45	370	28	195	232	542	368
	121330	3								
10	121035	1.5	9	13.5	375	43	366	195	645	368
	121335	3								

CHAIN SIZE (mm)	CODE	LIFT LENGTH (M)	WLL (T)	TEST LOAD (T)	EFFECTS REQUIRED AT CAPACITY (N)	NT. (kg)	DIMENSION (mm)			
							HEAD ROOM		HOOK TO HOOK	HANDLE
							A	B		
6	121107	1.5	0.8	1.12	140	7.0	152	128	295	256
6	121111	1.5	1	1.5	185	7.2	152	128	295	256
7.1	121115	1.5	1.6	2.4	234	11	175	148	335	368
10	121130	1.5	3.2	4.8	363	20	195	181	450	368
10	121160	1.5	6.3	9.45	370	28	195	232	542	368
10	121190	1.5	9	13.5	375	43	366	195	645	368

Specially Designed with Overload Protection

Refer to Page 71 for lever block spare parts information.

Webbing Snatch Block

Austlift Webbing Snatch Blocks are specially designed for webbing assembly.

CODE	WLL (kg)	SHEAVE DIA (mm)	WEB DIA. (mm)	UNIT WEIGHT (kg)
139275	750	60	50-56	2.565



AS/NZS 2089



360° operation

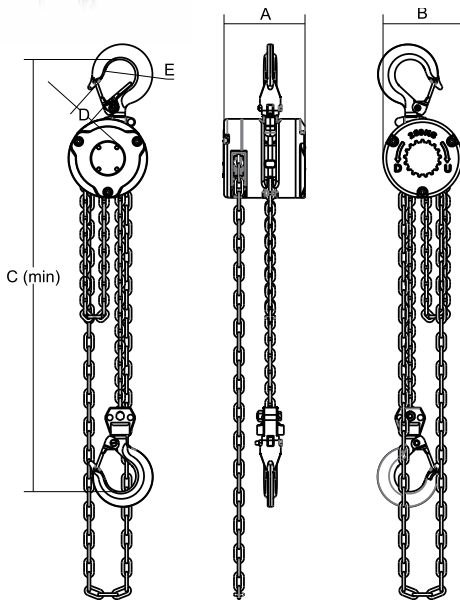

Dynoblock 360° **NEW**

With a compacted design, enclosed body and aluminium construction, the Austlift Dynoblock 360° is very light weight and easy to carry. The Austlift Dynoblock 360° can be used in the home, factory, field construction, agriculture, warehouse and for small equipment installation purposes. It is also widely used in the chemical and marine industries where anti-corrosion equipment is required.

- The unit allows the user to position themselves at any angle around the unit (360°).
- More than 50% lighter than standard chain blocks.
- Double pawl brake system for increased safety.
- Heat-treated flexible hooks if overloaded.
- Galvanised load chain and hand chain for anti-corrosion.
- Water-resistant.

AS/NZS
1418.2

Certified

Instruction
Manual

WLL From
0.25-1t

CODE	WLL (T)	NW. (kg)	LIFT HEIGHT (M)	TEST LOAD (kN)	PULLING EFFORT (N)	CHAIN SIZE (mm)	NO. OF CHAIN FALLS
117025	0.25	2.58	2.5	3.75	160	3.2	1
117050	0.5	3.96	2.5	7.5	200	4	1
117100	1.0	9.5	2.5	15	300	6	1
CODE	ADDED LIFT HEIGHT WEIGHT/M (kg)	DIMENSIONS (mm)					
		A	B	C (min)	D	E	
117025	0.62	88	84	245	21	32	
117050	0.75	101	104	285	22	35	
117100	1.6	138	140	370	27	38	



Dock Scissor Lift **NEW**

The Austlift hydraulic scissor lift will be customised to suit individual workplace requirements that's designed to maximise efficiency and minimise loading time. The lifts can be designed with different table sizes, lifting heights and other safety features that adheres to AS 1418.7.

- **Made to order ONLY.**
- Capacities available from 0.5T to 50T.
- Platform, turntable, control, safety features list available.
- Multiple Descent protection options.
- Designed to AS/NZS ISO 8402.
- Conformed to AS/NZS 1418.7.

AS/NZS
1418.7

Certified

Instruction
Manual

WLL From
0.5-50t

Sheave Wheel

Austlift sheave wheels are available to replace worn/damaged wheels and protect your manila and wire ropes from damage.

DIA. (mm)	CODE		WLL (T)	ROPE (mm)	Wt. (kg)	DIMENSION (mm)			
						A	B	C	E
63	Manila	070063M	0.28	10	0.28	12.5	19.5	10	3.2
	Wire	070063W	0.28	5	0.28	12.5	19.5	10	4.8
75	Manila	070075M	0.32	12	0.32	12.5	20.5	19.5	4.8
	Wire	070075W	0.32	6	0.32	12.5	20.5	19.5	6.4
100	Manila	070100M	0.77	16	0.77	19	24.5	23	6.4
	Wire	070100W	0.77	8	0.77	19	24.5	23	8
125	Manila	070125M	1.4	20	1.4	22	29.5	27	7.1
	Wire	070125W	1.4	10	1.4	22	29.5	27	11
150	Manila	070150M	2.4	24	2.4	25	32	30	8
	Wire	070150W	2.4	12	2.4	25	32	30	12.7
200	Manila	070200M	6.61	32	6.6	35	46	44	11
	Wire	070200W	6.61	16	6.6	35	46	44	16



Manila Rope Sheaves



Wire Rope Sheaves

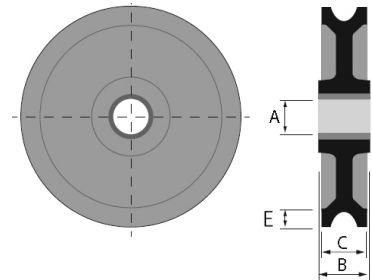

Off Road Block (Comes with Vinyl Bag)

Austlift off road blocks are designed with high grade cast 125mm iron sheaves and fitted with 2 heavy duty steel cover plates. It can be used in most off-road vehicle recovery situations and suitable for use with hand or power operated winches with a rope diameter of 11mm.

- Complete with storage pouch.
- Minimum breaking strength 8,000kg
- Not to be used for lifting.

CODE	SHEAVE SIZE	WIRE ROPE SIZE	MBS (kg)
204395	125mm	11mm	8000



Material Handling Products

Light Duty Sheave Block / Pulley (Hook Type, Hand Operated)

Austlift manually operated sheave blocks are used for general hoisting use such as shipping, mining, general engineering, agriculture and domestic applications.

- Manufactured for ease of operation, lightweight durable and compact design.
- Available in fibre rope and wire rope sheave blocks with 75mm to 150mm sheave diameters also fitted with a bronze bush.
- Test certificate supplied.



DIA. (mm)	FIBRE ROPE		WIRE ROPE		WLL (T)	Wt. (kg)	DIMENSIONS (mm)		
	CODE	ROPE	CODE	ROPE			A	B	C
75	139075F	12	139075W	6	0.25T	1.2	222.4	80	40
100	139100F	16	139100W	8	0.5T	2.2	300.5	108	48.5
125	139125F	20	139125W	10	1T	3.8	346	140	53.5
150	139150F	24	139150W	12	1T	5.2	392	168	60

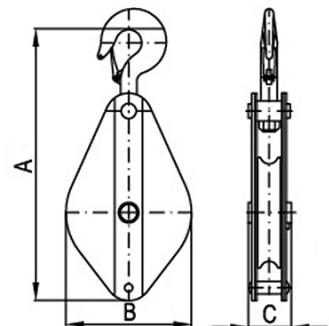

Heavy Duty Snatch Block / Sheave Block (Swivel Shackle Type) **NEW VERSION**

Austlift manually operated snatch blocks are popular in the mining, construction, off shore rigging and heavy duty lifting applications.

- Made from hi-tensile steel body and cast steel sheave.
- Grease nipples fitted with roller bearings (2-50T) and brass bush bearings (2T).
- Blocks come with swivel bow shackle.
- Drop forged, heat treated swivel shackle.



Ball Bearing equipped

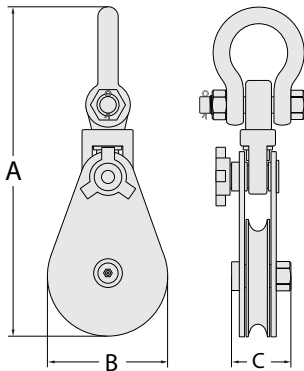

WLL (T)	CODE	SHEAVE DIA (mm)	WIRE ROPE DIA (mm)	UNIT WEIGHT (kg)	DIMENSIONS (mm)		
					A	B	C
2	140102	75	8-9	4	286	82	70
4	140103	115	10-13	6.1	345	120	70
4	140104	152	10-13	13.8	400	160	70
6	140106	152	13-16	15	480	160	94
8	140108	203	16-18	16	530	210	93
10	140110	254	18-20	37.5	680	260	115
12	140112	305	20-22	56	767	310	133
15	140115	305	24-26	65	788	310	133
22	140122	355	28-32	90	952	365	140
30	140130	510	32-36	210	1256	514	162
50	140150	610	44-50	418	1525	625	240

Heavy Duty Snatch Block / Sheave Block (Swivel Hook Type)

Austlift manually operated snatch blocks are popular in the mining, construction, off shore rigging and heavy duty lifting applications.

- Made from hi-tensile steel body and cast steel sheave.



Ball Bearing equipped

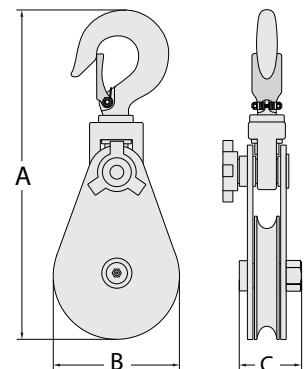

WLL (T)	CODE	SHEAVE DIA (mm)	WIRE ROPE DIA (mm)	UNIT WEIGHT (kg)	DIMENSIONS (mm)		
					A	B	C
4	140504	152	10-13	14	430	160	70
8	140508	203	16-18	16.5	550	210	93

Steel Wire Rope References:

- 6x25Fi+IWRC or 6x36S+IWRC 1770 wire rope is recommended.
- Diameter of the rope can be reduced by using higher tensile rope.
- Check wire rope MBS and load rating of equipment before operation.

Permanent Magnetic Lifter

Austlift permanent magnetic lifter have a wide variety of uses for lifting and shifting steel. This versatile lifting device has the advantage of moving material without damaging the steel surface.

- Capacities available from 100kg to 6000kg.
- No power source required with less than 1% residual magnetism.
- Simple to operate with safety button design.
- Comes with its own test certificate.

 Refer to Page 70 for Magnetic Lifter spare parts information.

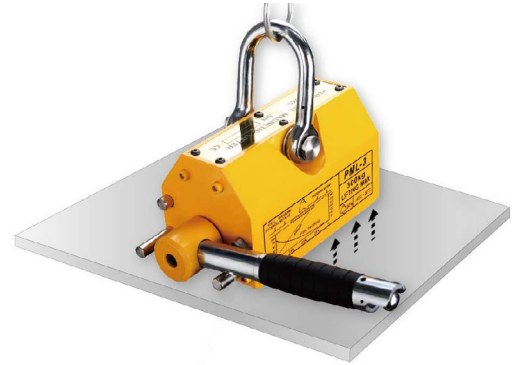

SAFETY CAPACITY DATA FOR THICKNESS

RATED LIFTING STRENGTH (%)	PLATE THICKNESS (mm)								
	100	90	80	70	60	50	40	30	20
100kg	100%	100%	100%	100%	100%	100%	100%	100%	80%
300kg	100%	100%	100%	100%	100%	100%	100%	90%	70%
600kg	100%	100%	100%	100%	100%	100%	90%	70%	50%
1000kg	100%	100%	100%	100%	100%	90%	75%	55%	35%
1500kg	100%	100%	100%	100%	100%	90%	75%	55%	35%
2000kg	100%	100%	100%	100%	80%	60%	45%	30%	20%
3000kg	100%	100%	100%	80%	60%	45%	35%	25%	-
5000kg	100%	85%	70%	55%	45%	35%	25%	-	-
6000kg	100%	85%	70%	55%	45%	35%	25%	-	-

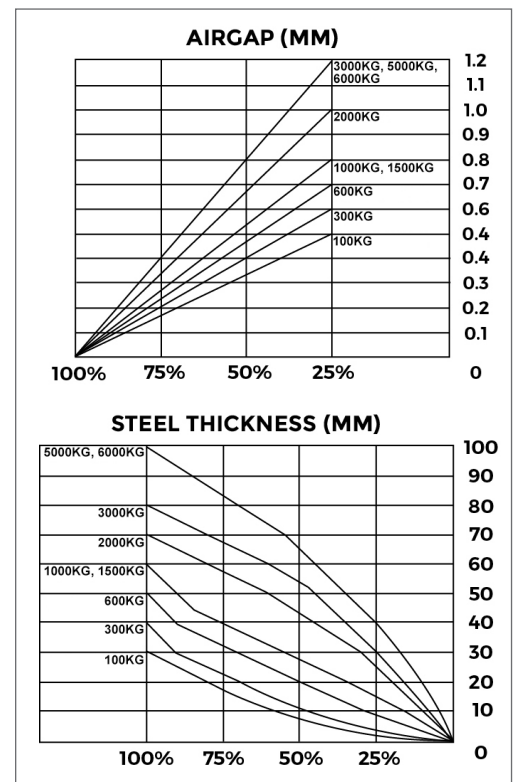
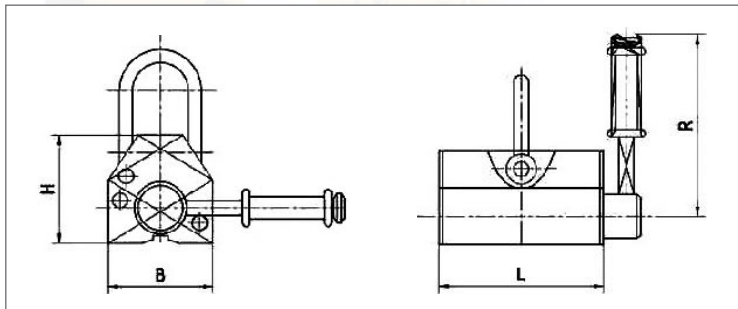

RATED LIFTING STRENGTH (kgf)	CODE	VERTICAL / CYLINDRICAL LIFTING STRENGTH (Kgf)	MAX. PULL-OFF STRENGTH (kgf)	DIMENSIONS (mm)				OPERATION TEMPERATURE (°C)	NET WEIGHT (kg)
				L	B	H	R		
100	144101	30	300	92	64	70	142	<80°C	3
300	144103	100	900	165	88	96	176	<80°C	10
600	144106	200	1800	216	118	120	219	<80°C	20
1000	144110	300	3000	264	148	140	266	<80°C	37
1500	144115	500	4500	308	172	168	285	<80°C	50
2000	144200	600	6000	397	172	168	380	<80°C	70
3000	144300	-	9000	443	226	217	512	<80°C	100
5000	144500	-	15000	582	290	265	627	<80°C	299
6000	144600	-	18000	713	290	265	707	<80°C	320

Wire Rope Winch /creeper

Austlift wire rope hoist are used for lifting and hauling loads in general hoisting operation such as mining, construction, industrial lifting and domestic applications. Wire rope hoist are also ideally used for 4WD off road recovery.

 Refer to Page 70 for Wire Rope Winch spare parts.

- Compact lightweight and robust in construction.
- Recommended for portable applications.
- Able to be operated at any angle for ease of handling.
- Hoists come with wire rope, longer lengths available.
- Hoists are individually proof tested and serial numbered.
- All hoists have spare shear pins in handle.
- All components are in box.

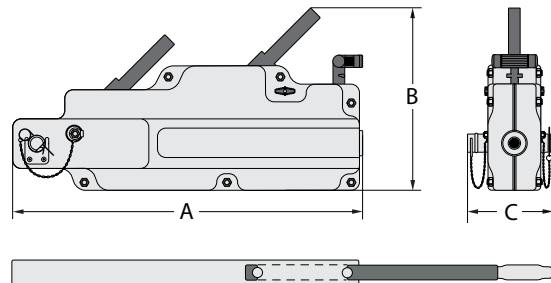

WLL (kg)	PRODUCT		NT. (kg)		DIMENSIONS (mm)			PULLING CAPACITY (kg)	PULLING EFFORT (N)	WIRE ROPE (mm)	WIRE ROPE	ADVANCE / PULL (mm)	HANDLE FORCE (N)
	CASE	CODE	WINCH ONLY	WIRE ROPE	A	B	C						
800	Aluminium	135008	7.5	8	426	236	64	1250	341	8.3	6x19S+IWRC	52	343
	Steel	135108	9	8	440	265	63						
1,600	Aluminium	135016	14.5	12	545	280	97	2500	438	11	6x25Fi+IWRC	55	438
	Steel	135116	16.5	12	550	300	77						
3,200	Aluminium	135032	23.5	24	660	325	116	5000	438	16	6x25Fi+IWRC	28	438
	Steel	135132	31	24	690	350	91						

Wire Rope Winch instructions

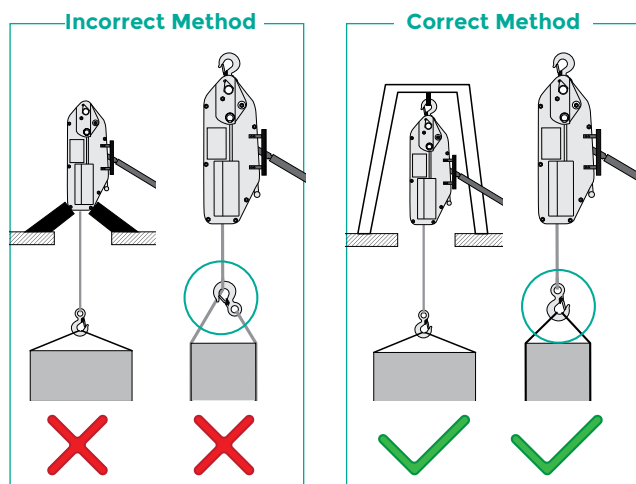

Increase the Capacity of Winches

By using multiple sheave blocks, the lifting and pulling capacity can be greatly increased. Please check the capacity of the block, the fittings & anchor points for suitability of the load.

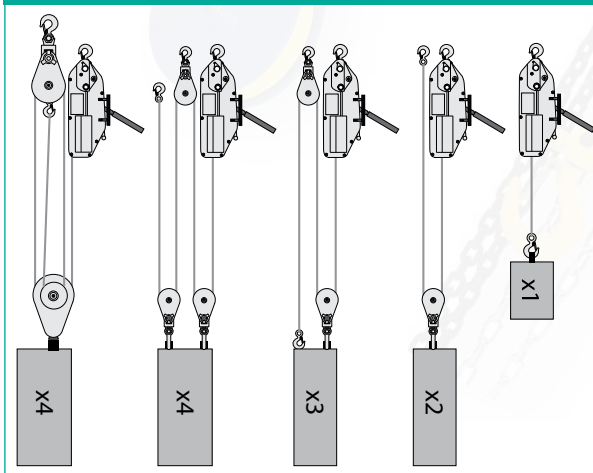

Edge Grip Drum Lifter

Austlift drum lifters are specially designed to lift 210 litre (44 gallon) drums vertically with or without lids. Easy to use for fast lifting and repositioning of drums.



CODE	OPENING (mm)	WLL (T)	Wt. (kg)	DIMENSIONS (mm)				
				H	h	M	S	W
144000	0-30	0.6	6.5	350	420	570	105	260
144001*	0-30	0.6	7.8	350	420	570	105	260

* Assembled with G80 10mm Master Link and 8mm Chain Connector for forklift.



Vertical Drum Lifter

Austlift vertical drum lifters are specially designed For lifting 210 litre (44 gallon) drums with closed head drums or drums with lids, which are in the vertical position. Conforms to AS/NZS 4991.

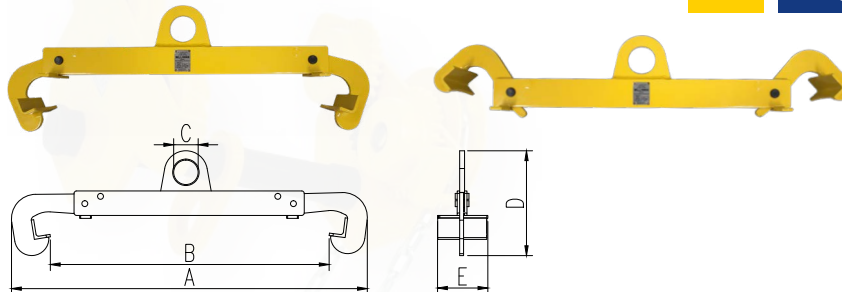

CODE	WLL (T)	Wt. (kg)	JAW OPENING (mm)	DIMENSIONS (mm)				
				A	B	C	D	E
144002	0.5	4.55	540-600	725	570	50	200	100



Web Sling Drum Lifter

Austlift sling type drum lifters are made by 100% polyester webbing and specially designed to lift 210 litre (44 gallon) drums vertically. Easy to use for fast lifting and repositioning of drums.



CODE	Drum Size	WLL (T)	Wt. (kg)	Fitting
144003	Up to 210L	0.5	2.8	Head Ring



Girder Clamp



Austlift girder clamps are designed to lift steel girders and narrow steel plate or clamped on girder to utilize as a lifting point. Also available in black color in all sizes upon request.

- Can use on material hardness up to 37RC.
- Individually serial numbered with test certificates and user manual.
- **Can ONLY be used on vertical lift.**

AS/NZS
4991

AS/NZS
1418.2

Certified

Proof
Tested
x2_{WLL}

Instruction
Manual

WLL From
1-10t

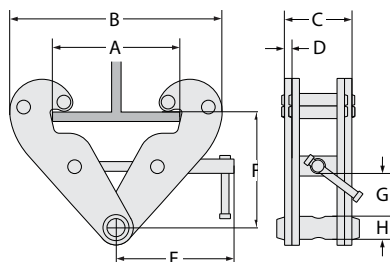

WLL (T)	CODE	BEAM SIZE (mm)	Wt. (kg)	DIMENSIONS (mm)									
				A	B		C	D	E	F		G	H
1	132005(B)	75-220	4.5	260	180	360	64	5	215	102	155	25	22
2	132010(B)	75-220	5.2	260	180	360	74	6	215	102	155	25	22
3	132013	80-320	10	354	235	490	103	8	260	140	225	45	24
5	132015	80-320	11.1	354	235	490	110	10	260	140	225	45	28
10	132020	90-320	20	365	320	505	120	12	280	170	235	50	40

Girder Trolley with Clamp

The easy installation to any beam makes it suitable for fixing to any moving hoist, pulleys and loads. It can be adjusted quickly to the beam width by turning the main spindle.

- Identification tag with serial number.

AS/NZS
4991

AS/NZS
1418.2

Certified

Proof
Tested
x2_{WLL}

Instruction
Manual

WLL From
1-10t

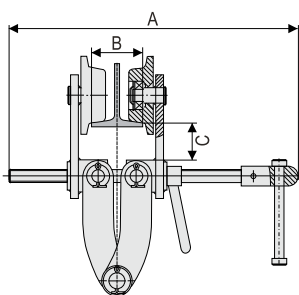
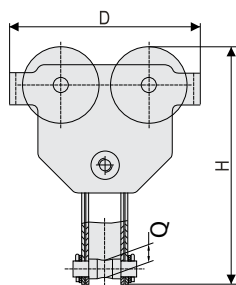

WLL (T)	CODE	BEAM SIZE (mm)	Wt. (kg)	Min. RADIUS OF CURVE (M)	DIMENSIONS (mm)					
					A	B	C	D	H	Q
1	131210	64-203	10	1.1	324	64-203	26	174	217	20
2	131215	76-203	18	1.3	340	76-203	27	280	274	20
3	131220	76-203	29	1.4	345	76-203	31	340	305	22
5	131225	100-305	49	1.5	465	100-305	50	385	399	30
10	131230	150-305	106	1.9	488	127-305	60	470	462	39

Refer to Page 76 for Geared Trolley With Clamp Spare Parts information.

Universal Plate Clamp / Vertical Plate Grab

Austlift universal plate clamps are equipped with a universal hinged lifting eye, making it possible to lift loads from any given direction.

- Can be used on material hardness up to 37RC.
- Individually serial numbered with test certificates and user manual.
- Spare parts are available.



WLL (T)	CODE	Wt. (kg)	DIMENSION (mm)				
			A	B	C	D	E
0.75	142075	2	0-15	105	218	51	ø30
1.5	142150	7.4	0-20	170	370	70	ø60
2	142200	7.8	0-25	175	375	72	ø60
3	142300	16	0-30	195	418	98	ø60
5	142500	23	0-50	230	480	110	ø80

Refer to Page 75 for Universal Plate Clamp spare parts information.



Horizontal Plate Clamp

Austlift horizontal lifting clamps are used in pairs to lift and transport steel material on a flat plane configuration.

- Can be used on material hardness up to 37RC.
- Individually serial numbered comes with test certificates and user manual.
- Spare parts are available.



WLL (T)	CODE	Wt. (kg)	DIMENSION (mm)				
			A	B	C	D	E
0.75	143075	3.5	0-25	125	175	51	ø25
1	143100	4	0-30	161	205	60	ø30
1.5	143150	4.3	0-30	161	205	60	ø30
2	143200	7.2	0-40	175	245	65	ø30
3	143300	8	0-45	180	250	65	ø30
5	143500	9	0-55	185	260	70	ø30

Refer to Page 74 for Horizontal Plate Clamp spare parts information.

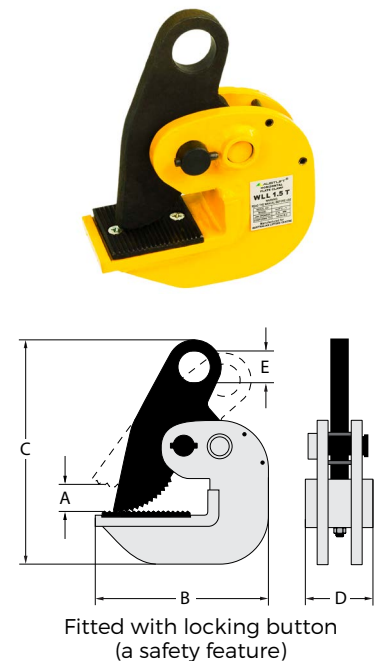

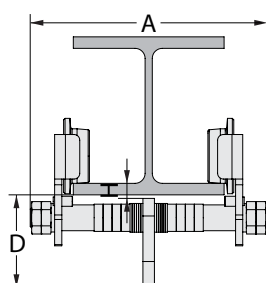
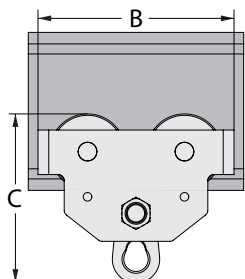

Girdler Trolley / Push Trolley

Austlift girder trolley is moved by pushing the load lifted by the trolley, running along the flange of a monorail. A main shaft with spacers you can adjust the width of UC beam. They are widely used in factories, mines, wharves, docks, warehouses and engineering workshops for installation of equipment in places where no power supply is available.

- High quality sealed ball bearings.
- Identification tag with serial number.
- Fitted with anti-drop plates for safety. Low headroom by design.
- Suitable for I beam (UC Beam), We can change wheels of trolley for H beam (UB Beam) for additional cost.

AS/NZS
1418.2

Certified

Proof
Tested
x2 WLL

Instruction
Manual

WLL From
0.5-10t

WLL (T)	CODE	BEAM SIZE (mm)	Min. RADIUS OF CURVE (M)	Wt. (kg)	DIMENSIONS (mm)				
					A	B	C	D	H
0.5	131005	64-140	0.8	5.5	228	196	192	117	25
1	131010	64-203	0.9	8.9	306	236	211	120	19
2	131015	76-210	1.0	10.7	318	273	236	130	22
3	131020	100-305	1.2	24.3	436	320	295	166	32
5	131025	100-305	1.3	36.3	454	366	333	186	38
10	131030	125-305	2.0	83.3	486	456	421	250	35

WE ARE UPDATING OUR DESIGN

Future stock are suitable for I Beam and H Beam.

Geared Trolley

The Austlift geared trolley is hand-operated by pulling the hand-chain, running on the bottom flange of monorail. With a main shaft with spacers you can adjust the width of beam. They are widely used in factories, mines, wharves, docks, warehouses and engineering workshops for installation of equipment and conveyance of goods. They are especially suitable for maintenance and repairing of equipment in places where no power supply is available.

- Standard hand chain is 3 metres however longer chain lengths are available.
- High quality sealed ball bearings.
- Identification tag with serial number.
- Fitted with anti-drop plates for safety. Low headroom by design.
- Suitable for I beam (UC Beam), We can change wheels of trolley for H beam (UB Beam) for additional cost.

AS/NZS
1418.2

Certified

Proof
Tested
x2 WLL

Instruction
Manual

WLL From
1-10t

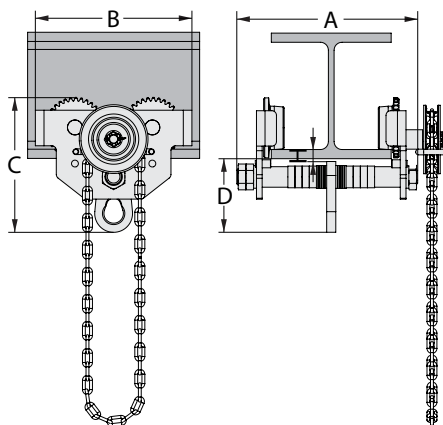

WLL (T)	CODE	BEAM SIZE (mm)	PULLING FORCE* (N)	CHAIN LENGTH (M)	Wt. (kg)	DIMENSIONS (mm)				
						A	B	C	D	H
1	131505	64-203	80	3	14	296	236	211	122	19
1.5-2	131510	76-210	140	3	16	305	273	236	130	22
3	131515	100-305	150	3	24	420	320	295	166	32
5	131520	100-305	170	3	36	441	366	333	186	38
10	131530	125-305	320	3	90	461	456	414	250	35

* Pulling force is measured when the trolley is in full load.

* NOTE: DO NOT USE CHAIN FROM CHAIN BLOCKS ON GEARED TROLLEYS.

WE ARE UPDATING OUR DESIGN

Future stock are suitable for I Beam and H Beam.

Aussie Fetch NEW

Aussie Fetch is an upgraded design of vehicle crane. Austlift uses flat web sling to replace old wire rope sling to eliminate twisting for easy to use. A new slewing stop design is for safer operating if the vehicle is parked on sloped ground. The design focus of this crane is to provide an economical, light weight lifting device to ensure safer lifting.

- Work load limit 400kg.
- Maximum arm extension: 360 degrees unlimited slewing.
- Compact design, folds away when not in use.
- It can be installed in Austlift workshop, by authorized vehicle body builder, or by owner self with competent mechanical knowledge.



CODE	SWL (kg)	NW. (kg)	MAX LIFTING HEIGHT (mm)	MAX REACH (mm)	ROTATION
145080	400	55	2000	1470	360° Manual

DIMENSIONS (mm)							
A	B	C	D	E	F	G	H
973	1223	1472	1371	1140	909	1112	928
I	J	K	L	M	N	O	P
744	2133	1729	1255	760	1162	1370	1720

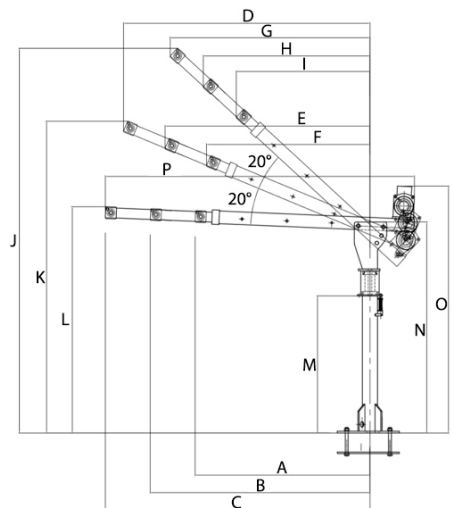

Webbing Sling



Specially designed lifting web sling. MBS: 4T.

Winch



A fully weatherproof electrical winch, 12V DC.

Lock



This lock is specially designed to keep the arm fixed at a certain angle.

Hand Control



Plug in hand controller with cord for operation at a safe distance and safe storage.

Slewing Lock



A pin lock to ensure that the crane is working at desired position and stop unwanted slewing.

Container Ramp



CODE	145000
MATERIAL	Steel
CAPACITY (kg)	6500
NW. (kg)	200

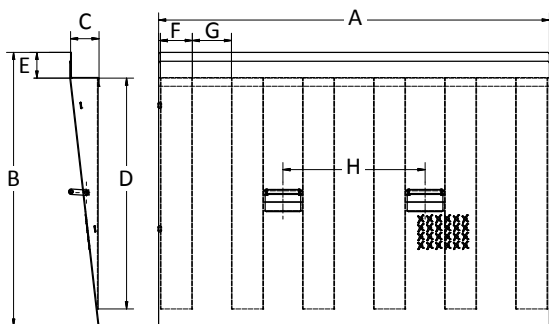

DIMENSIONS

A (mm)	2200
B (mm)	1542
C (mm)	160
D (mm)	1300
E (mm)	145
F (mm)	180
G (mm)	220
H (mm)	800

Forklift Extension



CODE	145010	145015
MATERIAL	Galvanised steel	Galvanised steel
MAX. FORK SIZE	100 x 45mm	100 x 45mm
SIZE (mm)	112 x 1800 W/L	122 x 2100 W/L
CAPACITY (kg)	3000	3000
LOAD CENTER	600mm	600mm
UNIT WEIGHT (kg)	28.5/ea	33.25/ea

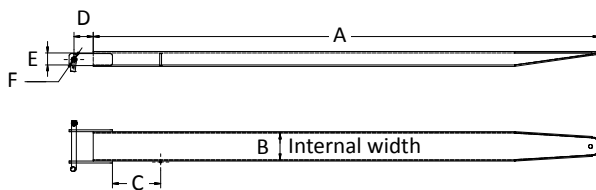

DIMENSIONS

A (mm)	1800	2100
B (mm)	110	110
C (mm)	200	200
D (mm)	80	80
E (mm)	50	50
F (mm)	22	22

Fork Lift Safe Cage



CODE	145020
MATERIAL	Steel
CAPACITY (kg)	250
NW. (kg)	115

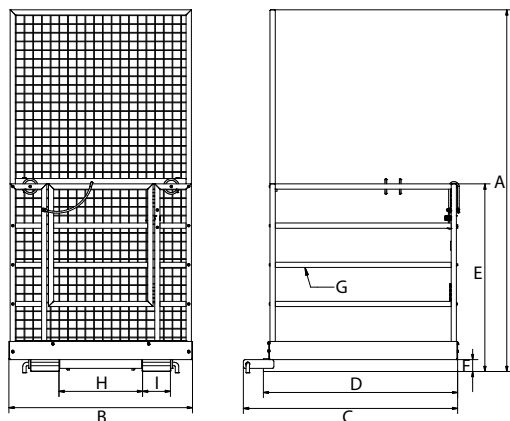
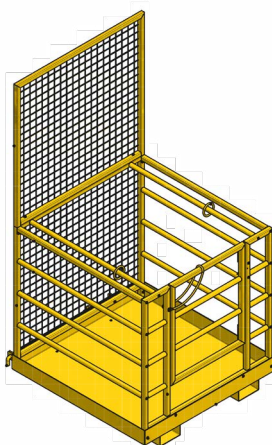

DIMENSIONS

A (mm)	2078
B (mm)	1054
C (mm)	1230
D (mm)	1115
E (mm)	1078
F (mm)	68
G (mm)	30
H (mm)	480
I (mm)	160

Foot Pad



CODE	145025
DESCRIPTION	Ultra high molecular weight polyethylene
DIMENSIONS (mm)	500 x 500 x 60
CAPACITY (t)	25
Wt. (kg)	15

Pallet Jack



CODE	145050	145060
DIMENSIONS (mm)	550 x 1150	685 x 1220
SWL (kg)	2500	2500
Wt. (kg)	75	80

Hand Trolley Flat



CODE	145090
DESCRIPTION	Flat bed type, 2 levels, 4 wheels
DIMENSIONS (mm)	900 x 600 x 980
SWL (kg)	300
Wt. (kg)	20

W4 & W5 CHAIN BLOCK SPARE PARTS

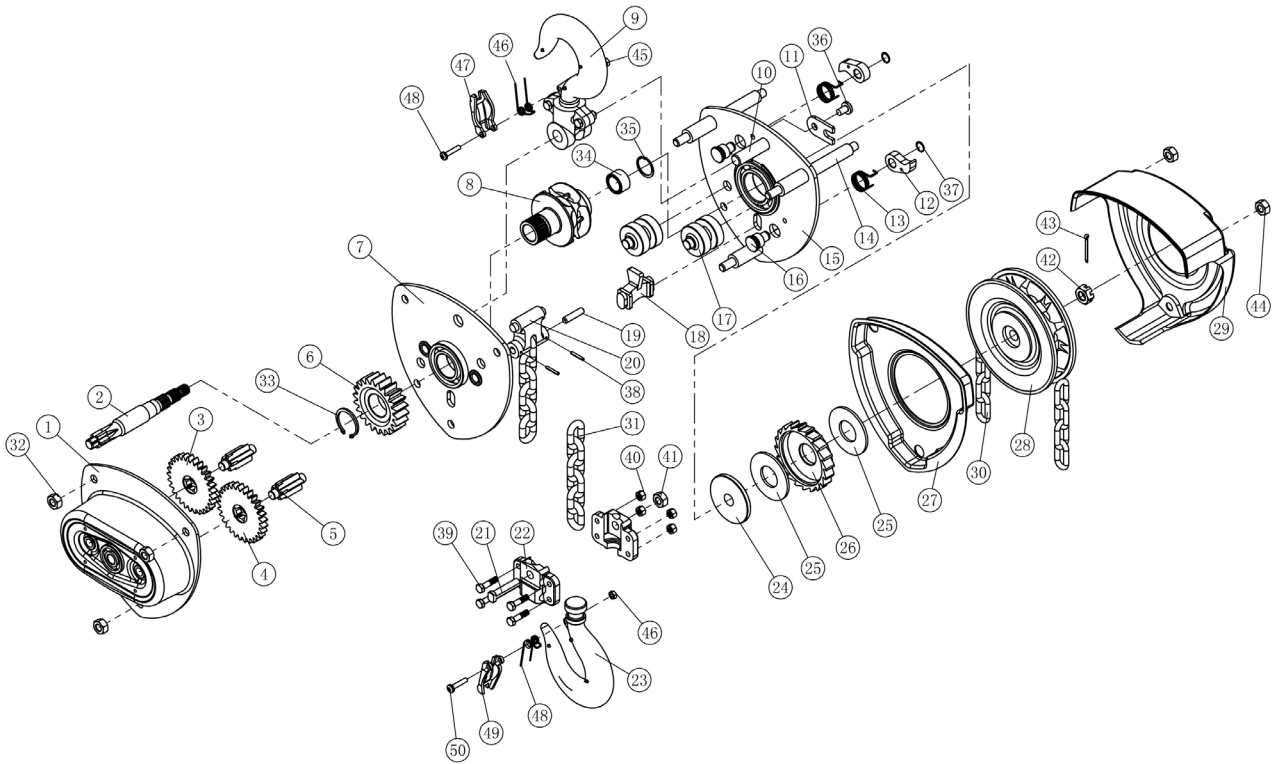

KEY	PART NAME	KEY	PART NAME	KEY	PART NAME	KEY	PART NAME
1	Gear cover	13	Pawl spring	25	Friction plate	37	Circlip for shaft
2	Long shaft gear	14	Shore	26	Ratchet wheel	38	Spring pin
3	Disk gear 1st	15	Left side plate assy	27	Ratchet wheel cover	39	Bolt
4	Disk gear 2nd	16	Pawl pin	28	Hand chain wheel	40	Nut
5	Short shaft gear	17	Guide roller	29	Hand wheel cover	41	Nut
6	Spline gear	18	Stripper	30	Hand chain	42	Slotted nut
7	Right side plate assy	19	End anchor pin	31	Load chain	43	Split pin
8	Load chain sprocket	20	End anchor	32	Nut	44	Nut
9	Top hook assy	21	Suspension load pin	33	Circlip for shaft	45	Nut
10	Hook connector	22	Bottom hook frame	34	Needle bearing	46	Double coil spring
11	Positioning plate	23	Bottom hook assy	35	Circlip for hole	47	Safety latch
12	Pawl	24	Brake seat	36	Screw	48	Pin

W4 & W5 Chain Block Spare Parts							
SUIT FOR			NO. 9	NO. 23	NO. 25	NO. 30	NO. 46+47+48
WLL	3M	6M	Top Hook	Bottom Hook	Brake Disk	Hand Chain	Safety Latch
0.5T	110005	110505	001505SP4	010305SP4	003200SP4	003002SP	003805SP4
1T	110010	110510	001510SP4	010310SP4	003200SP4	003002SP	003810SP4
1.5T	110015	110515	001515SP4	010315SP4	003315SP4	003002SP	003815SP4
2T	110020	110520	001520SP4	010320SP4	003201SP4	003002SP	003820SP4
3T	110025	110525	001530SP4	010330SP4	003200SP4	003002SP	003830SP4
5T	110030	110530	001540SP4	010350SP4	003201SP4	003002SP	003850SP4
10T	110035	110535	001545SP4	010400SP4	003201SP4	003002SP	003860SP4
15T	-	110540	001550SP4	010450SP4	003205SP4	003002SP	-

WIRE ROPE WINCH/HOIST SPARE PARTS

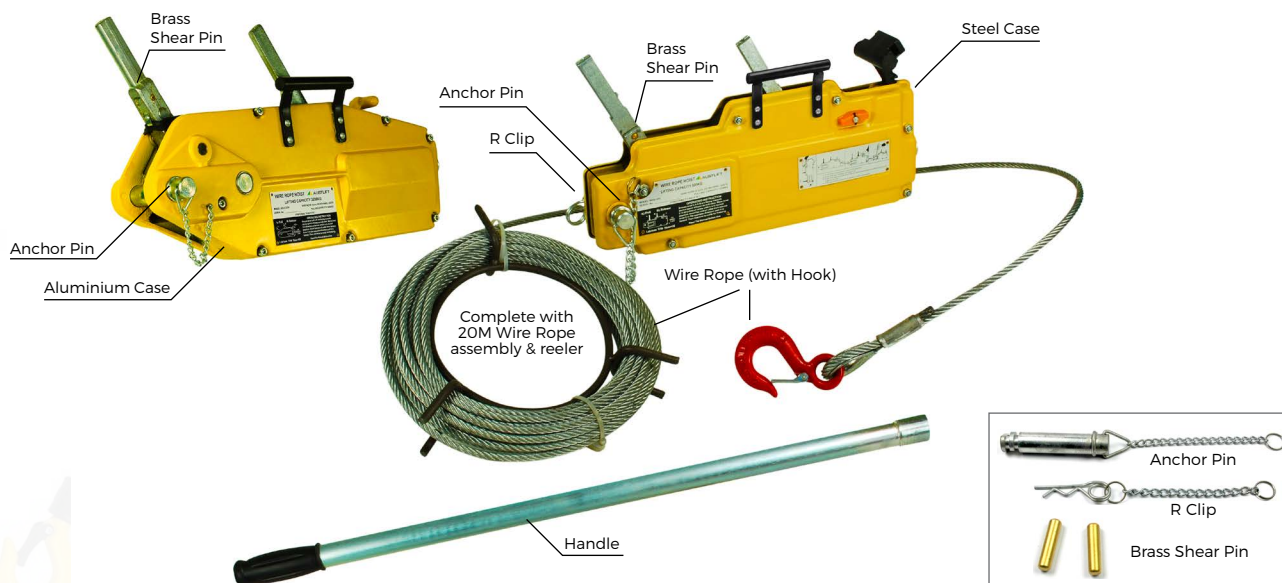

WIRE ROPE WINCH/HOIST SPARE PARTS							
WLL	Aluminium Case	Steel Case	Winch Handle	Winch Rope	Brass Shear Pin	Anchor Pin	R-Clip
800kg	135008A	135108S	135008H	135008W	003401SP (25X7mm)	003411SP	003421SP
1600kg	135016A	135116S	135016H	135016W	003402SP (29X7mm)	003412SP	003421SP
3200kg	135032A	135132S	135032H	135032W	003402SP (29X7mm)	003413SP	003421SP

MAGNETIC LIFTER SPARE PARTS

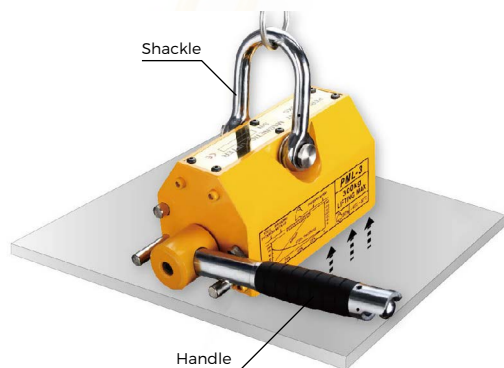

Magnetic Lifter Spare Parts (100kg - 2000kg)			
WLL	SUIT	HANDLE	SHACKLE
100	144101	033010SP	-
300	144103	033030SP	034030SP
600	144106	033060SP	-
1000	144110	033100SP	-
1500	144115	033150SP	-
2000	144200	033200SP	-

LEVER BLOCK SPARE PARTS

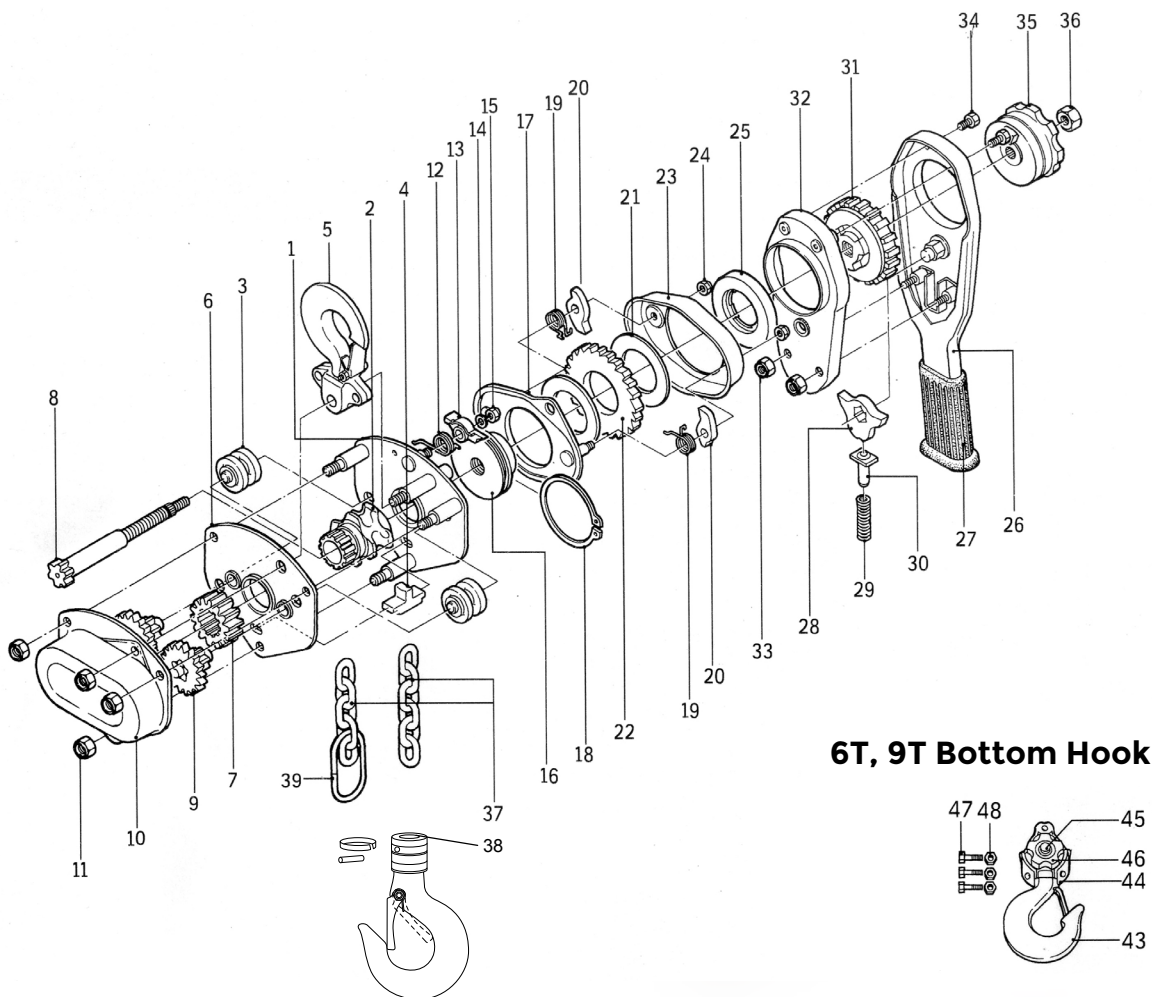

6T, 9T Bottom Hook

KEY	PART NAME	QTY.	KEY	PART NAME	QTY.	KEY	PART NAME	QTY.
1	Side Plate1	1	14	Washer for pawl	1	27	Grip	1
2	Sprocket	1	15	U-nut for pawl	1	28	Change pawl	1
3	Load chain guide	2	16	Hub	1	29	Pushing up spring	1
4	Chain stripper	1	17	Retaining plate set	1	30	Pushing up pin	1
5	Top hook set	1	18	Snap link for hub	1	31	Change gear	1
6	Side plate 2	1	19	Brake spring	2	32	Lever cover	1
7	1st gear	1	20	Brake pawl	2	33	U-nut for L.C.	2
8	Pinion shaft	1	21	Brake disc	2	34	Bolt for L.C.	2
9	2nd gear, 3rd gear	2	22	Ratchet gear	1	35	Grip ring	1
10	Gear cover set	1	23	Brake cover	1	36	Pinion nut	1
11	Nut for gear cover	4	24	U-nut for B.C.	2	37	Loading chain	1
12	Retaining spring	1	25	Brake ring	1	38	Bottom hook set	1
13	Retaining pawl	1	26	Lever body	1			
6T, 9T ON BOTTOM HOOK PARTS								
KEY	PART NAME	QTY.	KEY	PART NAME	QTY.	KEY	PART NAME	QTY.
43	Hook	1	45	Axle	1	47	Bolt	3
44	Frame	2	46	Idle sheave	1	48	Nut	3

L3 LEVER BLOCK SPARE PARTS						
WLL (T)	NO. 2 Sprocket	NO. 3 Load Chain Guide	NO. 4 Chain Striper	NO. 5 Top Hook Set	NO. 12 Retaining Spring	NO. 13 Retaining Pawl
0.25	-	-	-	-	-	-
0.5	-	-	-	-	-	-
0.8	020207SP	020307SP	020407SP	020507SP	021207SP	021307SP
1	-	-	-	020510SP	-	-
1.6	020215SP	020315SP	020415SP	020515SP	021215SP	021315SP
3.2	020230SP	020330SP	020430SP	020530SP	021230SP	021330SP
6.3	020260SP	020360SP	020460SP	020560SP	021260SP	021360SP
9	-	-	-	-	-	-
WLL (T)	NO. 19 Brake Spring	NO. 20 Brake Pawl C/W Nut & Washer	NO. 21 Brake Disc	NO. 22 Ratchet Gear	NO. 23 Brake Cove	NO. 25 Brake Ring
0.25	-	-	-	-	-	-
0.5	-	-	022105SP	-	-	-
0.8	021907SP	022007SP	022107SP	022207SP	022307SP	022507SP
1	-	-	-	-	-	-
1.6	021915SP	022015SP	022107SP	022215SP	022315SP	022515SP
3.2	021930SP	022030SP	022130SP	022230SP	022330SP	022530SP
6.3	021960SP	022060SP	022130SP	022260SP	022360SP	022560SP
9	-	-	022190SP	-	-	-
WLL (T)	NO. 26 Lever Body	NO. 27 Lever Body Grip	NO. 28 Change Pawl	NO. 29 Push Up Spring	NO. 30 Push Up Pin	NO. 32 Lever Cover
0.25	-	-	-	-	-	-
0.5	022605SP	-	-	-	-	-
0.8	022607SP	022707SP	022807SP	022907SP	023007SP	023207SP
1	-	-	-	-	-	-
1.6	022615SP	022715SP	022815SP	022915SP	023015SP	023215SP
3.2	022630SP	022730SP	022830SP	022930SP	023030SP	023230SP
6.3	-	022760SP	022860SP	022960SP	023060SP	023260SP
9	-	-	-	-	-	-
WLL (T)	NO. 35 Grip Ring	NO. 36 Pinion Nut	NO. 37 Load Chain	NO. 38 Bottom Hook Set	Pin for Load Chain	Hook safety Latch
0.5	-	-	003705SP	-	-	024105SP
0.8	023507SP	023607SP	003706SP	023807SP	024007SP	024107SP
1	-	-	003706SP	023810SP	024010SP	024110SP
1.6	023515SP	023615SP	003707SP	023815SP	024015SP	024115SP
2	-	-	-	-	-	024120SP
3.2	023530SP	023630SP	003710SP	023830SP	024030SP	024130SP
6.3	023560SP	023660SP	003710SP	023860SP	024060SP	024160SP
9	-	-	003710SP	-	-	024190SP
WLL (T)	NO. 47 + 48 Hook Bolt/nut Set		Up-Down Change Lever			
0.25	-		-			
0.5	-		-			
0.8	024707SP		024907SP			
1	024710SP		-			
1.6	024715SP		024915SP			
3.2	024730SP		024930SP			
6.3	024760SP		024960SP			
9	-		-			

SNATCH BLOCK SPARE PARTS

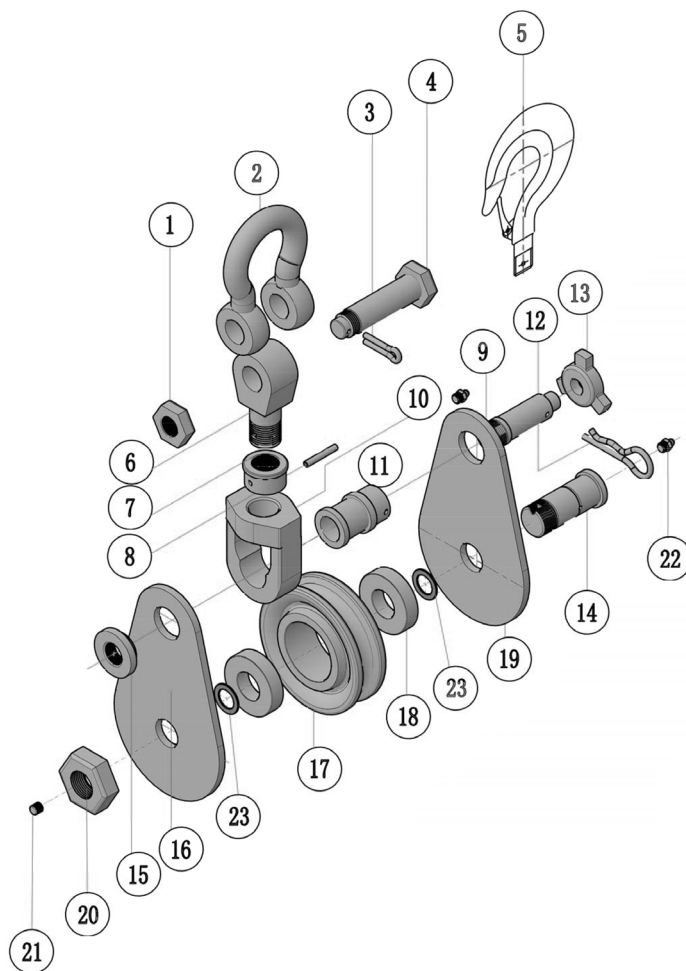





HEAVY DUTY SNATCH BLOCK SPARE PARTS

1	Nut	7	Hook Nut	13	Handle	19	Right Plate
2	Shackle	8	Spring Pin	14	Wheel Pin	20	Wheel Pin Nut
3	Hatch Pin	9	Axle	15	Plate Nut	21	Bolt
4	Shackle Pin	10	Swivel Eye	16	Left Plate	22	Grease Cup
5	Hook	11	Tub Wheel	17	Wheel	23	Washer
6	Fork Eye	12	Safety Nip	18	Bearing		

SHEAVE BLOCK SPARE PARTS

SHEAVE BLOCK SPARE PARTS

DIA. (mm)	SUIT FOR	Manila Rope Sheave Wheel	DIA. (mm)	SUIT FOR	Wire Rope Sheave Wheel
					
		Manila Rope Sheaves			Wire Rope Sheaves
75	139075F	070075M	75	139075W	070075W
100	139100F	070100M	100	139100W	070100W
125	139125F	070125M	125	139125W	070125W
150	139150F	070150M	150	139150W	070150W

HORIZONTAL PLATE CLAMP SPARE PARTS

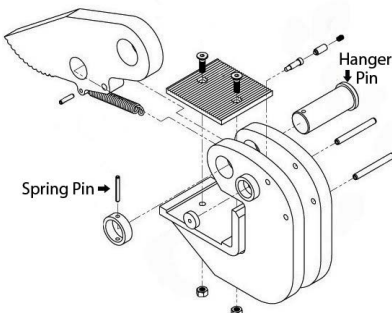
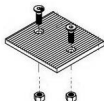
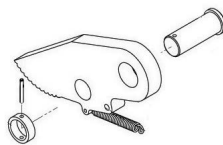
HORIZONTAL CLAMP PLATE CLAMP REPAIR KITS						
TECHNICAL DRAWING	LITTLE PAD			ACTION JACK (BRAKE ASSEMBLY)		
						
	WLL	CODE	SUIT	WLL	CODE	SUIT
	0.75T	032075SP1	143075	0.75T	032075SP2	143075
	1T	032100SP1	143100	1T	032100SP2	143100
	1.5T	032150SP1	143150	1.5T	032150SP2	143150
	2T	032200SP1	143200	2T	032200SP2	143200
	3T	032300SP1	143300	3T	032300SP2	143300
	5T	032500SP1	143500	5T	032500SP2	143500

Removal steps

- 1
- Use tools to knock the spring pin off, then pull the hanger pin out.



- 2
- Use the tool to knock the hanger pin off, then the main components are dismounted including brake assembly.



Installation steps

- 1
- Put the brake into the body of clamp and align the center of the holes of brake and the body.



- 2
- Insert the the hanger pin and remember to connect the spring pin and the rear spring pin.

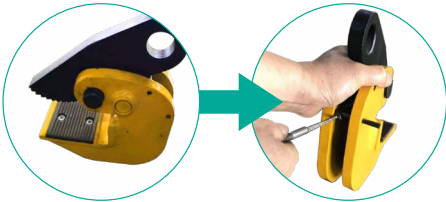



- 3
- Knock the corresponding spring pin into the body.

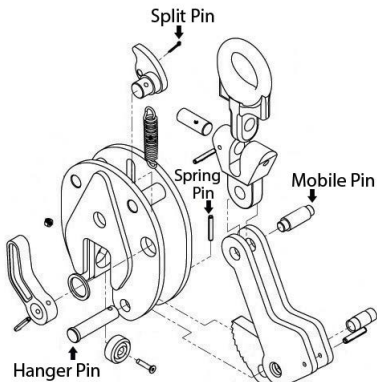

Note: All structural repair or subsequent work to load-bearing components must be carried out in accordance with AS4991.

UNIVERSAL PLATE CLAMP SPARE PARTS

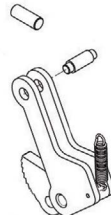
UNIVERSAL CLAMP PLATE CLAMP REPAIR KITS						
TECHNICAL DRAWING	LITTLE PAD			ACTION JACK (BRAKE ASSEMBLY)		
						
WLL	CODE	SUIT	WLL	CODE	SUIT	
0.75T	031075SP1	142075	0.75T	031075SP2	142075	
1.5T	031150SP1	142150	1.5T	031150SP2	142150	
2T	031200SP1	142200	2T	031200SP2	142200	
3T	031300SP1	142300	3T	031300SP2	142300	
5T	031500SP1	142500	5T	031500SP2	142500	

Removal steps

- 1 Use tools to knock the spring pin off, then pull the hanger pin out.



- 2 Use the tool to knock the hanger pin off, then remember to keep the hanger pin and the two shims together.



- 3 Pull out the split pin.

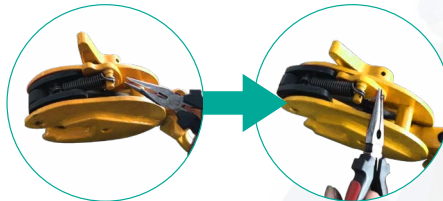

- 4 Use tools to knock the spring pin off, then pull the hanger pin out.



- 5 Push the mobile pin out with your finger.



Installation steps

- 1

Align the eyelet hole, the body hole, and the connecting rod hole so that the three holes are at the same center point
- 2

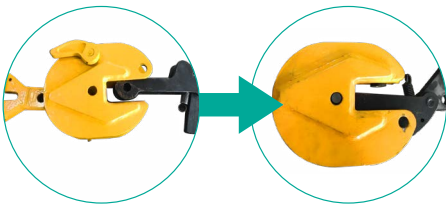

Insert the mobile pin into the hole and pull the brake to fit the groove (Figure 3)
- 3

Assemble the connector, the lower pin, the spring, etc.

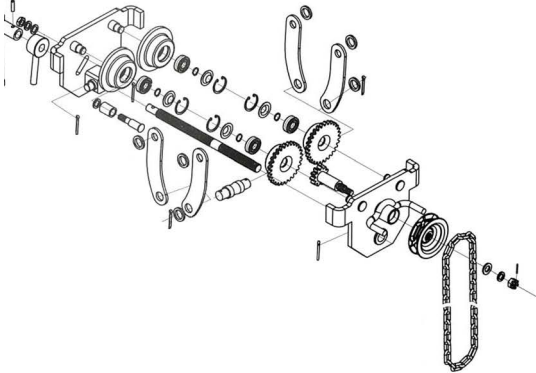

Note: All structural repair or subsequent work to load-bearing components must be carried out in accordance with AS4991.

GEARED TROLLEY WITH CLAMP SPARE PARTS

GIRDER TROLLEY WITH CLAMP SPARE PARTS			
ENGINEER DRAWIN		WHEEL	
			
		WLL	SUIT
		CODE	
		1T	060001SP
		2T	060002SP
		3T	060003SP
		5T	060005SP
		10T	060010SP